

**SURVEY & REMONUMENTATION**

MAY 31 2000

SECTION

**LAND CORNER RECORDATION CERTIFICATE**

Filing Requirement of Act 74, Mich. P.A. 1970

(Remonumentation corner under P. A. 345, Michigan P. A. of 1990)

DEED LIBER 2522 PAGE 86

GENESEE COUNTY  
PLANT MICHIGAN

REGISTERED  
JAN 6 8 42 AM '94

RECORDED

RECORDED  
MAY 31 2000

For corners in

Genesee  
(County)

Located In:

*Forest Twp*

Corner Code #

1. Public Land Survey	T	9N	R	8E	A-3
	T		R		
	T		R		
	T		R		
2. Property Controlling in Section	S	T	R		
	S	T	R		
3. Miscellaneous Property in Sec.	S	T	R		
	S	T	R		

Register of Deeds Stamp & File Number

4. Lot No. \_\_\_\_\_, Recorded Plat \_\_\_\_\_  
5. Private Claims \_\_\_\_\_

90

FILED & RECORDED

I, Jack N. Owens, Prof. Surveyor, in a field survey on October 11 19 93, do hereby certify that under requirements of P.A. 74, Michigan P.A. of 1970, the corner points mentioned in lines 1 and 2 above were in conformance with regulations and rules therefore as required in the current manual of survey instructions of the United States Department of the Interior, Bureau of Land Management or by a decree of a Court of Law and/or that the corner points mentioned in lines 3, 4 and 5 above were in conformance with the rules of the Michigan Board of Land Surveyors or by a Decree of a Court of Law, established, re-established, monumented, re-monumented, recovered, found as expressed below:

	A	B	C	D	E	F	G	H	I	J	K	L	M
1													
2	6	5	4	3	2	1							
3													
4	7	8	9	10	11	12							
5													
6	18	17	16	15	14	13							
7													
8	19	20	21	22	23	24							
9													
10	30	29	28	27	26	25							
11													
12	31	32	33	34	35	36							
13													

**NOTE:** Not more than 4 corners, all in the same town and range, may be recorded on this certificate.

**A. Description of original monument and accessories and/or subsequent restoration:**

- 1822, GLO-J. Fletcher, D.S., set post & accessory
- 1872, GCSR - S.R. Billings, C.S. stake, brick, earthware, no accessories but shows mszmts. btwn. cors.
- 1878, GCSR - S. Mathewson, C.S. stone & glass, no accessories but shows mszmts. btwn cors.
- 1935, GCRC & wit. book, fnd. stone - placed iron pin & 3 accessories
- 1976-1977 REI sur. records - K.O. Dunton, PS23503 (1976); LCRC - 11977, P825 (1977)
- fnd. 1/4" rod bent - replaced w/ 1/2" rod, & list 4 new accessories
- 1976, GCRC - not describe monumentation, lists 3 1976/77 accessories & 1 1822 accessory

**B. Description of corner evidence found and/or method applied in restoring or reestablishing corner:**

1993 Gen. Co. Remon Program changed since the GLO. I accept the 1/2" rerod as a faithful and careful perpetuation of the position of the original corner.

Recovered 1/2" rerod over 1/2" rerod @ 1.8' below grade & 3 accessoreils, (1/2" pipe to S. stdnd cor. R.R. spike p. pole to NE & Cor. fnc. post to SW from 1976/77)

Dist to B-3 = 2938.59' EDM (44.524 ch) (cf = 44.46 ch (2934;) in 1878, 44.48 ch (2926') in 1872, 44.10 ch GLO, but corrected = 44.60 ch) (2937' in 1822)

Dist. B-3 to C-3 = 2669.77' (40.451 ch) [cf = 40.95' ch (?) in 1878, 40.46 ch (2670') in 1872, 40.00 ch GLO, corrected = 40.50 ch (2673' in 1822)]

The perpetuation record since 1972 is intermittent by continuous over a long period. The distances are the same for 120 years. The Co. Sur. & GCRC records show pattern of stones replaced by new monumentation as part of each road improvement project. I conclude the corner position hasn't

Ratified by Gen. Co. Peer Group Dec 7, 1993

**C. Description of monument for corner and accessories established to perpetuate locating the position of the corner:**

- Accessories:**
- South, 127.44' fnd 1/2" pipe (NE cor. Sec. 12 T9N-R7E, Thetford) (1822)
  - N45E, 73.82' fnd R/R spike (BM) W. fc. p. pole (1976/77)
  - S45W, 62.16' fc. of cor. post of chn. lmk. fnc. (1976/77)
  - N35W, 53.45' chiseled "+" in top W. end 24" cmp MS0W, 98.96' set PK/GCRemon tag SW fc. 15" cata pa

I set the standard Bernsten monument SS-A-5-ER-30 (3 1/4" d. brass cap stamped "Genesee County Remonumentation Corner, 20709, 1933" with 30" x 2 3/8" O.D. stainless steel tuber over rod, 0.5' below grade.

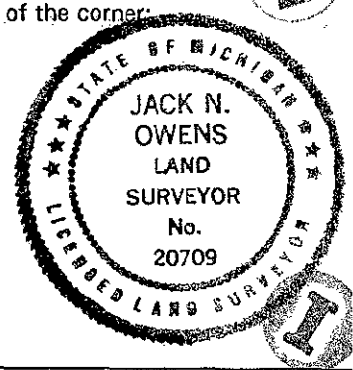

Signed by *Jack N. Owens*  
Surveyor's Michigan License No. 20709

Date Dec 29, 1993

1057

48