

LAND CORNER RECORDATION CERTIFICATE  
 Filing Requirement of Act 74, Mich. P.A. 1970

DEED LIBER 2522 PAGE 90

(Remonumentation corner under P. A. 345, Michigan P. A. of 1990)

For corners in  
Genesee  
*County*

Located in:  
Forest Twp

Corner Code #  
E-3

1. Public Land Survey	T 9N R 8E	E-3
	T _____ R _____	_____
	T _____ R _____	_____
	T _____ R _____	_____
2. Property Controlling in Section	S _____ T _____ R _____	_____
	S _____ T _____ R _____	_____
3. Miscellaneous Property in Sec.	S _____ T _____ R _____	_____
	S _____ T _____ R _____	_____

4. Lot No. \_\_\_\_\_ Recorded Plat \_\_\_\_\_ H9

5. Private Claims \_\_\_\_\_

RECORDED  
 REGISTERED  
 JAN 6 8 42 AM '94  
 GENESSEE COUNTY  
 REGISTER OF DEEDS

Register of Deeds Stamp & File Number

FILED & RECORDED

	A	B	C	D	E	F	G	H	I	J	K	L	M
1													
2	6	5	4	3	2	1							
3													
4	7	8	9	10	11	12							
5													
6	18	17	16	15	14	13							
7													
8	19	20	21	22	23	24							
9													
10	30	29	28	27	26	25							
11													
12	31	32	33	34	35	36							
13													

I, Jack N. Owens, Prof. Surv., in a field survey on Oct 11 1993, do hereby certify that under requirements of P.A. 74, Michigan P.A. of 1970, the corner points mentioned in lines 1 and 2 above were in conformance with regulations and rules therefore as required in the current manual of survey instructions of the United States Department of the Interior, Bureau of Land Management or by a decree of a Court of Law and/or that the corner points mentioned in lines 3, 4 and 5 above were in conformance with the rules of the Michigan Board of Land Surveyors or by a Decree of a Court of Law, established, re-established, monumented, re-monumented, recovered, found as expressed below.

NOTE: Not more than 4 corners, all in the same town and range, may be recorded on this certificate.

A. Description of original monument and accessories and/or subsequent restoration:  
 1822, GLO - J. Fletcher, D.S. set post, no accessories and "T" bar & 2  
 1868-1880, GCRC, H.B. Stage, Co. Sur. quartz rock dressed, 1936/38 acc. &  
 no accessories but shows marks btwn. cor's to W. 1 1972 acc.  
 1936-38, GCRC & wit. book, fnd stone ("doubtful") and  
 lists 2 accessories. 1972, RCOdeeds & REI sur. records,  
 L1819, P133; DTRows PS 11192,  
 fnd remains of 1" x 2" oak hub, set "T" iron &  
 2 1936-38 acc. & 2 new ones.  
 1974, RCOdeeds, LCRC L 1893, P 957 R.L. Mitchell PS 56936,  
 fnd. "T" bar & 1 1936-38 acc., 1972 acc. & 1 new one  
 1976, Flint Sur. & Eng. - unrecorded Cert. Sur.,  
 C.H. Carlson PS 9189

B. Description of corner evidence found and/or method applied in restoring or reestablishing corner:  
 1993 Gen. Co. Remon Program.  
 Recovered "T" iron & 5 accessories  
 on E. edge old road bed  
 (rd. sign post to the NW from 1936/38;  
 pine stump root to E.; 6" maple stump to NW;  
 W. end lake Rd. to E.; 1/2" rerod to E.  
 used for wit. cor.)  
 Dist to D-3 = 2635.66' [39.934 chs] EDM  
 of = 2639.25' [39.989 chs] in 1936/38;  
 2640.0' [40.00 ch] in 1868/80  
 2643.6' [40.055 chs] in 1822, GLO

The distances are nearly the same from 1868 to 1993 allowing for terrain and change in procedures & technology. I conclude the GCRC didn't have Co. Sur. Recs. in 1930's as did in 1920's & "Teens". There is no reason for a road bed unless they had corners Both D-3 & E-3 were stones & date back over 120 years. This corner, as others, shows pattern of recovery & perpetuation by new monumentation by Co. Sur. & GCRC. The corner hasn't changed and I accept the 1972 recovered T-iron as a faithful and careful perpetuation of the position of the original corner. Also, I note a fnd. 1/2" rebar 285.60' to the east and used as a witness corner.

Wits. for Witness Cor:  
 N40W, 72.45' set pk/GCRamon tag SW fc 15" tree  
 North, 33.29' fnd rod/cap #21585  
 N40E, 39.37' fnd nail/GE tag SW fc. 20" oak  
 N55E, 59.84' fnd DO in p.pole  
 West, 285.60' cor. to Secs. 4, 5, 8 & 9  
 N89 deg 56' 31" E, 2382.55', 1/4 cor to Secs  
 4 & 9

Ratified by Gen. Co. Pear Group Dec 14, 1993

C. Description of monument for corner and accessories established to perpetuate locating the position of the corner:  
 Accessories: For E-3  
 N50W, 35.05' fnd 4" dia metal post 4' tall,  
 to SE fc. (1936/38 acc.)  
 South, 4.79' fnd Gould nail/tag #9431 in top  
 8" pine root of fallen over stump  
 N45W, 33.69' fnd Cornerstone nail/tag #21585  
 E. fc. 4" Maple Stump  
 East, 250' W. end of Lake Rd.  
 West, 0.6' set Carsonite fiberglass post, "Survey  
 Marker, REI" projecting 3.5' above grade  
 East, 285.60' fnd 1/2" rerod in gravel 0.55' S.  
 of sec. line btwn sec. 4 & 9, used for wits. cor.

I set the standard Bernsten *Beratsen*  
 monument SS-A-5-BR-30 (3 1/4"  
 d. brass cap stamped "Genesee  
 County Remonumentation Corner,  
 20709, 1993, with 30" x 2 3/8"  
 O.D. stainless steel tube over  
 "T" iron in swamp.

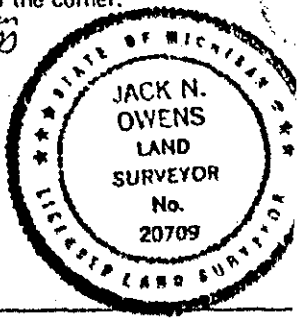

Signed by Jack N. Owens Date 12-29-93  
 Surveyor's Michigan License No. 20709