

SURVEY & REMONUMENTATION

MAY 31 2000

LAND CORNER RECORDATION CERTIFICATE

DEED LIBER 2522 PAGE 97

Filing Requirement of Act 74, Mich. P.A. 1970

SECTION

(Remonumentation corner under P. A. 345, Michigan P. A. of 1990)

For corners in

Genesee
(County)

Located In:

Forest Twp

Corner Code #

- | | | |
|---------------------------------------|-----------|-----|
| 1. Public Land Survey | T 9N R 8E | L-3 |
| | T R | |
| | T R | |
| | T R | |
| 2. Property Controlling in Section | S T R | |
| | S T R | |
| 3. Miscellaneous Property in Sec. | S T R | |
| | S T R | |
| 4. Lot No. _____, Recorded Plat _____ | | |
| 5. Private Claims _____ | | |

RECORDED
REGISTERED
Jan 6 8 43 AM '94
GENESEE COUNTY
FLINT MICHIGAN
Register of Deeds Stamp & File Number

FILED & RECORDED

	A	B	C	D	E	F	G	H	I	J	K	L	M
1													
2	6	5	4	3	2	1							
3													
4	7	8	9	10	11	12							
5													
6	18	17	16	15	14	13							
7													
8	19	20	21	22	23	24							
9													
10	30	29	28	27	26	25							
11													
12	31	32	33	34	35	36							
13													

I, Jack N. Owens, Prof. Surveyor, in a field survey on October 12 19 93z, do hereby certify that under requirements of P.A. 74, Michigan P.A. of 1970, the corner points mentioned in lines 1 and 2 above were in conformance with regulations and rules therefore as required in the current manual of survey instructions of the United States Department of the Interior, Bureau of Land Management or by a decree of a Court of Law and/or that the corner points mentioned in lines 3, 4 and 5 above were in conformance with the rules of the Michigan Board of Land Surveyors or by a Decree of a Court of Law; established, re-established, monumented, re-monumented, recovered, found as expressed below:

NOTE: Not more than 4 corners, all in the same town and range, may be recorded on this certificate.

A. Description of original monument and accessories and/or subsequent restoration:

- 1822, GLO - J. Fletcher, D.S., set post, no accessories
- 1883, GCSR - SNBedew, C.S. not describe monumentation, no accessories, but shows msrmts btwn cors.
- 1921, 1929, & 1930, GCRC & wit book, iron bolt & 3 accessories
- 1938, GCRC & wit book, fnd iron pin, & 1 1921 accessory & 3 new ones
- 1976, Cert. Sur. L1971, P750, BHenderson, PS 16043, not describe monumentation & 1 1930 accessory & 2 new ones
- 1979, LCRC, L2073, P476, BHenderson, PS16043, fnd pin in mon. box, & 1 1930 accessory, 1 1938 accessory & 2 accessories.

B. Description of corner evidence found and/or method applied in restoring or reestablishing corner:

- 1993 Gen. Co. Remon. Program
- Recovered broken 1/2" rod in mon box & 3 accessories (18" Hickory to SW from 1921; 10" Ash to NW from 1976; p. pole to NE)
- Dist to K-3 = 2680.00' [40.606 chs] EDM (cf = 2681.15' [40.623 chs] in 1921; 2677.6' [40.57 chs] in 1883; 2656.5 [40.25 chs] in 1822 GLO).
- Dist to M-3 = 2701.43' [40.931 chs] EDM (cf = 2699.4' [40.90 chs] in 1883; 2656.5' [40.25 chs] in 1822 GLO)
- Total mile consistent = 5381.43' [81.537 chs] EDM (cf = 5377.0' [81.47 chs] in 1883; 5313.0' [80.50 chs] in 1822 GLO)

The perpetuation in 1883 and the iron pin or bolt set in 1921 or 1930 and recovered in 1938 indicates a long history of perpetuation. The Co. Sur. & GCRC records show a pattern of perpetuation. I conclude the position hasn't changed since 1883 & the distances are the same. I interpret that the GLO Dep. Sur. may have only measured 1/2 mile E. (40.00 ch.) from cor. K-3 and mis measured since the distance is an even number of half-chains, the original GLO unit of measure. Also there is a large 3 deg deflection at the cor. The same pattern is seen in T10N-R8E, also by J. Fletcher, same D.S. I accept the 1/2" rod as a faithful and careful perpetuation of the position of the original corner.

Ratified by Gen. Co. Peer Group Dec. 21, 1993

C. Description of monument for corner and accessories established to perpetuate locating the position of the corner:

- Accessories:
- S35 W, 45.78' fnd nail/flag NW fc. 18" Hickory & 45.70' & set spike/GCRemon tag in NW fc.
- N40W, 32.23" fnd nail/flag NE fc. 10" Ash
- N10E, 26.82' fnd nail/flag W. fc. p. pole & 26.84' & set spike/GCRemon tag in W. fc.
- S25E, 84.55' set nail/GCRemon tag NE fc. 12" Elm

I set the standard Bernsten monument SS-A-5-BR-30 (3 1/4" d. brass cap stamped "Genesee County Remonumentation Corner, 20709, 1993" with 20" x 2 3/8" O.D. stainless steel tube) over broken rod.

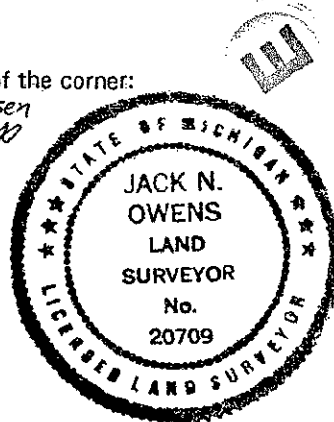

Signed by *Jack N. Owens*
Surveyor's Michigan License No. 20709

Date 12-29-93

59