

JAN 17 1996

COMMISSION

LAND CORNER RECORDATION CERTIFICATE
Filing Requirement of Act 74, Mich. P.A. 1970

For corners in

<u>GLADWIN</u> (County)	Located In:	Corner Code #
1. Public Land Survey	T18N R1W	G-13
	T___ R___	_____
	T___ R___	_____
	T___ R___	_____
2. Property Controlling in Section	S___ T___ R___	_____
	S___ T___ R___	_____
3. Miscellaneous Property in Sec.	S___ T___ R___	_____
	S___ T___ R___	_____

LIBER 001 PAGE 73

STATE OF MICHIGAN
GLADWIN COUNTY
FILED-REMONUMENTATION

26 DEC 95 10:50 A.M.

BONNIE K. HOUSE
REGISTER OF DEEDS
Register of Deeds Stamp & File Number

4. Lot No. _____, Recorded Plat _____
5. Private Claims _____

I, PAUL B. LAPHAM, in a field survey on MAY-NOVEMBER, 1995 do hereby state that under requirements of P.A. 74, Michigan P.A. of 1970, the corner points mentioned in lines 1 and 2 above were in conformance with regulations and rules therefore as required in the current manual of survey instructions of the United States Department of the Interior, Bureau of Land Management or by a decree of a Court of Law and/or that the corner points mentioned in lines 3, 4 and 5 above were in conformance with the rules of the Michigan Board of Land Surveyors or by a Decree of a Court of Law; established, re-established, monumented, recovered, found as expressed below:

NOTE: Not more than 2 corners, all in the same town and range, may be recorded on this certificate.

A	B	C	D	E	F	G	H	I	J	K	L	M
1												
2	6	5	4	3	2	1						
3												
4	7	8	9	10	11	12						
5												
6	18	17	16	15	14	13						
7												
8	19	20	21	22	23	24						
9												
10	30	29	28	27	26	25						
11												
12	31	32	33	34	35	36						
13												

- A. Description of original monument and accessories and/or subsequent restoration:
- 1877 T. GALE MERRILL SET POST
WIT.-(1)PINE 48 N85°E 30
(2)MAPLE 17 N30°W 53
 - 1971 LAPHAM WORKING DWG. & FIELD NOTES SPIKE
WIT.-WEST 28.55' COR. POST
S.E. 40.70' COR. POST
 - 1976 LAPHAM FOUND IRON
WIT.-(3)S48°W POWER POLE 41.95'
(4)N34°W S.E. CORNER HOUSE 126.68'
(5)S35°W COR. POST 41.20'
 - 1990 LAPHAM SURVEY #G-900107
WIT.-(6)N35°E 4" BIRCH 88.75"
(7)S45°E R.R. TIE POST 53.50"
(8)S75°W TOP CENTER 6" STEEL GATE POST 41.35'
- B. Description of corner evidence found and/or method applied in restoring or reestablishing corner:

FOUND 1/2" IRON 3' BELOW SURFACE OF RE-BUILT COUNTY ROAD, SET GLADWIN RE-MON FROM FOUND 1/2" IRON & WITNESSES: (4), (6), (7) & (8)

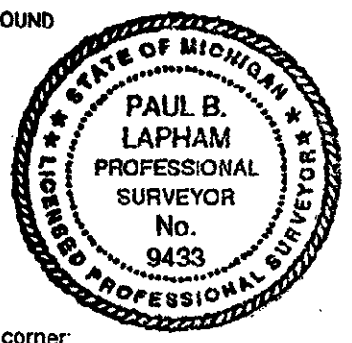

This Corner established in Gladwin County Remonumentation Program.
See dossier for detailed report.

C. Description of monument for corner and accessories established to perpetuate locating the position of the corner:

G-13: 33-34 SECTION CORNER ON TOWNSHIP LINE
SET 5/8"x36" RE-ROD WITH GLADWIN COUNTY RE-MON CAP, MARKED P.S. #9433.
S45°E 53.45' - NAIL & TAG IN R.R. TIE COR. POST
N35°E 88.65' - NAIL & TAG IN 4" BIRCH
S75°W 41.50' - TOP CENTER 6" STEEL POST
N40°W 90.15' N.E. COR. GARAGE
NORTH P.K. NAIL 2.0'
EAST P.K. NAIL 2.0'

APPROVED LAND CORNER
P.A. 345 of 1990
Gladwin County

Co. Rep. [Signature]
Date 12/14/95

Signed by [Signature]
Surveyor's Michigan License No. 9433

Date 12-22-95