

JAN 17 1996

COMMISSION

LAND CORNER RECORDATION CERTIFICATE  
Filing Requirement of Act 74, Mich. P.A. 1970

LIBER 001 PAGE 67

For corners in

GLADWIN (County)	Located In:	Corner Code #
1. Public Land Survey	T 18N R 2W	E-7
	T R	
	T R	
	T R	
2. Property Controlling in Section	S T R	
	S T R	
3. Miscellaneous Property in Sec.	S T R	
	S T R	

STATE OF MICHIGAN  
GLADWIN COUNTY  
FILED-REMONUMENTATION

26 DEC 95 10:49 A.M.

BONNIE K. HOUSE  
REGISTER OF DEEDS

Register of Deeds Stamp & File Number

4. Lot No. \_\_\_\_\_, Recorded Plat \_\_\_\_\_  
5. Private Claims \_\_\_\_\_

I, PAUL B. LAPHAM, in a field survey on MAY-NOVEMBER, 1995 do hereby state that under requirements of P.A. 74, Michigan P.A. of 1970, the corner points mentioned in lines 1 and 2 above were in conformance with regulations and rules therefore as required in the current manual of survey instructions of the United States Department of the Interior, Bureau of Land Management or by a decree of a Court of Law and /or that the corner points mentioned in lines 3, 4 and 5 above were in conformance with the rules of the Michigan Board of Land Surveyors or by a Decree of a Court of Law; established, re-established, monumented, recovered, found as expressed below:

NOTE: Not more than 2 corners, all in the same town and range, may be recorded on this certificate.

	A	B	C	D	E	F	G	H	I	J	K	L	M
1													
2	6		5		4		3		2		1		
3													
4	7		8		9		10		11		12		
5													
6	18		17		16		15		14		13		
7					●								
8	19		20		21		22		23		24		
9													
10	30		29		28		27		26		25		
11													
12	31		32		33		34		35		36		
13													

A. Description of original monument and accessories and/or subsequent restoration:

1856 GEO. CANNON  
SET POST  
WIT.-(1)HEMLOCK 20" S60°W 19  
(2)W. PINE 28" S48°E 59

1973 LAPHAM SURVEY #2401  
FOUND 3/4" BAR  
WIT.-SAME AS (3), (4) & (5)

1995 CLAYPOOL L.C.R.C. #358  
FOUND 1/2" ROD RAISED WITH  
3/4" PIPE  
WIT.-(8)S30°W 166.53' P.P.  
(9)S20°E 148.43' 5" SPRUCE  
(10)N45°E 33.57' 15" C.M.P.  
(11)N45°W 30.26' C.M.P.

1908 GLADWIN COUNTY SURVEY RECORDS  
NO WITNESSES

1991 LAPHAM UNRECORDED L.C.R.C.  
FOR COUNTY ROAD CONSTRUCTION  
FOUND 3/4" BAR  
WIT.-(6)S15°E 4" W. PINE 148.65'  
(7)S15°W T.P. 166.70'  
WEST 1/2" RE-ROD 34.40'  
N50°E 1/2" RE-ROD 40.37'

1973 SEDGMAN  
FOUND 3/4" BAR  
WIT.-(3)EAST 20.06' COR. POST  
WIT.-(4)N15°E 58.58' 6" CLUMP COTTONWOOD  
(5)S75°W 23.0' S. END 24" C.M.P.

B. Description of corner evidence found and/or method applied in restoring or reestablishing corner:

FOUND 3/4" PIPE IN CENTER LINE COUNTY ROAD FIELD LINE EAST, EXCAVATED 18" FOUND 3/4" BAR,  
SET GLADWIN MON IN PLACE OF 3/4" BAR & 3/4" PIPE FOUND CORNERS MEAS. TO WITNESSES (8) 166.35'  
MEAS TO WITNESSES (9) 148.42'

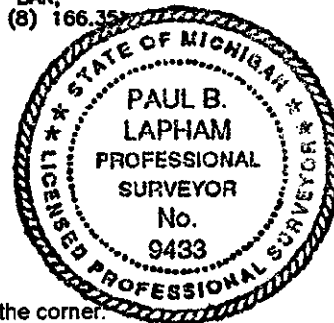

This Corner established in Gladwin County Remonumentation Program.

See dossier for detailed report.

C. Description of monument for corner and accessories established to perpetuate locating the position of the corner.

E-7: CORNER COMMON TO SECTIONS 16, 17, 20 & 21  
SET 5/8"x36" RE-ROD WITH GLADWIN COUNTY RE-MON CAP, MARKED P.S. #9433.

APPROVED LAND CORNER  
P.A. 345 of 1990  
Gladwin County

WITNESSES:  
S15°E 148.42' - NAIL & TAG IN 4" WHITE PINE  
S15°W 166.35' - NAIL & TAG IN TELE. POLE  
S85°E 39.13' - 5/8"x36" RE-ROD (0.3' BELOW SURFACE)  
N75°W 40.43' - 5/8"x36" RE-ROD (0.3' BELOW SURFACE)

Co. Rep. [Signature]  
Date 12/14/95

Signed by Paul B. Lapham  
Surveyor's Michigan License No. 9433

Date 12-22-95