

SURVEY &
REMONUMENTATION

JAN 17 1996

COMMISSION

LAND CORNER RECORDATION CERTIFICATE
Filing Requirement of Act 74, Mich. P.A. 1970

For corners in

<u>GLADWIN</u> (County)	Located In:	Corner Code #
1. Public Land Survey	T18N R 2W	1-8
	T R	
	T R	
	T R	
2. Property Controlling in Section	S T R	
	S T R	
3. Miscellaneous Property in Sec.	S T R	
	S T R	

LIBER 001 PAGE 65

STATE OF MICHIGAN
GLADWIN COUNTY
FILED-REMONUMENTATION

26 DEC 95 10:49 A.M.

BONNIE K. HOUSE
REGISTER OF DEEDS

Register of Deeds Stamp & File Number

4. Lot No. _____, Recorded Plat _____
5. Private Claims _____

I, PAUL B. LAPHAM, in a field survey on MAY-NOVEMBER, 1995 do hereby state that under requirements of P.A. 74, Michigan P.A. of 1970, the corner points mentioned in lines 1 and 2 above were in conformance with regulations and rules therefore as required in the current manual of survey instructions of the United States Department of the Interior, Bureau of Land Management or by a decree of a Court of Law and/or that the corner points mentioned in lines 3, 4 and 5 above were in conformance with the rules of the Michigan Board of Land Surveyors or by a Decree of a Court of Law, established, re-established, monumented, recovered, found as expressed below:

NOTE: Not more than 2 corners, all in the same town and range, may be recorded on this certificate.

A	B	C	D	E	F	G	H	I	J	K	L	M
1												
2	6	5	4	3	2	1						
3												
4	7	8	9	10	11	12						
5												
6	10	17	16	15	14	13						
7												
8	19	20	21	22	23	24						
9												
10	30	29	28	27	26	25						
11												
12	31	32	33	34	35	36						
13												

A. Description of original monument and accessories and/or subsequent restoration:

1856 GEO H. CANNON
SET POST
WIT.-(1)BEECH 16" S42E 24 1/2
(2)HEMLOCK N89W 32

1975 LAPHAM L.C.R.C. #117
FOUND 1/2"x3" IRON
WIT.-(3)WEST 33.5' CORNER POST
(4)S30W 76.0' 8" MAPLE
(5)S30E 94.0' 24" POPLAR

1985 LAPHAM SURVEY #G-855998
WORKING DWG. & NOTES
WITNESSES SAME AS (3), (4) & (5)

1987 LAPHAM SURVEY #G-877787
WITNESSES SAME AS (3), (4) & (5)

1989 LAPHAM SURVEY #G-899031
WITNESSES SAME AS (3), (4) & (5)

1993 LAPHAM SURVEY #G-933886
WITNESSES SAME AS (3), (4) & (5)

1992 LAPHAM UNRECORDED L.C.R.C. FOR
COUNTY ROAD CONSTRUCTION
FOUND 1/2" IRON
WIT.-(6)S45W N&T 4" BIRCH 63.65'
(7)S85W N&T 4" W. PINE 50.45'
(8)S85E N&T COR. POST 31.15'
(9)S45E N&T 12" POPLAR 72.60'

B. Description of corner evidence found and/or method applied in restoring or reestablishing corner:

FOUND 1/2" IRON IN CENTER-LINE OF ROAD OPPOSITE FENCE WEST, EXCAVATED FOUND NO OTHER CORNERS,
SET GLADWIN RE-MON FROM EXISTING FOUND CORNER AND WITNESSES (3), (6), (7), (8) & (9)

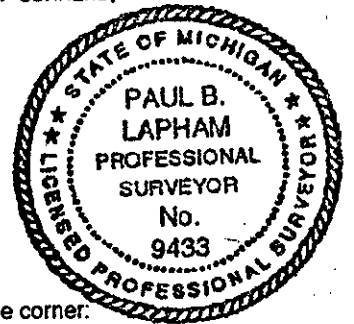

This Corner established in Gladwin County Remonumentation Program.

See dossier for detailed report.

C. Description of monument for corner and accessories established to perpetuate locating the position of the corner:

1-8: CORNER COMMON TO SECTIONS 22 & 23
SET 5/8"x36" RE-ROD WITH GLADWIN COUNTY RE-MON CAP, MARKED P.S. #9433.

WITNESSES:
S45W 63.65' - NAIL & TAG IN 4" BIRCH
S85W 50.45' - NAIL & TAG IN 4" RED PINE
S85E 31.05' - NAIL & TAG IN COR. POST
S45E 72.60' - NAIL & TAG IN 12" POPLAR

APPROVED LAND CORNER
P.A. 345 of 1990
Gladwin County

Co. Rep. [Signature]
Date 12/14/95

Signed by Paul B. Lapham
Surveyor's Michigan License No. 9433

Date 12-22-95