

MICHIGAN
DEPARTMENT OF CONSERVATION
FORESTRY DIVISION

LAND CORNER RECORD

T. 20 N.R. 2 W

Gladwin COUNTY

DESCRIPTION OF CORNER Section corner common to Sections 15 - 16 - 21 - 22

CORNER MONUMENT 1" pipe with 4" aluminum cap.

DATE MONUMENT PLACED AND WITNESSED 12-19-61

WITNESSES TO CORNER.....

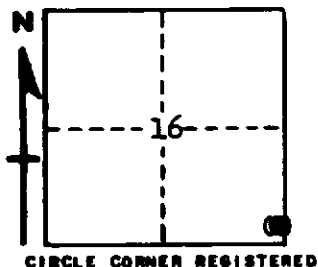

6" Maple - S 51 E - 13.0 feet

7" B. Oak - S 16 W - 57.4 feet

AND 8" R. Oak - N 45 W - 73.5 feet

CIRCLE CORNER REGISTERED

DESCRIPTION IN DETAIL AS TO HOW CORNER WAS LOCATED AND IDENTIFIED OR RESTORED.

This corner was established while making a survey of Section 16. Set corner by double proportionate measurement between corners 1 mile north, south, east and west. Unable to locate anything for a previous corner and U.S.BT's are unidentifiable.

SURVEYOR'S SEAL

SIGNED Kenneth J. Ostling DATE 12/22/61
REGISTERED LAND SURVEYOR