

SURVEY &  
REMONUMENTATION

SEP 08 1998

LAND CORNER RECORDATION CERTIFICATE  
Filing Requirement of Act 74, Mich. P.A. 1970

Register's Office }  
Gogebic County } ss.

SECTION

For corners in

<u>Gogebic</u> (County)	Located In:	Corner Code #
1. Public Land Survey	T46NR R43W	E-5
	T___R___	_____
	T___R___	_____
	T___R___	_____
2. Property Controlling in Section	S___T___R___	_____
	S___T___R___	_____
3. Miscellaneous Property in Sec.	S___T___R___	_____
	S___T___R___	_____

Received for record the  
14<sup>th</sup> day of MAY  
A. D. 1998 at 3:00 o'clock  
P m., and recorded in  
Liber 6 of CORNERS  
on page 342  
Ramona Collins Deputy  
Register of Deeds

Register of Deeds Stamp & File Number

4. Lot No. \_\_\_\_\_, Recorded Plat \_\_\_\_\_  
5. Private Claims \_\_\_\_\_

Section Corner 8, 9, 16 & 17, T46N, R43W

I, John P. Goss, in a field survey on May 7, 1998 do hereby state that under requirements of P.A. 74, Michigan P.A. of 1970, the corner points mentioned in lines 1 and 2 above were in conformance with regulations and rules therefore as required in the current manual of survey instructions of the United States Department of the Interior, Bureau of Land Management or by a decree of a Court of Law and /or that the corner points mentioned in lines 3, 4 and 5 above were in conformance with the rules of the Michigan Board of Land Surveyors or by a Decree of a Court of Law; established, re-established, monumented, recovered, found as expressed below:

1	A	B	C	D	E	F	G	H	I	J	K	L	M
2		6		5		4		3		2		1	
3													
4		7		8		9		10		11		12	
5					●								
6		18		17		16		15		14		13	
7													
8		19		20		21		22		23		24	
9													
10		30		29		28		27		26		25	
11													
12		31		32		33		34		35		36	
13													

NOTE: Not more than 2 corners, all in the same town and range, may be recorded on this certificate.

A. Description of original monument and accessories and/or subsequent restoration:

Corner established by Austin Burt, on August 28, 1851.

Original bearing trees: Y. Birch 20" S 73° W 10 links (6.60')  
Y. Birch 18" N 53° E 42 links (27.72')

Ewart Muller, RLS. 15408, on II-5-76 monumented this corner from ties from MDOT, U.S.F.S. & U.P. Power Co. He established a 1" I.D. iron pipe with plastic cap, stamped R.L.S. 15408. Richard L. Drahn, RLS, recovered Muller's corner, on June 20, 1984. It check with natural features. Only one of Muller's witnesses was alive 10" Cedar N 72° E 42.8'. Drahn established the following reference objects: 9" Red Maple - S 84° W - 37.74'; 7" Cedar - N 40° E - 12.96';

B. Description of corner evidence found and/or method applied in restoring or reestablishing corner:

6" Red Maple - S 08° E - 38.53'; 6' steel sign post - N 40° W - 2.4'

Richard L. Drahn recorded this corner in Liber 2, page 607 of Land Corners for Gogebic County.

Found Muller's monument and one witness and three of Drahn's witnesses.

I updated the corner monument and accessories as noted below to state and county specification.

Act 74 research on file.

FEEL GROUP APPROVED  
Richard L. Drahn 5/13/98  
COUNTY BEAVER-DRAHNE

C. Description of monument for corner and accessories established to perpetuate locating the position of the corner:

From the 1" I.D. iron pipe with plastic cap, stamped R.L.S. 15408: I established the following existing and new reference objects:

14" Cedar	N 72° E	42.80'
12" Red Maple	S 84° W	37.74'
9" Cedar	N 40° E	12.96'
10" Red Maple	S 08° E	38.53'
10" Spruce	N 05° W	28.40'
6' Steel Sign Post	N 40° W	2.4' (to face)

( All measurements to nail in side of tree )

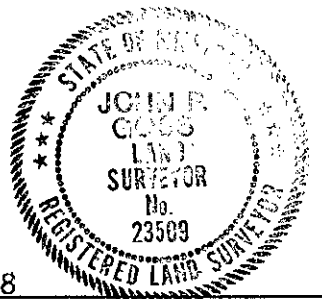

Signed by John P. Goss  
Surveyor's Michigan License No. 23509

Date May 7, 1998

Fed N. J-9