

MAR 02 2000

SECTION

LAND CORNER RECORDATION CERTIFICATE
Filing Requirement of Act 74, Mich. P.A. 1970

Register's Office }
Gogebic County } ss.

Received for record the
10TH day of JUNE
A. D. 1999 at 10:05 o'clock
A m., and recorded in
Liber 7 of CORNER

on page 157
Ramona Collins, Deputy
Register of Deeds

Register of Deeds Stamp & File Number

For corners in

<u>Gogebic</u> (County)	Located In:	Corner Code #
1. Public Land Survey	<u>T46N R43W</u>	<u>1-8</u>
	T ___ R ___	_____
	T ___ R ___	_____
	T ___ R ___	_____
2. Property Controlling in Section	S ___ T ___ R ___	_____
	S ___ T ___ R ___	_____
3. Miscellaneous Property in Sec.	S ___ T ___ R ___	_____
	S ___ T ___ R ___	_____
Quarter Corner 22 & 23; T.46 N., R.43 W.		
4. Lot No. _____, Recorded Plat _____		
5. Private Claims _____		

I, Richard L. Drahn, in a field survey on May 14, 1999 do hereby state that under requirements of P.A. 74, Michigan P.A. of 1970, the corner points mentioned in lines 1 and 2 above were in conformance with regulations and rules therefore as required in the current manual of survey instructions of the United States Department of the Interior, Bureau of Land Management or by a decree of a Court of Law and /or that the corner points mentioned in lines 3, 4 and 5 above were in conformance with the rules of the Michigan Board of Land Surveyors or by a Decree of a Court of Law; established, re-established, monumented, recovered, found as expressed below:

NOTE: Not more than 2 corners, all in the same town and range, may be recorded on this certificate.

- A. Description of original monument and accessories and/or subsequent restoration:
Original corner established by Austin Burt on 9/5/1851. Original bearing trees:
- | | | | |
|-------|-----|----------|-------------------|
| Fir | 6" | S.48° W. | 27 links (17.82') |
| Cedar | 10" | N.46° E. | 21 links (13.86') |

Corner restored by Richard L. Drahn, RLS 21564 on 10/22/84 from the remains of the original Cedar B.T. and from natural feature ties north and a line tree south. He set a 3/4" X 4" aluminum rod monument with a 3 1/4" stamped aluminum cap and the following B.T.s:

- | | | | |
|-----------------|----|----------|--------|
| Cedar | 9" | N.43° W. | 23.29' |
| Cedar | 5" | N.43° E. | 28.63' |
| Cedar | 7" | S.18° W. | 4.65' |
| Steel sign rail | 6' | N.48° W. | 2.37' |

Corner recorded in Gogebic County Liber 2, Page 649 on 12/10/84.

- B. Description of corner evidence found and/or method applied in restoring or reestablishing corner:
I recovered the monument as described and the bearing trees as follows:

- | | | | |
|-----------------|-----|----------|--------|
| Cedar | 11' | N.42° W. | 23.34' |
| Cedar | 6" | N.43° E. | 28.56' |
| Cedar | 9" | S.21° W. | 4.65' |
| Steel sign rail | 6' | N.49° W. | 2.38' |

Portions of the original Cedar stump still remain.

Corner research on file with Gogebic County records.

- C. Description of monument for corner and accessories established to perpetuate locating the position of the corner:

New bearing object referenced:

- | | | | |
|-------|----|----------|--------|
| Cedar | 5" | S.75° E. | 25.70' |
|-------|----|----------|--------|

DEED GROUP APPROVED
Richard L. Drahn 6/9/99
COUNTY REGISTER

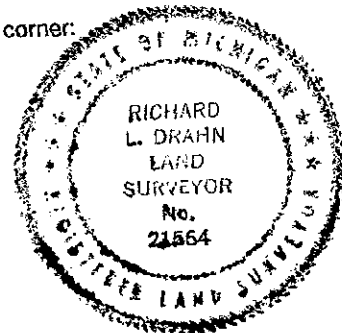

Signed by Richard L. Drahn Date May 23, 1999
Surveyor's Michigan License No. 21564
USFS P-17

FORM APPROVED BY MICHIGAN STATE BOARD OF PROFESSIONAL SURVEYORS, JAN. 28, 1971

REVISED JAN., 1983
REVISED OCT., 1995