

MAR 02 2000

SECTION

LAND CORNER RECORDATION CERTIFICATE
Filing Requirement of Act 74, Mich. P.A. 1970

Register's Office } ss.
Gogebic County }

Received for record the
10TH day of JUNE
A. D. 1999 at 10:10 o'clock
A. M., and recorded in
Liber 7 of CORNERS
on page 164
Barbara Collins Deputy
Register of Deeds

For corners in

<u>Gogebic</u> (County)	Located In:	Corner Code #
1. Public Land Survey	<u>T 46N R 43W</u>	<u>M-1</u>
	<u>T 46N R 42W</u>	<u>A-1</u>
	<u>T 47N R 43W</u>	<u>M-13</u>
	<u>T 47N R 42W</u>	<u>A-13</u>
2. Property Controlling in Section	S ___ T ___ R ___	___
	S ___ T ___ R ___	___
3. Miscellaneous Property in Sec.	S ___ T ___ R ___	___
	S ___ T ___ R ___	___

Register of Deeds Stamp & File Number

4. Lot No. _____, Recorded Plat _____
5. Private Claims _____

Section Corner 1,6,31 & 36; T.46-47 N., R.42-43 W.
I, Richard L. Drahn, in a field survey on May 13, 1999 do hereby state that under requirements of P.A. 74, Michigan P.A. of 1970, the corner points mentioned in lines 1 and 2 above were in conformance with regulations and rules therefore as required in the current manual of survey instructions of the United States Department of the Interior, Bureau of Land Management or by a decree of a Court of Law and /or that the corner points mentioned in lines 3, 4 and 5 above were in conformance with the rules of the Michigan Board of Land Surveyors or by a Decree of a Court of Law; established, re-established, monumented, recovered, found as expressed below:

A	B	C	D	E	F	G	H	I	J	K	L	M
1												
2	6	5	4	3	2	1						
3												
4	7	8	9	10	11	12						
5												
6	18	17	16	15	14	13						
7												
8	19	20	21	22	23	24						
9												
10	30	29	28	27	26	25						
11												
12	31	32	33	34	35	36						
13												

NOTE: Not more than 2 corners, all in the same town and range, may be recorded on this certificate.

A. Description of original monument and accessories and/or subsequent restoration:
Original corner established by William A. Burt on 8/6/1847. Original bearing trees:
Hemlock 5" N.65° E. 3 links (1.98')
Sugar 10" S.75° W. 16 links (10.56')
Paul R. Mack on 4/7/35 recovered the Hemlock B.T. still scribed.
Larry Lowe in 1978 recovered fragments of scribing on the badly decayed Hemlock B.T. and set a Maple picket at the corner location.

Corner restored by Richard L. Drahn, RLS 21564 on 5/3/86 from the remains of the two original B.T.s and the original post point. He set a 2" X 3' iron pipe monument with a 3" stamped brass cap and the following new B.T.s:

Hemlock	10"	N.68° W.	44.58'
Sugar Maple	10"	N.39° E.	24.91'
Sugar Maple	8"	S.14° E.	34.42'
Steel sign rail	6'	N.69° E.	2.0'

Corner recorded in Gogebic County Liber 3, Page 34 on 3/4/87.

B. Description of corner evidence found and/or method applied in restoring or reestablishing corner:

I recovered the monument as described and the bearing trees as follows:

Hemlock	11"	N.70° W.	44.57'
Sugar Maple	11'	N.37° E.	24.87' (new nail)
Sugar Maple	10"	S.14° E.	34.39'
Steel sign rail	6'	N.69° E.	1.94'

Portions of the original Hemlock B.T. are still identifiable. The original Sugar B.T. is now a stump hole.

Corner research on file with Gogebic County records.

C. Description of monument for corner and accessories established to perpetuate locating the position of the corner:

New bearing object referenced:

Sugar Maple	5"	N.12° W.	10.95'
-------------	----	----------	--------

DEED GROUP APPROVED
Richard L. Drahn 6/9/99
COUNTY GOGEBIC

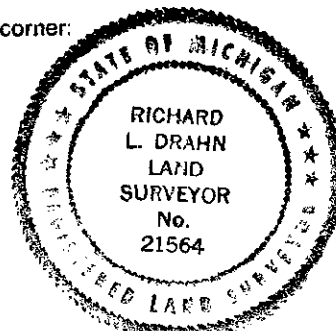

Signed by Richard L. Drahn Date May 21, 1999

Surveyor's Michigan License No. 21564