

SURVEY & REMONUMENTATION

SEP 29 1994

COMMISSION

LAND CORNER RECORDATION CERTIFICATE
Filing Requirement of Act 74, Mich. P.A. 1970

For corners in

Gogebic
(County)

Located In:

Corner Code #

- | | | |
|------------------------------------|---------------------------|------------|
| 1. Public Land Survey Sec. 9 | T <u>47N</u> R <u>46W</u> | <u>G-5</u> |
| | T _____ R _____ | _____ |
| | T _____ R _____ | _____ |
| | T _____ R _____ | _____ |
| 2. Property Controlling in Section | S _____ T _____ R _____ | _____ |
| | S _____ T _____ R _____ | _____ |
| 3. Miscellaneous Property in Sec. | S _____ T _____ R _____ | _____ |
| | S _____ T _____ R _____ | _____ |

Register's Office }
Gogebic County } ss.

Received for record the
16th day of SEPTEMBER
A. D. 1994 at 3:20 o'clock
1 m., and recorded in
Liber 5 of CORNERS
on page 98
Ramona Collins, Dep.
Register of Deeds

Register of Deeds Stamp & File Number

4. Lot No. _____, Recorded Plat _____
5. Private Claims _____

Section corner 9, 10, 15 & 16

I, John R. Garske, in a field survey on September 12, 19 94 do hereby certify that under requirements of P.A. 74, Michigan P.A. of 1970, the corner points mentioned in lines 1 and 2 above were in conformance with regulations and rules therefore as required in the current manual of survey instructions of the United States Department of the Interior, Bureau of Land Management or by a decree of a Court of Law and/or that the corner points mentioned in lines 3, 4 and 5 above were in conformance with the rules of the Michigan Board of Land Surveyors or by a Decree of a Court of Law; established, re-established, monumented, re-monumented, recovered, found as expressed below:

	A	B	C	D	E	F	G	H	I	J	K	L	M
2	6	5	4	3	2	1							
3													
4	7	8	9	10	11	12							
5													
6	18	17	16	15	14	13							
7													
8	19	20	21	22	23	24							
9													
10	30	29	28	27	26	25							
11													
12	31	32	33	34	35	36							
13													

NOTE: Not more than 4 corners, all in the same town and range, may be recorded on this certificate.

A. Description of original monument and accessories and/or subsequent restoration:

Original survey by Austin Burt, D.S., in 1851. Set wood post. Original bearing trees: Sugar 7" - S65°W, 6 links; Y. birch 10" - N32°E, 17 links.

The corner position was found by John Goss, RLS 23509 in May 1977, consisting of an iron pin in the intersection of Colby and S. Moore Streets. He set a P.K. nail at the corner position and recorded the corner in Liber 1 of land corners, P. 333. Accessories: P. pole - N30°W, 36.5'; P. pole - N60°E, 55.0'; P. pole - S88°W, 55.7'.

B. Description of corner evidence found and/or method applied in restoring or reestablishing corner:

I found a P.K. nail in the middle of the intersection at the correct corner position. I updated the corner position and accessories as noted below to bring it up to county and state specifications.

Act 74 research on file with County Register of Deeds Office.

PEER GROUP

Approved

Richard P. Drabin

9/14/94

C. Description of monument for corner and accessories established to perpetuate locating the position of the corner:

I replaced the P.K. nail with a 2 1/2" brass cap with a 1 1/2" stem set in anchoring cement 2" below the surface of the pavement and stamped: S-9, S-10, S-15, S-16, T47N, R46W, 1994, RLS 28410. I established the following bearing trees and reference objects: Reference monument consisting of a 2 1/2" x 30" aluminum pipe with a 3" aluminum cap stamped to indicate the corner position - N40°W, 44.05 feet with a steel sign post 1.53 feet away; P. pole - N45°W, 40.68 feet; P. pole - N18°E, 52.57 feet; hydrant - N51°E, 40.68 feet.

Signed by John R. Garske
Surveyor's Michigan License No. 28410

Date 9/12/94

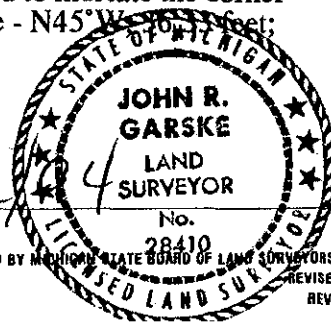

FORM APPROVED BY MICHIGAN STATE BOARD OF LAND SURVEYORS, JAN. 28, 1971
REVISED MAY 14, 1975
REVISED JAN., 1983