

1997

REGISTER

LAND CORNER RECORDATION CERTIFICATE
Filing Requirement of Act 74, Mich. P.A. 1970

For corners in Gogebic Located In: _____ Corner Code # _____
(County)

- 1. Public Land Survey Section 24 T 47N R 46W M-9
T 47N R 45W A-9
T _____ R _____
T _____ R _____
- 2. Property Controlling in Section S _____ T _____ R _____
S _____ T _____ R _____
- 3. Miscellaneous Property in Section S _____ T _____ R _____
S _____ T _____ R _____

- 4. Lot No. _____, Recorded Plat _____
- 5. Private Claims _____

Section corner to 24, 19, 25 & 30, T47N, R45-46W.

I, John R. Garske, in a field survey on October 29, 19 96, do hereby certify that under requirements of P.A. 74, Michigan P.A. of 1970, the corner points mentioned in lines 1 and 2 above were in conformance with regulations and rules therefore as required in the current manual of survey instructions of the United States Department of the Interior, Bureau of Land Management or by a decree of a Court of Law and/or that the corner points mentioned in lines 3, 4 and 5 above were in conformance with the rules of the Michigan Board of Professional Surveyors or by a Decree of a Court of Law; established, re-established, monumented, re-monumented, recovered, found as expressed below:

NOTE: Not more than 4 corners, all in the same town and range, may be recorded on this certificate.

A. Description of original monument and accessories and/or subsequent restoration:

On September 7, 1847, John Burt, U.S.D.S., set a hemlock post from which:
16" sugar - S32°E - 29 links 10" sugar - N26°W - 40 links
12" Y. birch - N15°E - 26 links 18" sugar - S30°E - 30 links

B. Description of corner evidence found and/or method applied in restoring or reestablishing corner:

At the corner position, I found an intersection of ancient fence lines. Blue lines from cruisers extend in all directions. This corner location fits very well with GLO calls to rock ledges. The corner falls on the top of a rock ledge as noted in the original notes and checks well with the ledge call 20 feet west and foot of hill 75 links west.

Record research on file.

SKETCH ON BACK

PEER GROUP APPROVED
Richard L. Deahn 11/11/96
COUNTY REPRESENTATIVE

C. Description of monument for corner and accessories established to perpetuate locating the position of the corner:

I grouted a 3 1/4" diameter stamped brass cap with a 3" stem into bedrock at the corner location from which I established the following bearing trees and/or objects:
16" sugar maple - N39°W - 20.45 feet
7" sugar maple - N60°E - 16.18 feet
8" sugar maple - S35°E - 12.30 feet
6' steel sign rail - Due South - 3.48 feet



Signed by John R. Garske
Surveyor's Michigan License No. 28410

Date _____

Register's Office }
Gogebic County } ss.

Received for record the 25th day of November

A. D. 1996 at 10:50 o'clock

A m., and recorded in

Lib. 6 of Gogebic

on page 85
Ramona Collins, Deputy
Register of Deeds

Register of Deeds Stamp & File Number

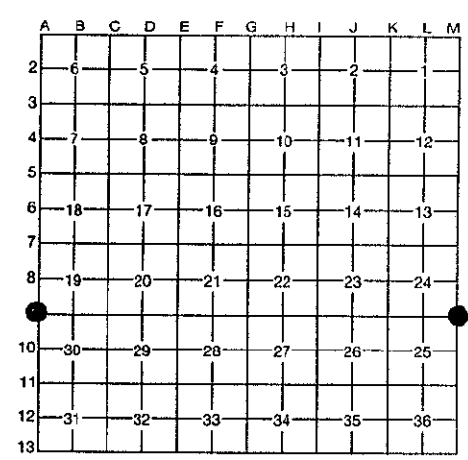

No Scale

T47N

R46W 24 | 19 R45W
25 | 30

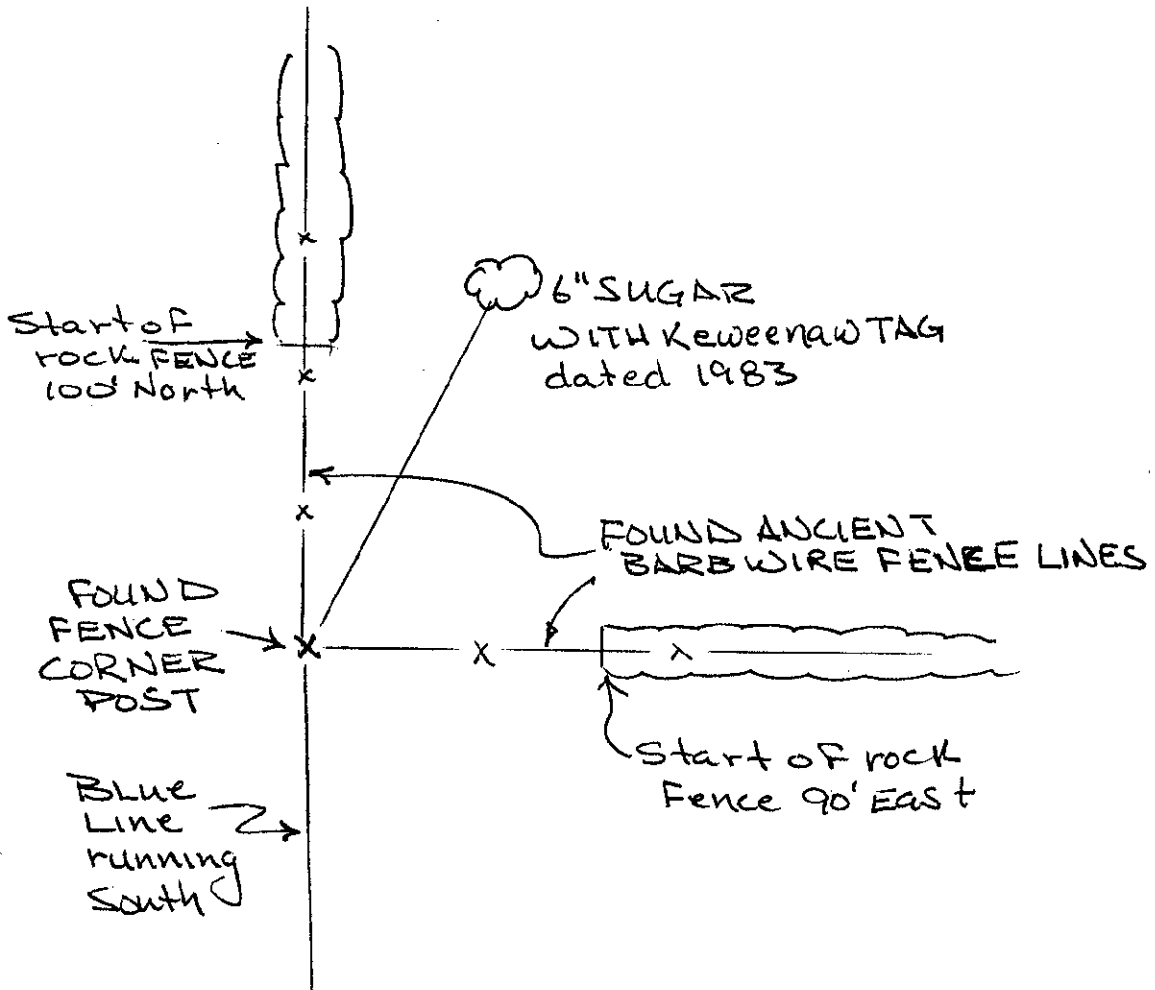

COMMISSION OF
REMONUMENTATION

MAY 16 1997

COMMISSION

M-9

A-9