

SURVEY & REMONUMENTATION

SEP 29 1994

COMMISSION

LAND CORNER RECORDATION CERTIFICATE
Filing Requirement of Act 74, Mich. P.A. 1970

For corners in

Gogebic
(County)

Located In:

Corner Code #

- | | | |
|------------------------------------|-------------------------|-------|
| 1. Public Land Survey S-2 | T 47N R 47W | I-1 |
| | T _____ R _____ | _____ |
| | T _____ R _____ | _____ |
| | T _____ R _____ | _____ |
| 2. Property Controlling in Section | S _____ T _____ R _____ | _____ |
| | S _____ T _____ R _____ | _____ |
| 3. Miscellaneous Property in Sec. | S _____ T _____ R _____ | _____ |
| | S _____ T _____ R _____ | _____ |

Register's Office } ss.
Gogebic County }

Received for record the
16TH day of SEPT
A. D. 1994 at 3:50 o'clock
P m., and recorded in
Liber 5 of CORNERS

on page 104
Ramona Collins, Deputy
Register of Deeds

Register of Deeds Stamp & File Number

4. Lot No. _____, Recorded Plat _____
5. Private Claims _____

Section corner common to Sections 2, 3, 34 and 35

I, John R. Garske, in a field survey on July, 1994, do hereby certify that under requirements of P.A. 74, Michigan P.A. of 1970, the corner points mentioned in lines 1 and 2 above were in conformance with regulations and rules therefore as required in the current manual of survey instructions of the United States Department of the Interior, Bureau of Land Management or by a decree of a Court of Law and/or that the corner points mentioned in lines 3, 4 and 5 above were in conformance with the rules of the Michigan Board of Land Surveyors or by a Decree of a Court of Law; established, re-established, monumented, re-monumented, recovered, found as expressed below:

| | | | | | | | | | | | | |
|----|----|----|----|----|----|----|---|---|---|---|---|---|
| A | B | C | D | E | F | G | H | I | J | K | L | M |
| 2 | 6 | 5 | 4 | 3 | 2 | 1 | | | | | | |
| 3 | | | | | | | | | | | | |
| 4 | 7 | 8 | 9 | 10 | 11 | 12 | | | | | | |
| 5 | | | | | | | | | | | | |
| 6 | 18 | 17 | 16 | 15 | 14 | 13 | | | | | | |
| 7 | | | | | | | | | | | | |
| 8 | 19 | 20 | 21 | 22 | 23 | 24 | | | | | | |
| 9 | | | | | | | | | | | | |
| 10 | 30 | 29 | 28 | 27 | 26 | 25 | | | | | | |
| 11 | | | | | | | | | | | | |
| 12 | 31 | 32 | 33 | 34 | 35 | 36 | | | | | | |
| 13 | | | | | | | | | | | | |

NOTE: Not more than 4 corners, all in the same town and range, may be recorded on this certificate.

A. Description of original monument and accessories and/or subsequent restoration:

Original survey by William A. Burt, D.S., in 1847. Set sugar post. Original bearing trees: Hemlock 18" - N22°E, 33 links; Sugar 8" - N50°W, 55 links.

The corner position was found by John P. Goss, RLS 23509, in April 1978 marked by a brass cap set in concrete pavement by the U.S. Department of Agriculture Farm Security Administration in 1938. He recorded the corners in liber 1 of land corners P. 377. He set a P.K. nail in a blacktop road at the corner location. Accessories: P. pole - S63°W, 48.90 feet; T. pole - N72°W, 80.39 feet; L. pole - N50°E, 51.70 feet; N. pine 12" - S44°E, 57.97 feet.

B. Description of corner evidence found and/or method applied in restoring or reestablishing corner:

I found a P.K. nail in blacktop pavement marking the corner position which checks with Goss' witnesses in his certificate. I updated the corner as noted below to bring it up to county and state specifications.

Act 74 research on file with County Register of Deeds Office.

PEER GROUP

Approved

Richard P. Drabn 9/14/94

C. Description of monument for corner and accessories established to perpetuate locating the position of the corner:

I replaced the found P.K. nail with a 2 1/2" brass cap with a 2" stem set in anchoring cement 1/2" below pavement. Cap is stamped S-34, S-35, S-2, S-3, T48N, T47N, R47N, 1994, RLS 28410. I established the following reference objects: Reference monument consisting of a 2 1/2" x 30" aluminum pipe with a 3 1/4" aluminum cap stamped to indicate the corner position as follows: R.M. - S54°W, 46.10 feet - with steel sign post 1.64 feet away; P. pole - N67°W, 83.8 feet; L. pole - S25°E, 96.15 feet; existing P. pole - N50°E, 51.70 feet.

Signed by John R. Garske
Surveyor's Michigan License No. 28410

Date 8/29/94

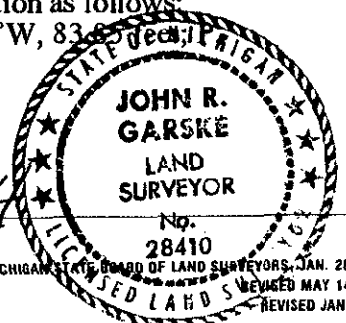

FORM APPROVED BY MICHIGAN STATE BOARD OF LAND SURVEYORS, JAN. 28, 1971
REVISED MAY 14, 1975
REVISED JAN., 1983