

LAND CORNER RECORDATION CERTIFICATE
Filing Requirement of Act 74, Mich. P.A. 1970

Register's Office }
 Gogebic County } ss.

Received for record the
19th day of August
 A. D. 1994 at 1:13 o'clock
9 m., and recorded in
 Liber 5 of CORNERS
 on page 84.
Ramona Collins, Deputy
 Register of Deeds

For corners in
Gogebic
 (County)

Located In: Corner Code -#

- | | | |
|---------------------------------------|---------------------------|------------|
| 1. Public Land Survey
<u>S-14</u> | T <u>47N</u> R <u>47W</u> | <u>K-5</u> |
| | T _____ R _____ | _____ |
| | T _____ R _____ | _____ |
| | T _____ R _____ | _____ |
| 2. Property Controlling
in Section | S _____ T _____ R _____ | _____ |
| | S _____ T _____ R _____ | _____ |
| 3. Miscellaneous
Property in Sec. | S _____ T _____ R _____ | _____ |
| | S _____ T _____ R _____ | _____ |
| 4. Lot No. _____, Recorded Plat _____ | | |
| 5. Private Claims _____ | | |

Register of Deeds Stamp & File Number

I, John R. Garske, in a field survey on May 5, 1994, do hereby certify that under requirements of P.A. 74, Michigan P.A. of 1970, the corner points mentioned in lines 1 and 2 above were in conformance with regulations and rules therefore as required in the current manual of survey instructions of the United States Department of the Interior, Bureau of Land Management or by a decree of a Court of Law and/or that the corner points mentioned in lines 3, 4 and 5 above were in conformance with the rules of the Michigan Board of Land Surveyors or by a Decree of a Court of Law; established, re-established, monumented, re-monumented, recovered, found as expressed below:

A	B	C	D	E	F	G	H	I	J	K	L	M
2	6	5	4	3	2	1						
3												
4	7	8	9	10	11	12						
5												
6	18	17	16	15	14	13						
7												
8	19	20	21	22	23	24						
9												
10	30	29	28	27	26	25						
11												
12	31	32	33	34	35	36						
13												

NOTE: Not more than 4 corners, all in the same town and range, may be recorded on this certificate.

A. Description of original monument and accessories and/or subsequent restoration:

Original survey by William Ives in 1848. Original Bearing Trees:

Sugar 12" - N56°W - 10 links; Sugar 8" - S46°E - 35 links

The corner position was found by Ewart C. Muller, RLS 15408, and John P. Goss, RLS 23509, on July 6, 1977, and recorded in Liber 2 of Land Corners, page 327.

Accessories: Chisel "+" in rock outcrop - N08°E - 23.53 feet; 6" poplar - S80°E - 47.96 feet; 6" red maple - S70°E - 45.39 feet; fence post - S43°E - 25.50 feet

B. Description of corner evidence found and/or method applied in restoring or reestablishing corner:

Found a 3/4" iron pipe marking the corner position which checks with the corner certificate by Muller. I updated corner monument and accessories as noted below to bring them up to state and county specifications.

Act 74 research on file with County Register of Deeds Office.

PEER GROUP

Approved

Richard L. Dral 8/17/94

C. Description of monument for corner and accessories established to perpetuate locating the position of the corner:

I replaced the 3/4" iron pipe with a 2 1/2" x 30" aluminum pipe with a 3 1/4" aluminum cap stamped: T47N, R47W, S-11, S-12, S-14, S-13, RLS 28410, County Monument, from which I established the following bearing trees and reference objects:

- Steel sign post - Due North - 1.16 feet
- 10" R. maple - S70°E - 45.30 feet
- 5" twin cherry - S28°W - 30.31 feet
- 5" cherry - N60°W - 25.35 feet
- Chiseled "X" in rock - N08°E - 23.53 feet

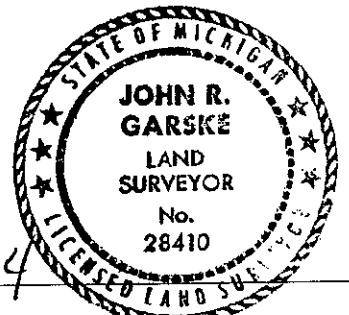

Signed by John R. Garske Date 6/10/94
 Surveyor's Michigan License No. 28410