

LAND CORNER RECORDATION CERTIFICATE
Filing Requirement of Act 74, Mich. P.A. 1970

Register's Office }
Gogebic County } ss.

For corners in

GOGEBIC
(County)

Located In:

Corner Code #

1. Public Land Survey

T 48 N R 44 W C-10

T ___ R ___
T ___ R ___ **SURVEY &**
T ___ R ___ **MONUMENTATION**

2. Property Controlling
in Section

S ___ T ___ R ___
S ___ T ___ R ___

JAN 05 2001

3. Miscellaneous
Property in Sec.

S ___ T ___ R ___
S ___ T ___ R ___

SECTION

Received for record the
26th day of MAY
A. D. 2000 at 11:10 o'clock
A m., and recorded in
Liber 7 of CORNERS
on page 335
Cheryl Ruppe
Dep. Register of Deeds

Register of Deeds Stamp & File Number

4. Lot No. _____, Recorded Plat _____

5. Private Claims _____

Quarter Corner, Sections 29 & 30, T48N, R44W

I, John P. Goss, in a field survey on April 1, 2000 do hereby state that under requirements of P.A. 74, Michigan P.A. of 1970, the corner points mentioned in lines 1 and 2 above were in conformance with regulations and rules therefore as required in the current manual of survey instructions of the United States Department of the Interior, Bureau of Land Management or by a decree of a Court of Law and /or that the corner points mentioned in lines 3, 4 and 5 above were in conformance with the rules of the Michigan Board of Land Surveyors or by a Decree of a Court of Law; established, re-established, monumented, recovered, found as expressed below:

NOTE: Not more than 2 corners, all in the same town and range, may be recorded on this certificate.

	A	B	C	D	E	F	G	H	I	J	K	L	M
1													
2	6		5		4		3		2		1		
3													
4	7		8		9		10		11		12		
5													
6	18		17		16		15		14		13		
7													
8	19		20		21		22		23		24		
9													
10	30		29		28		27		26		25		
11													
12	31		32		33		34		35		36		
13													

A. Description of original monument and accessories and/or subsequent restoration:

Corner established by Austin Burt, in 1848.

Original bearing trees: Sugar Maple 8" S 24° W 23 links (15.18 ft.)
Sugar Maple 12" N 26° E 20 links (13.20 ft.)

Donald D. Lappala, 12585, on Sept. 29, 1972, restored corner position at record bearing and distance from the stump holes of the two original bearing trees. He set a 2" I.D. iron pipe with 3" bronze tablet, stamped to indicated the corner position. He established the following reference objects: 3" S. Maple N 63° W - 25.5 ft.; 8" Y. Birch - S 67° E - 8.4 ft.; 7" S. Maple - S 30° W 27.8 ft.; a metal sign post - N 62° W - 3.4 ft.

B. Description of corner evidence found and/or method applied in restoring or reestablishing corner:

On December 9, 1974 he recorded said corner in U.S.F.S. Liber, Index No. T-5.

Found Lappala monument and accessories.

Act 74 research on file.

DEED GROUP APPROVED
Richard R. Deane 05/24/00
COUNTY CLERK

C. Description of monument for corner and accessories established to perpetuate locating the position of the corner:

From the found monument stamped to read: T.48 N., R.44 W.; 1/4; S-29, S-30; R.L.S. 12585; 1972, from which I established the following existing and new reference objects:

6" Sugar Maple	N 63° W	25.61 ft.
13" Yellow Birch	S 67° E	8.49 ft.
9" Sugar Maple	S 30° W	27.85 ft.
13" Yellow Birch	N 36° E	19.79 ft.
Metal sign post	N 62° W	3.4 ft. to face

(All measurement taken to nail in side of tree)

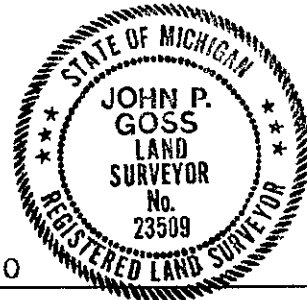

Signed by John P. Goss
Surveyor's Michigan License No. 23509

Date April 2, 2000

U.S.F.S. No. T-5