

**LAND CORNER RECORDATION CERTIFICATE**  
**Filing Requirement of Act 74, Mich. P.A. 1970**

Register's Office }  
 Gogebic County } ss.

Received for record the  
16<sup>th</sup> day of December  
 A. D. 1993 at 2:25 o'clock  
P m., and recorded in  
 Liber 4 of COGNAC  
 on page 302.  
*Betty Lavin* Deputy  
 Register of Deeds

Register of Deeds Stamp & File Number

For corners in  
Gogebic  
 (County)

Located In: Corner Code ##

1. Public Land Survey Section 5	T	<u>47N</u>	R	<u>46W</u>	<u>E-1</u>
	T		R		
	T		R		
	T	<u>48N</u>	R	<u>46W</u>	<u>E-13</u>
2. Property Controlling in Section	S		T	R	
	S		T	R	
3. Miscellaneous Property in Sec.	S		T	R	
	S		T	R	

4. Lot No. \_\_\_\_\_, Recorded Plat \_\_\_\_\_  
 5. Private Claims \_\_\_\_\_

Section corner common to S-32, 33, 4 & 5, T48N, R46W  
 and T47N, R46W

October 4 1993

I, John R. Garske, in a field survey on \_\_\_\_\_, 19\_\_\_\_\_, do hereby certify that under requirements of P.A. 74, Michigan P.A. of 1970, the corner points mentioned in lines 1 and 2 above were in conformance with regulations and rules therefore as required in the current manual of survey instructions of the United States Department of the Interior, Bureau of Land Management or by a decree of a Court of Law and/or that the corner points mentioned in lines 3, 4 and 5 above were in conformance with the rules of the Michigan Board of Land Surveyors or by a Decree of a Court of Law; established, re-established, monumented, re-monumented, recovered, found as expressed below:

A	B	C	D	E	F	G	H	I	J	K	L	M
2	6	5	4	3	2	1						
3												
4	7	8	9	10	11	12						
5												
6	18	17	16	15	14	13						
7												
8	19	20	21	22	23	24						
9												
10	30	29	28	27	26	25						
11												
12	31	32	33	34	35	36						
13												

**NOTE: Not more than 4 corners, all in the same town and range, may be recorded on this certificate.**

A. Description of original monument and accessories and/or subsequent restoration:

Survey by William A. Burt, U.S.D.S., 1847. Set hemlock post from which a 10" lynn bears N48°E, 37 links and a 10" lynn bears N49°W, 52 links. No original evidence found.

B. Description of corner evidence found and/or method applied in restoring or reestablishing corner:

I re-established the corner by using information from surveys by William Riipi, RLS, in surveying the recorded plats of Alpen Village and Creekside. Coordinate information was used by tying into the north one-quarter, center one-quarter corner and east one-quarter corner of Section 5 and then setting the northeast corner. The corner lands at the extension of a N-S fence on an E-W fence line. Remnants of a wooden hub set by Riipi in the early 70's were found at this position.

**PEER GROUP APPROVED**  
*Richard P. Deahn* 4/6/95  
 COUNTY REPRESENTATIVE

C. Description of monument for corner and accessories established to perpetuate locating the position of the corner:

Set 2 1/2" x 30" aluminum county monument with a 3 1/2" diameter aluminum cap stamped: County Remonumentation; T48N, R46W; S-32; S-33; S-5; S-4; T47N, R46W; 1993; RLS 28410. Established the following bearing trees and reference objects:

- 11" basswood - N70°E - 7.55 feet
- 11" basswood - N79°W - 32.13 feet
- 6" sugar - N12°W - 25.00 feet
- Steel sign post - S40°E - 2.30 feet
- Center line two-track trail - due south - 21.5 feet

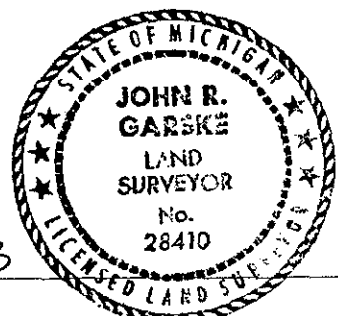

Signed by John R. Garske  
 Surveyor's Michigan License No. 28410

Date 12/9/93