

SURVEY & REMONUMENTATION

JAN 22 1998

SECTION

LAND CORNER RECORDATION CERTIFICATE
Filing Requirement of Act 74, Mich. P.A. 1970

Register's Office }
Gogebic County } ss.

Received for record the
22ND day of DECEMBER
A. D. 1997 at 11:00 o'clock
A. m., and recorded in
Liber 6 of CORNERS
on page 298
Ramona Collins, Deputy
Register of Deeds

For corners in
Gogebic

(County)	Located In:	Corner Code #
1. Public Land Survey	Section 21 48N 46W	G-8
	T ___ R ___	_____
	T ___ R ___	_____
	T ___ R ___	_____
	T ___ R ___	_____
2. Property Controlling in Section	S ___ T ___ R ___	_____
	S ___ T ___ R ___	_____
3. Miscellaneous Property in Sec.	S ___ T ___ R ___	_____
	S ___ T ___ R ___	_____

Register of Deeds Stamp & File Number

4. Lot No. _____, Recorded Plat _____
5. Private Claims _____

1/4 corner sections 21 & 22, T48N, R46W

I, John R. Garske, in a field survey on December 9, 1997 do hereby state that under requirements of P.A. 74, Michigan P.A. of 1970, the corner points mentioned in lines 1 and 2 above were in conformance with regulations and rules therefore as required in the current manual of survey instructions of the United States Department of the Interior, Bureau of Land Management or by a decree of a Court of Law and/or that the corner points mentioned in lines 3, 4 and 5 above were in conformance with the rules of the Michigan Board of Land Surveyors or by a Decree of a Court of Law; established, re-established, monumented, recovered, found as expressed below:

NOTE: Not more than 2 corners, all in the same town and range, may be recorded on this certificate.

	A	B	C	D	E	F	G	H	I	J	K	L	M
1													
2	6		5		4		3		2		1		
3													
4	7		8		9		10		11		12		
5													
6	18		17		16		15		14		13		
7													
8	19		20		21		22		23		24		
9													
10	30		29		28		27		26		25		
11													
12	31		32		33		34		35		36		
13													

A. Description of original monument and accessories and/or subsequent restoration:

1. - Original Township survey by Austin Burt, Deputy Surveyor in 1851. He set a wood post from which:
Sugar 14" S79°W 17 links
Ironwood 6" S79°E 9 links
2. - 1979 - Corner set by Richard Drahn R.L.S. 21564 Rec. L.2 pg. 39.
3. - 12/85 - E. Willine & J. Stelmark, corner & B.T.'s - ok, repainted B.T.'s.

PEER GROUP APPROVED
Richard L. Drahn 12/19/97
COUNTY REPRESENTATIVE

B. Description of corner evidence found and/or method applied in restoring or reestablishing corner:

- 2 - Richard Drahn reset corner position by projection of line from the section corner north through a recovered line tree. Proportional measurement, section corner to line tree, line tree to 1/4 corner was used in positioning corner. He checked occupational lines for 1 1/2 miles south, consulted with local resident, examined County Road records and Forest Service road easement records. Drahn then set a 2" I.D. x 1.6 foot long, concrete filled iron pipe with a 3" brass cap stamped T48N, R46W, 1/4 S-22, 1979, R.L.S. 21564, from which he established the following witnesses: 9" sugar maple - S84°W 52.4 feet; 9" yellow birch - S60°E 61.5 feet, 6" yellow birch N 59°E - 84.1 feet; 14" plastic reference hub - west - 50.0 feet; and 4" standard reference monument - east 50.0 feet.
- I found the brass capped iron pipe 1.6 feet below ground at the corner position and the accessories mentioned above.

(Research on file)

C. Description of monument for corner and accessories established to perpetuate locating the position of the corner:

I accepted the brass capped iron pipe as being the corner and it's accessories and from which:

Old Steel Sign Rail	East	1.80 feet
Set 6' Steel Sign Rail	South	1.45 feet
Reference Monument	East	50.00 feet (M&R) existing
10" Maple	S84°W	52.40 feet (M&R) existing
10" Yellow Birch	S60°E	61.50 feet (M&R) existing
8" Yellow Birch	N59°E	84.10 feet (M&R) existing
Found nail in trees.		

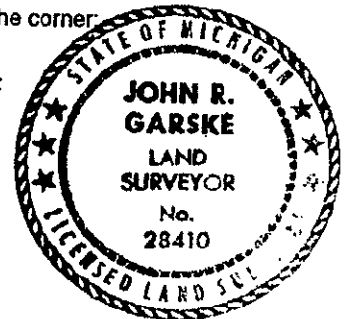

Signed by John R. Garske
Surveyor's Michigan License No. 28410

Date 12/19/97