

Register's Office }
Gogebic County } ss.

LAND CORNER RECORDATION CERTIFICATE
Filing Requirement of Act 74, Mich. P.A. 1970

Received for record the
30TH day of DECEMBER
A. D. 1993 at 12:20 o'clock
P m., and recorded in
Liber 4 of CORNERS
on page 323
Betty Saari, Deputy
Register of Deeds

For corners in
Gogebic
(County)

Located In: Corner Code #

- 1. Public Land Survey Section 4 T 47N R 46W G-1
T _____ R _____
T _____ R _____
T 48N R 46W G-13
- 2. Property Controlling S _____ T _____ R _____
in Section S _____ T _____ R _____
- 3. Miscellaneous S _____ T _____ R _____
Property in Sec. S _____ T _____ R _____

Register of Deeds Stamp & File Number

- 4. Lot No. _____, Recorded Plat _____
- 5. Private Claims _____

Section corner common to S-4 & 3, T47N, R46W and S-33 & 34, T48N, R46W.

December 7 19 93

I, John R. Garske, in a field survey on _____, 19 _____, do hereby certify that under requirements of P.A. 74, Michigan P.A. of 1970, the corner points mentioned in lines 1 and 2 above were in conformance with regulations and rules therefore as required in the current manual of survey instructions of the United States Department of the Interior, Bureau of Land Management or by a decree of a Court of Law and/or that the corner points mentioned in lines 3, 4 and 5 above were in conformance with the rules of the Michigan Board of Land Surveyors or by a Decree of a Court of Law; established, re-established, monumented, re-monumented, recovered, found as expressed below:

NOTE: Not more than 4 corners, all in the same town and range, may be recorded on this certificate.

| A | B | C | D | E | F | G | H | I | J | K | L | M |
|----|----|----|----|----|----|----|---|---|---|---|---|---|
| 2 | 6 | 5 | 4 | 3 | 2 | 1 | | | | | | |
| 3 | | | | | | | | | | | | |
| 4 | 7 | 8 | 9 | 10 | 11 | 12 | | | | | | |
| 5 | | | | | | | | | | | | |
| 6 | 13 | 17 | 16 | 15 | 14 | 13 | | | | | | |
| 7 | | | | | | | | | | | | |
| 8 | 19 | 20 | 21 | 22 | 23 | 24 | | | | | | |
| 9 | | | | | | | | | | | | |
| 10 | 30 | 29 | 28 | 27 | 26 | 25 | | | | | | |
| 11 | | | | | | | | | | | | |
| 12 | 31 | 32 | 33 | 34 | 35 | 36 | | | | | | |
| 13 | | | | | | | | | | | | |

- A. Description of original monument and accessories and/or subsequent restoration:

Original survey by Austin Burt on September 9, 1847. Set black ash post from which an 8" Y. birch bears N24°E, 33 links and a 10" hemlock bears N65°W, 21 links.

No original evidence found.

- B. Description of corner evidence found and/or method applied in restoring or reestablishing corner:

Corner position was established at the center line of North Moore Road at the intersection with ancient fence lines running east and west. This location is consistent with natural feature ties and checks closely with dimensions taken from 1920's era Soo Line Railroad plans with ties taken with corners to the north. Measurements taken to known corner positions to the east, west and south also were used to verify this corner position. This position is marked by a P.K. nail which has been used in several surveys of record and accepted by the Road Commission as the section corner.

PEER GROUP APPROVED
Richard L. Drah 4/6/95
COUNTY REPRESENTATIVE

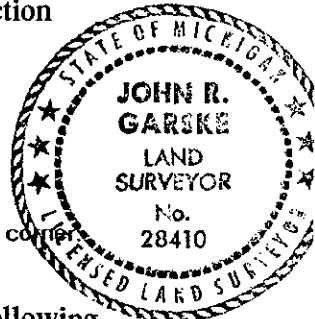

- C. Description of monument for corner and accessories established to perpetuate locating the position of the corner:

Replaced a found P.K. nail with a cotton spike set below road grade. Established the following bearing trees and reference objects:

- 10" elm - N27°-30'E - 68.24 feet
- 10" ash - S86°E - 33.27 feet
- Power pole #33-94/11 - S69°W - 35.05 feet
- Reference monument - N60°W - 30.40 feet - Set standard Bernsten 2 1/2" aluminum pipe x 30" long with 3 1/2" aluminum cap stamped and a steel sign post - north - 0.88 feet
- Reference monument - S39°W - 65.55 feet - Set standard Bernsten 3 1/2" stamped aluminum cap on a 3/4" x 30" rebar, steel sign post - 0.91 feet

Signed by John R. Garske Date 12/21/93
Surveyor's Michigan License No. 28410