

# SURVEY & REMONUMENTATION

JAN 22 1998

SECTION

## LAND CORNER RECORDATION CERTIFICATE Filing Requirement of Act 74, Mich. P.A. 1970

Register's Office }  
Gogebic County } ss.

Received for record the  
22<sup>nd</sup> day of DECEMBER  
A. D. 1997 at 11:10 o'clock  
A m., and recorded in  
Liber 6 of CORNERS  
on page 307  
Ramona Collins, Deputy  
Register of Deeds

For corners in  
Gogebic

Located In: Corner Code #

(County)	Section 26	48N	47W	K-9
1. Public Land Survey	T	R		
	T	R		
	T	R		
	T	R		
2. Property Controlling in Section	S	T	R	
	S	T	R	
3. Miscellaneous Property in Sec.	S	T	R	
	S	T	R	

Register of Deeds Stamp & File Number

4. Lot No. \_\_\_\_\_, Recorded Plat \_\_\_\_\_  
5. Private Claims \_\_\_\_\_

Section corner to 23, 24, 25, & 26, T48N, R47W

I, John R. Garske, in a field survey on December 11, 1997 do hereby state that under requirements of P.A. 74, Michigan P.A. of 1970, the corner points mentioned in lines 1 and 2 above were in conformance with regulations and rules therefore as required in the current manual of survey instructions of the United States Department of the Interior, Bureau of Land Management or by a decree of a Court of Law and/or that the corner points mentioned in lines 3, 4 and 5 above were in conformance with the rules of the Michigan Board of Land Surveyors or by a Decree of a Court of Law; established, re-established, monumented, recovered, found as expressed below:

NOTE: Not more than 2 corners, all in the same town and range, may be recorded on this certificate.

	A	B	C	D	E	F	G	H	I	J	K	L	M
1													
2		6		5		4		3		2		1	
3													
4		7		8		9		10		11		12	
5													
6		10		17		16		15		14		13	
7													
8		19		20		21		22		23		24	
9													
10		30		29		28		27		26		25	
11													
12		31		32		33		34		35		36	
13													

A. Description of original monument and accessories and/or subsequent restoration:

Original corner set by William Ives, D.S. in 1848.  
He set a wood post from which:  
Hemlock 22" S43°W 32 links  
Hemlock 18" N55°E 32 links

B. Description of corner evidence found and/or method applied in restoring or reestablishing corner:

No evidence of the original survey exists. I positioned the corner at the centerline intersection of Skyway Lane and an ancient fence line running east. An old farm lane runs west from this location. Distances north and south to fence lines check well with this position.  
Distance north to 1/4 corner 23 & 24 - 2643.16 feet  
Distance south to 1/4 corner 25 & 26 - 2620.27 feet

(Research on file)

C. Description of monument for corner and accessories established to perpetuate locating the position of the corner:

At the corner position in the center of Skyway Lane a gravel road I set a 5/8" x 10" iron rod with a 3 1/4" alum cap stamped to identify the corner, from which:  
A reference monument consisting of a 3/4" dia. 3' long alum. rod with a stamped 3 1/4 dia. alum. cap  
S45°W - 30.48 feet, Steel Sign Post - 1.31 feet  
6" Cedar East 60.85 feet  
Power Pole S34°E 54.57 feet  
6" S. Maple N48°E 68.22 feet

Signed by John R. Garske  
Surveyor's Michigan License No. 28410

Date 12/19/97

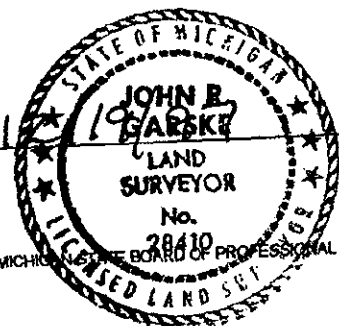

FORM APPROVED BY MICHIGAN STATE BOARD OF PROFESSIONAL SURVEYORS, JAN. 28, 1971  
REVISED MAY 14, 1975  
REVISED JAN., 1983  
REVISED OCT., 1995

R-2.1 307