

SURVEY & REMONUMENTATION

APR 07 1995

COMMISSION

LAND CORNER RECORDATION CERTIFICATE

Filing Requirement of Act 74, Mich. P.A. 1970

Register's Office }
Gogebic County } ss.

Received for record the

21st day of OCTOBER

A. D. 1994 at 11:20 o'clock

9 m., and recorded in

Liber 5 of CORNERS

on page 150

Ramona Collins, Deputy
Register of Deeds

Register of Deeds Stamp & File Number

For corners in

Gogebic
(County)

Located In:

Gogebic County

Corner Code #

- | | | |
|------------------------------------|----------------------------|--------------|
| 1. Public Land Survey | T <u>48</u> NR <u>48</u> W | <u>G - 5</u> |
| | T _____ R _____ | _____ |
| | T _____ R _____ | _____ |
| | T _____ R _____ | _____ |
| 2. Property Controlling in Section | S _____ T _____ R _____ | _____ |
| | S _____ T _____ R _____ | _____ |
| 3. Miscellaneous Property in Sec. | S _____ T _____ R _____ | _____ |
| | S _____ T _____ R _____ | _____ |

4. Lot No. _____, Recorded Plat _____
5. Private Claims _____

Section Corner 9, 10, 15 & 16

I, Richard L. Drahn in a field survey on October 9, 19 94, do hereby certify that under requirements of P.A. 74, Michigan P.A. of 1970, the corner points mentioned in lines 1 and 2 above were in conformance with regulations and rules therelore as required in the current manual of survey instructions of the United States Department of the Interior, Bureau of Land Management or by a decree of a Court of Law and/or that the corner points mentioned in lines 3, 4 and 5 above were in conformance with the rules of the Michigan Board of Land Surveyors or by a Decree of a Court of Law; established, re-established, monumented, re-monumented, recovered, found as expressed below:

NOTE: Not more than 4 corners, all in the same town and range, may be recorded on this certificate.

A. Description of original monument and accessories and/or subsequent restoration:

Corner established by William Ives, Deputy Surveyor on August 6, 1848.
Original bearing trees: Y. Birch 10" S 67 W 21 links (13.86 ft.)
Hemlock 18" N 34 W 39 links (25.74 ft.)

M.J. Valentine, timber cruiser, on 5/2/35 recovered a 20 scribed B.T. and placed a location tag on a 18" Hemlock.

Corner research form on file at Gogebic County Register of Deeds Office.

B. Description of corner evidence found and/or method applied in restoring or reestablishing corner:

Restored corner position at record bearing and distance from the Hemlock bearing tree; it is now a 18-22" downed hemlock with GLO blazes and all scribing and the measuring notch still visible. No evidence remains of the Y. Birch bearing tree. The 4.88 chain distance north to Hemlock 16" line tree, checks to a 20-24" broken hemlock stub.

PEER GROUP

Approved

Richard L. Drahn

10/12/94

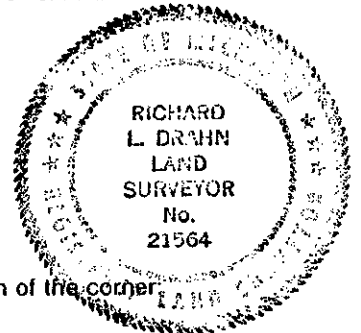

C. Description of monument for corner and accessories established to perpetuate locating the position of the corner:

At the corner position I set a 3/4" X 4' solid aluminum marsh rod with a 3 1/4" aluminum cap stamped to read: COUNTY REMONUMENTATION, T.48 N., R.48 W.; S. 9, S. 10, S.15, S.16; 1994; R.L.S. 21564. From which I established the following new blazed and scribed bearing trees:

12"	Hemlock	N.20E.	34.25 feet
14"	Hemlock	N.59W.	35.85 feet
19"	Hemlock	S.03E.	51.08 feet
6'	Steel sign rail	S.83E.	1.85 feet

Signed by Richard L. Drahn

Date October 9, 1994

Surveyor's Michigan License No. 21564