

REMONUMENTATION

GRATIOT CO. MICH. RECORDED

LAND CORNER RECORDATION CERTIFICATE

WGT. William Tingley, PS, Chairman Filing Requirement of Act 74, Mich. P.A. 1970

'96 NOV 26 PM 2 35

For corners in Clinton & Gratiot (County) Located In: Corner Code #

1. Public Land Survey Duplain Twp	T 8N R 1W	A-1
	T 8N R 2W	M-01
Greenbush	T 9N R 1W	A-13
Elba	T 9N R 2W	M-13
Washington		
2. Property Controlling in Section	S T R	
3. Miscellaneous Property in Sec.	S T R	
4. Lot No. _____, Recorded Plat _____		
5. Private Claims _____		

SURVEY & REMONUMENTATION  
SEP 08 1999  
REGISTER OF DEEDS STAMP & FILE NUMBER SECTION

Janet M. Davis REGISTER OF DEEDS

I, Norman C. Caldwell, in a field survey on April 1996, do hereby certify that under requirements of P.A. 74, Michigan P.A. of 1970, the corner points mentioned in lines 1 and 2 above were in conformance with regulations and rules therefore as required in the current manual of survey instructions of the United States Department of the Interior, Bureau of Land Management or by a decree of a Court of Law and/or that the corner points mentioned in lines 3, 4 and 5 above were in conformance with the rules of the Michigan Board of Land Surveyors or by a Decree of a Court of Law; established, re-established, monumented, re-monumented, recovered, found as expressed below:

WASHINGTON TWP. GRATIOT CO.

A	B	C	D	E	F	G	H	I	J	K	L	M
6	5	4	3	2	1							
7	8	9	10	11	12							
18	17	16	15	14	13							
19	20	21	22	23	24							
30	29	28	27	26	25							
31	32	33	34	35	36							

NOTE: Not more than 4 corners, all in the same town and range, may be recorded on this certificate.

A. Description of original monument and accessories and/or subsequent restoration:

A-1 Standard Township Cor. of T8 & 9N, R1 & 2W  
Temporary Post placed by Robert Clark, Jr, 29 January 1831  
Township Corner post placed by Robert Clark Jr, 28 February 1831  
References: S 38 E 40 lks (26.40') 40" W. Oak  
S 61 W 48 lks (31.68') 12" Beech

GREENBUSH TWP CLINTON CO. DUPLAIN TWP. CLINTON CO.

D. W. Aetenburg, Deputy Gratiot County Surveyor, in a survey made June 6 and 27-29, 1870 and recorded in Book "A" at page 184 and Book "B" at page 70 indicates this corner position is marked by a post under a stone. He marked the following references: N 77 W 1.2025 Ch (79.36') 60" Oak and S 21 W .6575 Ch (43.40') 6" Hickory.

Ransom J. Fraker, Gratiot County Surveyor, in a survey made April 24-26, 1877, and recorded in Book "B" at page 243 repeats the previous record by D. W. A.

Survey of Section 6, T 8 N, R 1 W, by H. H. Jenison, Clinton County Surveyor, on the 10, 11 & 12th of June, 1876, recorded in the Clinton County Surveyors Record, Volume #1 at page 30, indicates dimensions to this position but does not recite new references.

(SEE SECTION "A" ON BACK)

B. Description of corner evidence found and/or method applied in restoring or reestablishing corner:

A-1 Standard Township Cor. of T8 & 9N, R1 & 2W  
Found record 3/4" pipe (6" deep) over a 3/4" pipe (42" deep) with stones, brick & crockery. No apparent conflicting evidence and this position is accepted as a perpetuation of the original government corner.  
Approved by the joint Clinton/Shiawassee County Remonumentation peer group 22 May 1996.

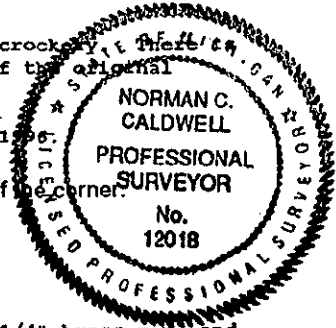

C. Description of monument for corner and accessories established to perpetuate locating the position of the corner:

A-1 Standard Township Cor. of T8 & 9N, R1 & 2W  
Standard Township Corner of T8 & 9N, R1 & 2W  
Found record 3/4" pipe over 3/4" pipe with stones, brick & crockery.  
Placed a standard Clinton County monument, consisting of a 2" x 30" steel pipe, 3-1/4" brass cap, and plastic base with magnet.  
References:  
S 70 E 88.20' 42" W. Oak w/ 12018 Tag  
S 45 E 41.13' 15" Maple w/ 12018 Tag  
S 35 W 54.34' 8" W. Oak w/ 12018 Tag  
N 50 E 33.05' 12" wooden post w/ 12018 Tag

APPROVED BY CLINTON CO. REMON PEER GROUP 5-22-96  
RECORDED IN L 4, P147-148 CLINTON COUNTY 7-9-96

Signed by [Signature] Date 31 MAY 1996  
Surveyor's Michigan License No. 12018

(SECTION A CONTINUED)

A-1 Standard Township Cor. of T8 & 9N, R1 & 2W

Survey of Section 1, T 8 N. R 2 W, by Charles E. Hollister, Clinton County Surveyor, on the 13, 14 & 15th of May, 1879, recorded in the Clinton County Surveyors record, Volume #1, at page 74, indicates a stone at this position with one witness stump standing. He marked the following new reference: S 13 E 42.25 links (27.89') 6" Burr Oak

GRATIOT CO.

David B. Whittier, P.S. #10070, in surveys dated August 12, 1974 recorded in Liber 1 at page 349 and an L.C.R.C. dated August, 1974 recorded in Liber 1 at page 269, found large stone with crockery & china around, also 7 small stones and placed a 3/4" pipe. He marked the following references: S 45 E 41.00' 18" Maple and S 70 E 88.68 50" Oak

CLINTON CO.

John F. Quine, P.S. #~~10070~~<sup>10704</sup>, in a survey dated 5 April 1977 and recorded in Liber 1 at page 875, found a 3/4" Pipe, 6" deep at this position and marked new references N 45 E 38.95' Telephone riser, S 45 E 35.75' Road sign, S 45 E 40.95' 16" Maple, S 45 W 35.75' Telephone riser, S 55 W 45.9' 24" Stump, N 45 W 32.7' Road sign.

CLINTON CO.

Mark L. Vanraemdonck, P.S. 24522, on a survey dated 25 March, 1986 in Liber 2 at page 911 and an L.C.R.C. dated 22 August 1985 in Liber 2 at page 582 found record 3/4" pipe and recorded the following references: S 30 E 35.82' NW Cor. road sign post, N 45 E 39.00' bolt in top of telephone riser, N 45 W 32.68' SE face road sign post, S 45 W 37.00' top center tel. cable pedestal.

SURVEY &  
REMONUMENTATION

SEP 08 1999

SECTION