

GRATIOT COUNTY REMONUMENTATION PROGRAM

JAN 20 2000

LAND CORNER RECORDATION CERTIFICATE

Filing Requirement of Act 74, Mich. P.A. 1970

STATE OF MICHIGAN
GRATIOT COUNTY
RECORDED

11 JAN 2000 9:34 A.M.

JANET M. DAVIS
REGISTER OF DEEDS

Register of Deeds Stamp & File Number

SECTION

For corners in
Gratiot
(County)

Located In: Corner Code #
Hamilton Township

1. Public Land Survey	Sec 31	T 10N	R 1W	C-13
		T	R	
		T	R	
		T	R	
		T	R	
2. Property Controlling in Section	S	T	R	
	S	T	R	
3. Miscellaneous Property in Sec.	S	T	R	
	S	T	R	

4. Lot No. _____, Recorded Plat _____
5. Private Claims _____

I, William G. Tingley a field survey on August 05, 1999, do hereby certify that under requirements of P.A. 74, Michigan P.A. of 1970, the corner points mentioned in lines 1 and 2 above were in conformance with regulations and rules therefore as required in the current manual of survey instructions of the United States Department of the Interior, Bureau of Land Management or by a decree of a Court of Law and/or that the corner points mentioned in lines 3, 4 and 5 above were in conformance with the rules of the Michigan Board of Land Surveyors or by a Decree of a Court of Law; established, re-established, monumented, re-monumented, recovered, found as expressed below:

NOTE: Not more than 2 corners, all in the same town and range, may be recorded on this certificate.

A. Description of original monument and accessories and/or subsequent restoration:

- 1831, Robert Clark Jr., Deputy Survey, GLO Notes
80.00 chains; set post corner Section 31 and 32
Maple 7" N63°W 26 links
Black Ash 14" N30°E 1 links
- 1879, Thomas Harrod, Deputy County Surveyor, Liber B, Pages 289, Record of Minutes of Survey
Oak Post 3" x 3" - Old Section Corner Found
Elm 18" S40°W 49 links
Elm 14" N89-1/2°W 107 links
- County Road Commission Record (not date)
Pipe Corner 1-1/2" x 48" - placed on line and at distance
- 1968, Consumers Power Survey for transmission line. Found stone set "T" iron
"X" on bridge abutment Northwest 25.2 feet
"X" on bridge abutment Northeast 25.55 feet
Nail Northside Power Pole Southwest 65.70 feet
Nail Northside Telephone Pole Southeast 34.84 feet
- No other references found.

ACCEPTED BY THE GRATIOT COUNTY SURVEY PEER GROUP AS THE OFFICIAL CORNER UNDER MICHIGAN PUBLIC ACT 345 OF 1990 AT A MEETING HELD 11/24/99

WGT
William Tingley, PS, Chairman

B. Description of corner evidence found and/or method applied in restoring or reestablishing corner:

Searched at apparent location of the corner and found a "T" Iron 0.8' below the surface surrounded by three rocks 1.0' below surface. Found a large rock to the West of the "T" Iron 1.25' below the surface, under the rock found remnants of wood 2.4' below the surface. The remnant of wood was 0.55' West of the "T" Iron. This corner is accepted as a careful and faithful perpetuation of the position of the original corner.

C. Description of monument for corner and accessories established to perpetuate locating the position of the corner:

C-13: Town 10 North, Range 01 West, Hamilton Township, Gratiot County.
Set Standard Remonumentation Pipe over the remnants of wood. Witnessed by:

Nail & Tag #34975 SE side Power Pole	S65°W	65.10'
Stop Sign (center)	N64°E	28.65'
West End of 48" Culvert, T/C	N40°W	37.65'
East End of 48" Culvert, T/C	N46°E	39.15'
Iron and Yellow Cap #34975	East	11.70' to "T" Iron, 12.25' to wood

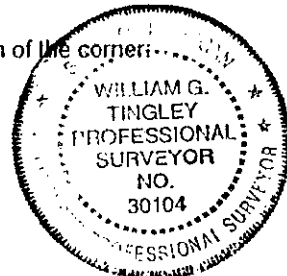

Bearings given are magnetic. Standard Monumentation consists of a Berntsen stainless steel 30" x 2 3/8" pipe with a brass cap stamped "GRATIOT COUNTY REMONUMENTATION", P.S. 30104.

Signed by William G. Tingley Date 1/2/00, 1999

Surveyor's Michigan License No. 30104

	A	B	C	D	E	F	G	H	I	J	K	L	M
1													
2	6		5		4		3		2		1		
3													
4	7		8		9		10		11		12		
5													
6	18		17		16		15		14		13		
7													
8	19		20		21		22		23		24		
9													
10	30		29		28		27		26		25		
11													
12	31		32		33		34		35		36		
13													