

MAY 05 1997

GRATIOT COUNTY REMONUMENTATION PROGRAM

LAND CORNER RECORDATION CERTIFICATE

GRATIOT CO. MICH. RECORDED

COMMISSION

Filing Requirement of Act 74, Mich. P.A. 1970

'96 NOV 26 PM 2 34

Janet M. Davis REGISTER OF DEEDS

For corners in Gratiot Located In: _____ Corner Code _____
 # (County) Arcada Township

1. Public Land Survey Sec 13 T 11N R 3W M-7, Sec Corner
 T _____ R _____
 T _____ R _____
 T _____ R _____

2. Property Controlling S _____ T _____ R _____
 in Section S _____ T _____ R _____

3. Miscellaneous S _____ T _____ R _____
 Property in Sec. S _____ T _____ R _____

4. Lot No. _____ Recorded Plat _____

5. Private Claims _____

Register of Deeds Stamp & File Number

	A	B	C	D	E	F	G	H	I	J	K	L	M
1													
2	6	5	4	3	2	1							
3													
4	7	8	9	10	11	12							
5													
6	18	17	16	15	14	13							
7													
8	19	20	21	22	23	24							
9													
10	30	29	28	27	26	25							
11													
12	31	32	33	34	35	36							
13													

I, William Tingley a field survey on September 5, 1995, do hereby certify that under requirements of P.A. 74, Michigan P.A. of 1970, the corner points mentioned in lines 1 and 2 above were in conformance with regulations and rules therefore as required in the current manual of survey instructions of the United States Department of the Interior, Bureau of Land Management or by a decree of a Court of Law and/or that the corner points mentioned in lines 3, 4 and 5 above were in conformance with the rules of the Michigan Board of Land Surveyors or by a Decree of a Court of Law; established, re-established, monumented, re-monumented, recovered, found as expressed below:

NOTE: Not more than 4 corners, all in the same town and range, may be recorded on this certificate.

A. Description of original monument and accessories and/or subsequent restoration:

1831, Robert Clark, Jr., Deputy Surveyor, GLO Notes
 Set Post Corner, Sections 13 and 24

Beech 11" S68°W 27 links
 Aspen 14" N46-1/2°W 43 links

1894, D.W. Altenburg, County Surveyor, Liber C, page 42, Record of Minutes of Survey

Pipe Corner in post

Fence Post East 32.1 feet
 Fence Post Southwest 57.2 feet

1961, Michigan State Highway Department, Resurfacing Plans Using 1931 Construction Plans, Station 131 +95.4 Arcada

Corner and 132+29.7 Emerson Corner

Iron Pipe on Centerline Tyler Road
 Corner Fence Post East 32.1 feet
 Corner Fence Post Southwest 57.2 feet

1974, David Whittier, #10070, LCRC, Liber 1, Page 229

Found 3/8" Rod and Plow Share in Monument Box
 Southeast Corner Long retaining wall Northwest 47.63 feet
 Tyler and State Road Sign Southwest 57.5 feet

1975, Donald Hunter #19177, Survey in Liber 399, Page 1198

Refers to Liber 1, pages 229 and 230

1977, D. B. Whittier, #10070 in Survey Liber 409, page 346

Southeast Corner Iron (plowside or sleigh shoe) in Monument Box
 North to Emerson Corner 34.3 feet
 Corner Concrete Wall Northwest 47.5 feet
 Northwest Corner Square Catch Basin Southwest 44.5 feet

ACCEPTED BY THE GRATIOT COUNTY SURVEY PEER GROUP AS THE OFFICIAL CORNER UNDER MICHIGAN PUBLIC ACT 345 OF 1990 AT A MEETING HELD 10/15/96

WGT
 William Tingley, PS, Chairman

Continued on Back

B. Description of corner evidence found and/or method applied in restoring or reestablishing corner:

Found 3/8" Rod in Monument Box on Centerline of State Road and Tyler Road (West)

C. Description of monument for corner and accessories established to perpetuate locating the position of the corner:

Set Remonumentation Monument over 3/8" Rod in Monument Box

Chiseled "X" Top of Southeast Corner Concrete Retaining Wall N45°W 48.19 feet
 Southwest Corner Square Steel Sign Post (westerly post) S45°E 90.3 feet
 Southeast Corner East End Southerly Curb Return N85°E 74.42 feet
 Northeast Corner Square Catch Basin Top S45°W 43.90 feet

This corner is accepted as a careful and faithful perpetuation of the position of the original corner.

Signed by William G. Tingley Date 10/15/96 1996

Surveyor's Michigan License No. 30104

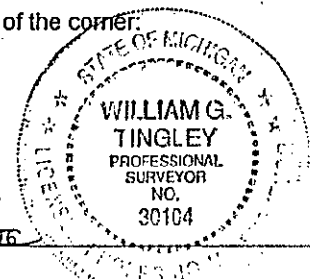

1980, T.J. Mueller #25861, LCRC, Liber 1, Page 522			
3/4" Iron in Monument Box			
Northwest corner of Right of Way marker	Southeast		73.44 feet
East edge arrow road sign post	East/Southeast		37.37 feet
Southeast corner concrete Wall	Northwest		47.51 feet
Southeast corner Section 18 T11N-R2W,	North		34.25 feet
1980, T.J. Mueller #25861, Survey, Liber 436, Page 1260			
Same data as LCRC Liber 1, Page 522			
1985, Jan Fokens #21567, Survey Liber 469, Page 886			
Same data as LCRC, Liber 1, Page 522			
1993, W.B. Ruddell #14769, Survey Liber 528, Page 1288			
Found 3/4" Rod in Monument Box			
Cable Route Post	East		44.7 feet
Reflector on 6" pipe guard post	Southeast		38.3 feet
Corner concrete wall	Northwest		47.50 feet
Southeast corner Section 18	North		34.25 feet
1993, G. Gray, LCRC, Liber 2, Page 322			
Found 3/8" Rod in Monument Box			
"X" Top of Concrete Wall	N41°W		48.26 feet
Top, West end of culvert	S52°W		50.51 feet
Monument Box	N04°E		34.34 feet
Top Centerline Catch Basin	S36°E		49.79 feet
1995, Gratiot County Road Commission Plans, federal Aid, MSTP 9529 (002) Station 54+39, Section			
Corner 13 and 24			
Found 3/8" Rod in Monument Box in Center of Road -- Station 54 + 74 Section Corner 18 and 19			
Monument Box Center of Road			