

**SURVEY &
REMONUMENTATION**

APR 27 1995

LIDER 003 PAGE 530

COMMISSION

LAND CORNER RECORDATION CERTIFICATE
Filing Requirement of Act 74, Mich. P.A. 1970

STATE OF MICHIGAN
GRAND TRAVERSE COUNTY
RECORDED

For corners in

Grand Traverse (County)	Located In:	Corner Code ##
1. Public Land Survey	T 25N R 10W	G-7
	T _____ R _____	_____
	T _____ R _____	_____
	T _____ R _____	_____
2. Property Controlling in Section	S _____ T _____ R _____	_____
	S _____ T _____ R _____	_____
3. Miscellaneous Property in Sec.	S _____ T _____ R _____	_____
	S _____ T _____ R _____	_____

29 DEC 94 3:25 P.M.

KARON ANDERSON
REGISTER OF DEEDS

Register of Deeds Stamp & File Number

4. Lot No. _____, Recorded Plat _____
5. Private Claims _____

	A	B	C	D	E	F	G	H	I	J	K	L	M
2	8	5	4	3	2	1							
3													
4	7	8	9	10	11	12							
5													
6	18	17	16	15	14	13							
7													
8	19	20	21	22	23	24							
9													
10	30	29	28	27	26	25							
11													
12	31	32	33	34	35	36							
13													

I, Robert F. Mitchell, in a field survey on August 13, 19 94, do hereby certify that under requirements of P.A. 74, Michigan P.A. of 1970, the corner points mentioned in lines 1 and 2 above were in conformance with regulations and rules therefore as required in the current manual of survey instructions of the United States Department of the Interior, Bureau of Land Management or by a decree of a Court of Law and/or that the corner points mentioned in lines 3, 4 and 5 above were in conformance with the rules of the Michigan Board of Land Surveyors or by a Decree of a Court of Law; established, re-established, monumented, re-monumented, recovered, found as expressed below:

NOTE: Not more than 4 corners, all in the same town and range, may be recorded on this certificate.

A. Description of original monument and accessories and/or subsequent restoration:

G-7) Sec Cor common to Secs 15, 16, 21 & 22, T25N-R10W; "Elm post witnessed by a Sugar 15" S87°W 31 links and a Sugar 14" N32°E 28 links", U.S. Survey by L.S. Scranton dated August 1852. "Set new stake at Cor 15, 16, 21 & 22", Survey by S. Hodgemen dated Sept. 15, 1876 and on file in G.T. Co. Surveyor Records. "Pd 1 witness tree and the old cor in the ground", survey by C.P. Tuller dated May 27, 1902, survey notes on file at Mitchell & Assoc. "Iron at SE Cor of Sec 16, T25N-R10W witness by a Sugar 10" N4 1/2°W 126' and the SW Cor of Pullvers cellar wall is North N27°E 205.6'", a road survey by E.P. Waterman Co. Surveyor dated June 16 & 17, 1908 and on file in the G.T. Co. Surveyor Records. "Pd 1 1/4" iron bar", LCR by J.L. Wilcox recorded in L.2, Pg. 361 of LCR's of G.T. Co. "Pd 1 1/4" iron bar", Cert. of Survey by J.L. Wilcox recorded in L.3, Pg 516 of the Cert. Surveys of G.T. Co. "Pd a 1" dia. bar in a monument box, Cor falls in the C/L of Summit City Rd North-South and 11' +/- North of the C/L of Gleanor Hall Rd to the East. Iron fits 1 remaining Wilcox witness of record", a LCR by Robert F. Mitchell dated Dec. 21, 1989 recorded in L.3, Pg.208 of G.T. Co. Land Corner Records.

B. Description of corner evidence found and/or method applied in restoring or reestablishing corner:

G-7) Sec Cor common to Secs 15, 16, 21 & 22, T25N-R10W; "Pd 1 1/4" x 24" iron bar over a plow tine surrounded by an assortment of clay pottery fragments all below a monument box", as recored in L.2, Pg.361 of the LCR's of G.T. Co. and is accepted as a careful and faithful perpetuation of the position of the original corner. Remonumented this position with a 2 1/2" x 30" flanged bottom galvanized iron pipe with a 3 1/4" brass Cap stamped GRAND TRAVERSE COUNTY REMONUMENTATION, in a monument box 9" below the C/L of a North-South bituminous rd.

**UNANIMOUSLY ACCEPTED BY THE
GRAND TRAVERSE COUNTY PEER
REVIEW GROUP AS THE OFFICIAL
CORNER UNDER MICHIGAN PUBLIC
ACT 348 OF 1990 AT A MEETING
HELD ON 7-13-94**

Robert F. Mitchell
ROBERT F. MITCHELL, P.S., C.M.A.S./A.N.

C. Description of monument for corner and accessories established to perpetuate locating the position of the corner:

G-7) Sec Cor common to Secs 15, 16, 21 & 22, T25N-R10W

A 2 1/2" x 30" flanged bottom galvanized iron pipe with a 3 1/4" brass Cap stamped GRAND TRAVERSE COUNTY REMONUMENTATION, in a monument box 9" below surface of North-South black topped rd.

- N68°E - Cut-off Power Pole - 69.03'
- S45°E - Power Pole - 73.60'
- N75°W - 8" Red Pine - 72.72'
- N37°W - 6" Red Pine - 66.85'

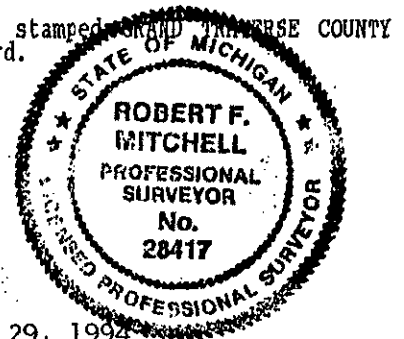

Signed by *Robert F. Mitchell*

Date December 29, 1994

Surveyor's Michigan License No. 28417