

MAY 07 1997

COMMISSION

LAND CORNER RECORDATION CERTIFICATE
Filing Requirement of Act 74, Mich. P.A. 1970

For corners in

Grand Traverse Located In: Corner Code #
(County)

1. Public Land Survey T 26 N R 11 W C-05

G.T. County Code 96-26

I, Corey J. Hughes, in a field survey performed in October, 1996, do hereby certify that under requirements of P.A. 74, Michigan P.A. of 1970, the corner point mentioned in lines 1 and 2 above was in conformance with regulations and rules therefore as required in the current manual of survey instructions of the United States Department of the Interior, Bureau of Land Management or by a decree of a Court of Law and /or that the corner points mentioned in lines

3, 4 and 5 above were in conformance with the rules of the Michigan Board of Land Surveyors or by a Decree of a Court of Law; established, re-established, monumented, re-monumented, recovered, found as expressed below:

A. Description of original monument and accessories and/or subsequent restoration:

GLO 1839 Burt, set post, Elm 11 S34E 42 and Sugar 13 N39W 31.

Northrup 1897, long stone with cobble stone about it in highway.

E. H. Alyn 1906, large stone with cobble stones around.

C. P. Tuller 1887, a rotten flat limestone surrounded by cobble stone.

C. P. Tuller 1903, good stone corner.

B. Description of corner evidence found and/or method applied in restoring or reestablishing corner:

Found pavement box in CL roads over 3/4"x 1.3' iron pipe over 1"x 1.6' iron rod in cobble stones.

C. Description of monument for corner and accessories established to perpetuate locating the position of the corner:

Replaced existing evidence with re-mon monument and pavement box.
PK in PP N65°E 58.42'
PK in PP S20°E 121.65'
PK in PP S65°W 64.23'
Concrete monument N22°W 71.38'

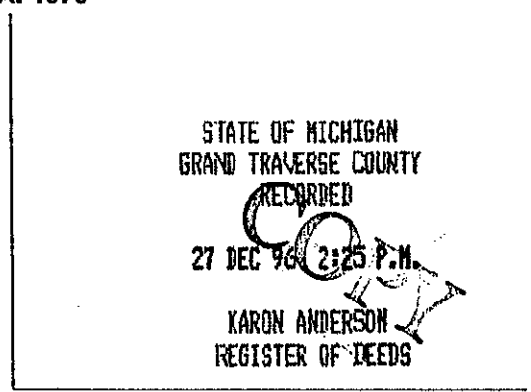

	A	B	C	D	E	F	G	H	I	J	K	L	M
2	6	5	4	3	2	1							
3													
4	7	8	9	10	11	12							
5		●											
6	18	17	16	15	14	13							
7													
8	19	20	21	22	23	24							
9													
10	30	29	28	27	26	25							
11													
12	31	32	33	34	35	36							
13													

UNANIMOUSLY ACCEPTED BY THE GRAND TRAVERSE COUNTY PEER REVIEW GROUP AS THE OFFICIAL CORNER UNDER MICHIGAN PUBLIC ACT 345 OF 1990 AT A MEETING HELD ON 10-22-96
Robert F. Mitchell
ROBERT F. MITCHELL, P.S., Chairman

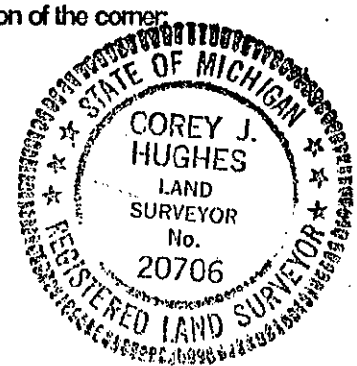

Corner approved by the Grand Traverse County Peer Review Group on October 22, 1996

Signed by Corey J. Hughes Date 12.23.96
Corey J. Hughes Michigan P.S. license No. 20706