

**SURVEY & REMONUMENTATION**

LIBER 003 PAGE 771

APR 07 1998

**LAND CORNER RECORDATION CERTIFICATE**  
Filing Requirement of Act 74, Mich. P.A. 1970

For corners in SECTION

<u>Grand Traverse</u> (County)	Located In:	Corner Code #
1. Public Land Survey	T26N R11W	F-3
	T ___ R ___	_____
	T ___ R ___	_____
	T ___ R ___	_____
2. Property Controlling in Section	S ___ T ___ R ___	_____
	S ___ T ___ R ___	_____
3. Miscellaneous Property In Sec.	S ___ T ___ R ___	_____
	S ___ T ___ R ___	_____

STATE OF MICHIGAN  
GRAND TRAVERSE COUNTY  
**COPY**  
RECORDED  
31 DEC 97 12:52 P.M.  
KARON ANDERSON  
REGISTER OF DEEDS

Register of Deeds Stamp & File Number

4. Lot No. \_\_\_\_\_, Recorded Plat \_\_\_\_\_  
5. Private Claims \_\_\_\_\_

I, Garth Stowe, in a field survey on October, 19 97 do hereby state that under requirements of P.A. 74, Michigan P.A. of 1970, the corner points mentioned in lines 1 and 2 above were in conformance with regulations and rules therefore as required in the current manual of survey instructions of the United States Department of the Interior, Bureau of Land Management or by a decree of a Court of Law and /or that the corner points mentioned in lines 3, 4 and 5 above were in conformance with the rules of the Michigan Board of Land Surveyors or by a Decree of a Court of Law, established, re-established, monumented, recovered, found as expressed below:

A	B	C	D	E	F	G	H	I	J	K	L	M
1												
2	6	5			4		3		2		1	
3												
4	7	8			9		10		11		12	
5												
6	18	17			16		15		14		13	
7												
8	19	20			21		22		23		24	
9												
10	30	29			28		27		26		25	
11												
12	31	32			33		34		35		36	
13												

NOTE: Not more than 2 corners, all in the same town and range, may be recorded on this certificate.

A. Description of original monument and accessories and/or subsequent restoration:

F-3: U.S. Gov't survey by Burt, 1839, post witnessed by sugar 12 S14E 24, sugar 11 N21W 33. William Downey RLS MDOT, 1961, set IP on line with north south fenceline midway between fence corners north and south in centerline of Beitner Road. DeLaMater, 1973, filed land corner record on Downey corner. Korr, 1986, filed land corner record on same corner. Certificate of survey Wilcox and Associates and John Korr on same corner.

B. Description of corner evidence found and/or method applied in restoring or reestablishing corner:

F-3: 1/4 corner common to sections 4 and 9, T26N, R11W  
Found 1/2" iron pipe in the centerline of Beitner Road driven into 3/4" pipe 24" long set in the middle of large stones under the road bed in line with fenceline to the north and south as noted in Grand Traverse County Land corner records L1 P601, and L3 P69.. This corner is accepted as a careful perpetuation of a locally accepted corner as monumented by Downey in 1961 and is monumented with a 2 1/2"x30" flanged bottom galvanized pipe with a 3 1/4" brass cap stamped GRAND TRAVERSE COUNTY REMONUMENTATION.

C. Description of monument for corner and accessories established to perpetuate locating the position of the corner:

F-3: 1/4 corner common to sections 4 and 9, T26N R11W  
Set 2 1/2"x30" flanged bottom galvanized pipe with a 3 1/4" brass cap stamped GRAND TRAVERSE COUNTY REMONUMENTATION in a monument box on centerline of Beitner Road on line with north/south fence.

- N 77°E 85.91' Telephone pole
- N 23°W 79.66' SE Corner of brick house
- N 38 ° W 101.55' SW corner brick house
- S 5°E 61.28' 5" Red Pine

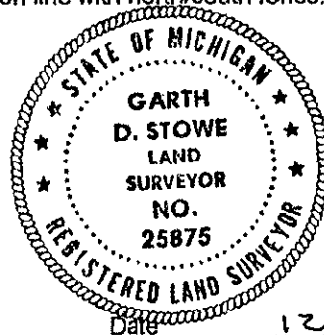

Corner approved by Grand Traverse County Peer Review Group 10-15-97

Signed by Garth D. Stowe Date 12-19-97  
Surveyor's Michigan License No. 25875

UNANIMOUSLY ACCEPTED BY THE GRAND TRAVERSE COUNTY PEER REVIEW GROUP AS THE OFFICIAL CORNER UNDER MICHIGAN PUBLIC ACT 345 OF 1990 AT A MEETING HELD ON 10-15-97  
Robert F. Mitchell  
ROBERT F. MITCHELL, P.S., Chairman