

327 MAY 07 1997

COMMISSION

LAND CORNER RECORDATION CERTIFICATE
Filing Requirement of Act 74, Mich. P.A. 1970

For corners in
Grand Traverse
(County)

Located in: Corner Code #/

1. Public Land Survey	T <u>26N</u> R <u>11W</u>	G-1
	T _____ R _____	_____
	T _____ R _____	_____
	T _____ R _____	_____
2. Property Controlling In Section	S _____ T _____ R _____	_____
	S _____ T _____ R _____	_____
3. Miscellaneous Property in Sec.	S _____ T _____ R _____	_____
	S _____ T _____ R _____	_____

STATE OF MICHIGAN
GRAND TRAVERSE COUNTY
RECORDED
27 DEC 96 2:35 P.M.

KARON ANDERSON
REGISTER OF DEEDS
Stamp & Fee Number

4. Lot No. _____, Recorded Plat _____
5. Private Claims _____

A	B	C	D	E	F	G	H	I	J	K	L	M
2	6	5	4	3	2	1						
3												
4	7	8	9	10	11	12						
5												
6	18	17	16	15	14	13						
7												
8	19	20	21	22	23	24						
9												
10	30	29	28	27	26	25						
11												
12	31	32	33	34	35	36						
13												

I, **Garth D. Stowe**, in a field survey on **October**, 19**96**, do hereby certify that under requirements of P.A. 74, Michigan P.A. of 1970, the corner points mentioned in lines 1 and 2 above were in conformance with regulations and rules therofore as required in the current manual of survey instructions of the United States Department of the Interior, Bureau of Land Management or by a decree of a Court of Law and/or that the corner points mentioned in lines 3, 4 and 5 above were in conformance with the rules of the Michigan Board of Land Surveyors or by a Decree of a Court of Law; established, re-established, monumented, re-monumented, recovered, found as expressed below:

NOTE: Not more than 4 corners, all in the same town and range, may be recorded on this certificate.

A. Description of original monument and accessories and/or subsequent restoration:

G-1: Deputy Surveyor Burt, in 1839, intersects North boundary 31 lks West of post, sets corner. Waterman, in 1908, finds blue stone with "x", ran South. Waterman in 1909 & 1915, finds blue stone with "x" and notes 20.46 foot jog at corner. Batzer, in 1971, finds blue stone with "x" witnesses. Land Corner Record by Batzer recorded in Liber 1, Page 1 and Land Corner Record by Frederick recorded in Liber 2, Page 447, Grand Traverse County Register of Deeds.

B. Description of corner evidence found and/or method applied in restoring or reestablishing corner:

G-1: Found blue stone with "x" as noted in Section A. Batzer iron found 20.46 feet East. Corner accepted as a careful and faithful perpetuation of the position of the original corner as noted by Burt in 1839.

UNANIMOUSLY ACCEPTED BY THE
GRAND TRAVERSE COUNTY PEER
REVIEW GROUP AS THE OFFICIAL
CORNER UNDER MICHIGAN PUBLIC
ACT 345 OF 1990 AT A MEETING
HELD ON 11-05-96
Robert F. Mitchell
ROBERT F. MITCHELL, P.S., CHAIRMAN

C. Description of monument for corner and accessories established to perpetuate locating the position of the corner:

G-1: Section Corner common to Sections 3 & 4, T26N, R11W
Set 2-1/2" x 30" flanged bottom galvanized pipe with 3-1/4" brass cap
stamped GRAND TRAVERSE COUNTY REMONUMENTATION.
S30°W 9.23' Power Pole
S12°W 53.23' 12" Red Pine
N28°E 37.57' 8" Ash
East 20.46' Grand Traverse Co. Monument at S.E. cor. of Sec. 33, T27N, R11W

Corner approved by the Grand Traverse County Peer Review Group on November 5, 1996.

Signed by *Garth D. Stowe*
Surveyor's Michigan License No. Garth D. Stowe 25875

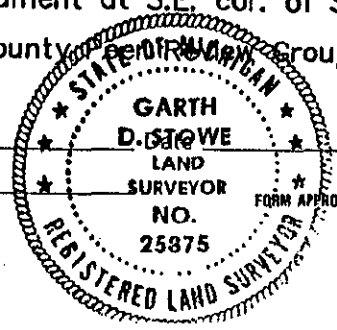

12-18-96