

**SURVEY & REMONUMENTATION**

LIBER 003 PAGE 770

APR 07 1998

**LAND CORNER RECORDATION CERTIFICATE**  
Filing Requirement of Act 74, Mich. P.A. 1970

For corners in SECTION

<u>Grand Traverse</u> (County)	Located In:	Corner Code #
1. Public Land Survey	T26N R11W	H-1
	T___ R___	_____
	T___ R___	_____
	T___ R___	_____
2. Property Controlling in Section	S___ T___ R___	_____
	S___ T___ R___	_____
3. Miscellaneous Property in Sec.	S___ T___ R___	_____
	S___ T___ R___	_____

STATE OF MICHIGAN  
GRAND TRAVERSE COUNTY  
RECORDED  
31 DEC 97 10:52 P.M.  
**COPY**  
KARON ANDERSON  
REGISTER OF DEEDS  
Register of Deeds Stamp & File Number

4. Lot No. \_\_\_\_\_, Recorded Plat \_\_\_\_\_  
5. Private Claims \_\_\_\_\_

I, Garth Stowe, in a field survey on October, 1997 do hereby state that under requirements of P.A. 74, Michigan P.A. of 1970, the corner points mentioned in lines 1 and 2 above were in conformance with regulations and rules therefore as required in the current manual of survey instructions of the United States Department of the Interior, Bureau of Land Management or by a decree of a Court of Law and/or that the corner points mentioned in lines 3, 4 and 5 above were in conformance with the rules of the Michigan Board of Land Surveyors or by a Decree of a Court of Law, established, re-established, monumented, recovered, found as expressed below:

	A	B	C	D	E	F	G	H	I	J	K	L	M
1													
2		6		5		4		3		2			1
3													
4		7		8		9		10		11			12
5													
6		18		17		16		15		14			13
7													
8		19		20		21		22		23			24
9													
10		30		29		28		27		26			25
11													
12		31		32		33		34		35			36
13													

**NOTE:** Not more than 2 corners, all in the same town and range, may be recorded on this certificate.

**A. Description of original monument and accessories and/or subsequent restoration:**

H-1: U.S. Gov't survey by Burt, 1839, post witnessed by elm 12 N55E 15, hemlock 10 N1W 15. Hodgeman, March 1880 set stake, bearing tree down. Tuller, May 1893, found N 1/4 corner by government field notes. Notes there are 2 corners, set on the one to the west being the correct one, ran south. Allyn found stake and stones 15.5 links west of 1/4 post in T27N R11W. Waterman, 1908, references 2 corners the west being the correct one. Waterman, 1915, states N 1/4 corner is iron stake and stone in place of old cedar post by Tuller. The east fence is the 1/4 post for section 34, T27N, R11W. Perla Stout Associates, 1967 find 1 1/2" I.P. Land corner by Korr find 1 1/2" iron pipe at S 1/4 corner section 34, T27N, R11W notes 1 1/2" iron pipe 10.31' west at N 1/4 corner section 3, T26N R11W.

**B. Description of corner evidence found and/or method applied in restoring or reestablishing corner:**

H-1: N 1/4 corner section 3, T26N, R11W  
Found 1 1/2" iron pipe as noted in Land Corner Record above. This corner is accepted as a careful and faithful perpetuation of the Tuller corner of 1893 and is monumented with a 2 1/2"x30" flanged bottom galvanized pipe with a 3 1/4" brass cap stamped GRAND TRAVERSE COUNTY REMONUMENTATION.

**C. Description of monument for corner and accessories established to perpetuate locating the position of the corner:**

H-1: North 1/4 corner section 3, T26N R11W  
Set 2 1/2"x30" flanged bottom galvanized pipe with a 3 1/4" brass cap stamped GRAND TRAVERSE COUNTY REMONUMENTATION.

S 08° W 36.85' 3- 14" Maples  
East 12.53' 8" Basswood  
N 25° W 7.11' 6" Basswood  
S 85° W 42.06' 12" Basswood

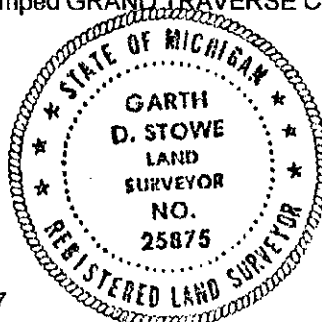

Corner approved by Grand Traverse County Peer Review Group 10-22-97

Signed by Garth D. Stowe Date 12-19-97  
Surveyor's Michigan License No. 25875

UNANIMOUSLY ACCEPTED BY THE GRAND TRAVERSE COUNTY PEER REVIEW GROUP AS THE OFFICIAL CORNER UNDER MICHIGAN PUBLIC ACT 345 OF 1990 AT A MEETING HELD ON 10-22-97  
Robert F. Mitchell  
ROBERT F. MITCHELL, P.S., CHAIRMAN