

MAY 22 2000

003 069

236

SECTION

LAND CORNER RECORDATION CERTIFICATE
Filing Requirement of Act 74, Mich. P.A. 1970

For corners in

STATE OF MICHIGAN
GRAND TRAVERSE COUNTY
RECORDED

29 DEC 95 10:00 A.M.

KARON ANDERSON
REGISTER OF DEEDS

Grand Traverse
(County)

Located In: Corner Code #

1. Public Land Survey

T 26 N R 11 W A - 05
T 26N R 12W M-05 ✓

G.T. Corner Code 95-29

I, Corey J. Hughes, in a field survey performed in June 1995, do hereby certify that under requirements of P.A. 74, Michigan P.A. of 1970, the corner point mentioned in lines 1 and 2 above was in conformance with regulations and rules therefore as required in the current manual of survey instructions of the United States Department of the Interior, Bureau of Land Management or by a decree of a Court of Law and /or that the corner points mentioned in lines 3, 4 and 5 above were in conformance with the rules of the Michigan Board of Land Surveyors or by a Decree of a Court of Law; established, re-established, monumented, re-monumented, recovered, found as expressed below:

| | A | B | C | D | E | F | G | H | I | J | K | L | M |
|----|----|----|----|----|----|----|---|---|---|---|---|---|---|
| 2 | 6 | 5 | 4 | 3 | 2 | 1 | | | | | | | |
| 3 | | | | | | | | | | | | | |
| 4 | 7 | 8 | 9 | 10 | 11 | 12 | | | | | | | |
| 5 | | | | | | | | | | | | | |
| 6 | 18 | 17 | 16 | 15 | 14 | 13 | | | | | | | |
| 7 | | | | | | | | | | | | | |
| 8 | 19 | 20 | 21 | 22 | 23 | 24 | | | | | | | |
| 9 | | | | | | | | | | | | | |
| 10 | 30 | 29 | 28 | 27 | 26 | 25 | | | | | | | |
| 11 | | | | | | | | | | | | | |
| 12 | 31 | 32 | 33 | 34 | 35 | 36 | | | | | | | |
| 13 | | | | | | | | | | | | | |

A. Description of original monument and accessories and/or subsequent restoration:
A-05 & M-05

1839 GLO set post and witnesses - 13" Hemlock N83°W 12 and 12" Beech S06°W 45.

(L 10 Pg 286) used SW sec cor and found stone.

1951 survey in L13 Pg 186 used corner in center of intersections.

Act 74 (L1 Pg 747) found T iron in monument box.

B. Description of corner evidence found and/or method applied in restoring or reestablishing corner:

A-05 & M-05

Found 1" x 46" pipe 20" down raised with T iron.

UNANIMOUSLY ACCEPTED BY THE
GRAND TRAVERSE COUNTY PEER
REVIEW GROUP AS THE OFFICIAL
CORNER UNDER MICHIGAN PUBLIC
ACT 345 OF 1990 AT A MEETING
HELD ON 11-20-95

Rfm
ROBERT F. MITCHELL, P.S., Chairman

C. Description of monument for corner and accessories established to perpetuate locating the position of the corner:

A-05 & M-05

Set G.T. Remon monument and pavement box.

Witnesses Nail in 26" Maple N35°W - 55.32'
Nail in 30" Maple S40°W - 60.08'
P.K. in power pole N45°E - 79.38'
P.K. in power pole S46°E - 83.36'

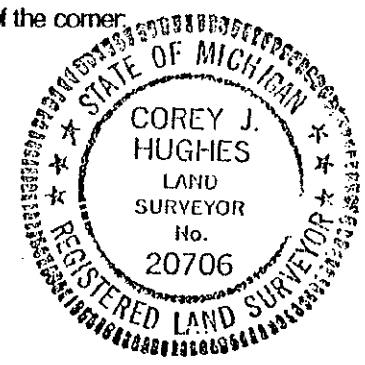

Corner approved by the Grand Traverse County Peer Review Group on 28 November 1995

Signed by Corey J. Hughes Date 12/26/95

Corey J. Hughes Michigan P.S. license No. 20706

3-669