

MICHIGAN
DEPARTMENT OF CONSERVATION
FORESTRY DIVISION

LAND CORNER RECORD

T. 27 N.R. 9 W

GRAND TRAVERSE COUNTY

DESCRIPTION OF CORNER SECTION CORNER COMMON TO SECTIONS 29-30-31-32

CORNER MONUMENT SET CONS. DEPT. MONUMENT

DATE MONUMENT PLACED AND WITNESSED 6/21/68

WITNESSES TO CORNER.....

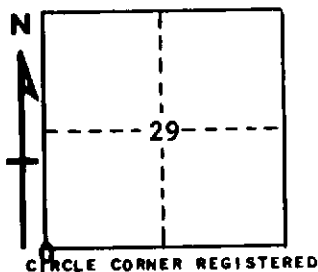

7" W. OAK N 18 W 11.5'

6" W. OAK S 63 E 33.6'

AND

7" W. OAK S 14 W 16.4'

DESCRIPTION IN DETAIL AS TO HOW CORNER WAS LOCATED AND IDENTIFIED OR RESTORED.

This corner was found during a survey in this area. Found iron rod at corner, previously established by unknown. Stumps in place for both U.S.B.T. sites, and checks good for measurement to all physical features and adjacent corners.

SURVEYOR'S SEAL.

SIGNED

Kenneth B. Bething
REGISTERED LAND SURVEYOR #10068

DATE 6/28/68