

MICHIGAN
DEPARTMENT OF CONSERVATION
FORESTRY DIVISION

LAND CORNER RECORD

T. 27 N.R. 9 W

GRAND TRAVERSE COUNTY

DESCRIPTION OF CORNER 1/4 CORNER COMMON TO SECTIONS 32 & 33

CORNER MONUMENT Fd. 1/2" pipe from Schaaf pits. Replaced with Std. Dept. Mon.
below surface

DATE MONUMENT PLACED AND WITNESSED July 1968

WITNESSES TO CORNER.....

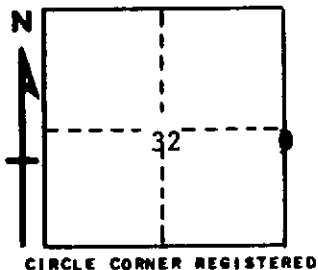

7" Oak	N 20 W	28.5'
8" Oak	N 40 E	47.4'
9" Oak	S 80 E	38.2'

AND

Cor. falls in approximate center of N-S Trail Road

DESCRIPTION IN DETAIL AS TO HOW CORNER WAS LOCATED AND IDENTIFIED OR RESTORED.

This corner is a perpetuation of a Schaaf Corner which was a restoration of a Govt. corner based on USBTs; SE with good face, about 1934.

Bill Batzer set a 1/4 corner not too long ago on the split of the mile, as he did not have knowledge of the Schaaf corner at the time. Batzer's corner fell 2.9' West and 20.8' South of the Schaaf corner.

Also there is a 5/8" rod 72.0' North and 1.2' West of the Schaaf corner. The 5/8" rod is in line with a "Posted" line to the West. I can find no record as to how this rod was placed.

SURVEYOR'S SEAL

SIGNED Carl F. Rosen DATE 9/16/68
REGISTERED LAND SURVEYOR #12028