

LAND CORNER RECORDATION CERTIFICATE
Filing Requirement of Act 74, Mich. P.A. 1970

STATE OF MICHIGAN
GRAND TRAVERSE COUNTY
RECORDED

30 DEC 99 3:37 P.M.

KARON ANDERSON
REGISTER OF DEEDS

For corners in

Grand Traverse Located In: T28N R10W Corner Code # I-10
(County)
1. Public Land Survey T R
T R
T R
2. Property Controlling S T R SURVEY & REMONUMENTATION
in Section S T R
3. Miscellaneous S T R
Property in Sec. S T R MAR 22 2000

Register of Deeds Stamp & File Number

SECTION

4. Lot No. _____, Recorded Plat _____
5. Private Claims _____

I, Garth Stowe, in a field survey on September 9, 1999 do hereby state that under requirements of P.A. 74, Michigan P.A. of 1970, the corner points mentioned in lines 1 and 2 above were in conformance with regulations and rules therefore as required in the current manual of survey instructions of the United States Department of the Interior, Bureau of Land Management or by decree of a Court of Law and for that the corner points mentioned in lines 3, 4 and 5 above were in conformance with the rules of the Michigan Board of Land Surveyors or by a Decree of a Court of Law; established, re-established, monumented, recovered, found as expressed below:

NOTE: Not more than 2 corners, all in the same town and range, may be recorded on this certificate.

A. Description of original monument and accessories and/or subsequent restoration:

I-10: 1/4 corner common to sections 26 & 27, T28N, R10W
1839, June; U.S. Govt. Survey by John Hodgson, D.S., Set post witnessed by beech 6" S40W 11 lks., Beech 6" N33E 9 lks.
1892, June; County Surveyors Records, L.1, P.208,209, and L.11, P. 276 C.P.Tuller; found the roots of the old witness and the old post in position set pit of cobble stones 2 1/2 ft. Deep Black granite 24x18x7with x on top 1/4 S on side with two side stones"
1908, April; County Surveyor Records, L.2 P. 314,315, and L.9, P.302 E.P. Waterman; "stone + on top"
1923; County Surveyors Records, L.6, P.327; "stone x"
1953; John C. Norton and Assoc. #5328, Iron set (doubled over 1/8 corner stones from north)
1978, October; Johnson & Stout, P.C. survey L.3, P.617 and LCRC L.2, P.403 Philip Stout, 3/4" iron pipe found witnessed by 24" maple south 26.77', 20" maple S80W 19.86'
1981, September; LCRC L.2, P.467 Philip R. Stout 3/4" iron pipe found witnessed by 24" maple south 26.77', 20" maple S80W 19.86'
1983, July; Gourdie/Fraser survey # 831076, found iron witnessed by 18" maple South 26.8', 18" maple S80W 19.82', 8" oak S80E 50.15'
1988, March; Gosling Czubak survey L.4, P.499, and LCRC L.3, P.105 John F. Korr, found 3/4" iron pipe with cap # 13030 witnessed by stone pile west 6', 18" maple S07W 26.78', 8" maple S80E 30.19', 20" maple S85W 19.86'

B. Description of corner evidence found and/or method applied in restoring or reestablishing corner:

I-10: 1/4 corner common to sections 26 & 27, T28N, R10W
Found 7" x 18" x 24" black granite stone with 'x' on top and '1/4 S' on side. Accepted as a careful and faithful perpetuation of the original corner.

C. Description of monument for corner and accessories established to perpetuate locating the position of the corner:

I-10: 1/4 corner common to sections 26 & 27, T28N, R10W
Set 2 1/2" x 30" flanged bottom galvanized iron pipe with a 3-1/4" brass cap stamped GRAND TRAVERSE COUNTY
REMONUMENTATION.
Found spike in 22" Maple N85W 21.80'
Found spike in 20" Maple S10W 23.72'
Found spike in 18" Oak S85E 27.60'
Set spike in 24" Maple S80W 17.50'
Found 3/4" iron pipe with cap and iron #13030 stuck in pipe N45W 3.88'

Corner approved by Grand Traverse County Peer Review Group,

Signed by Garth D. Stowe
Michigan License No. 25875

Date 12-20-99 Surveyor's

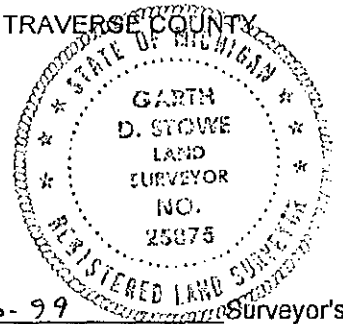

UNANIMOUSLY ACCEPTED BY THE
GRAND TRAVERSE COUNTY PEER
REVIEW GROUP AS THE OFFICIAL
CORNER UNDER MICHIGAN PUBLIC
ACT 345 OF 1990 AT A MEETING
HELD ON 12/22/99