

**LAND CORNER RECORDATION CERTIFICATE**  
**Filing Requirement of Act 74, Mich. P.A. 1970**

For corners in

<u>Houghton</u>	Located In:	Corner Code #
(County)		
1. Public Land Survey	T <u>51N</u> R <u>35W</u>	<u>G8</u>
	T _____ R _____	_____
	T _____ R _____	_____
	T _____ R _____	_____
2. Property Controlling in Section	S _____ T _____ R _____	_____
	S _____ T _____ R _____	_____
3. Miscellaneous Property in Sec.	S _____ T _____ R _____	_____
	S _____ T _____ R _____	_____

Register of Deeds Stamp & File Number

4. Lot No. \_\_\_\_\_, Recorded Plat \_\_\_\_\_  
 5. Private Claims \_\_\_\_\_

Feb 11 1999

I, Stephan J. Szyszkoski, in a field survey on \_\_\_\_\_, 19\_\_\_\_ do hereby state that under requirements of P.A. 74, Michigan P.A. of 1970, the corner points mentioned in lines 1 and 2 above were in conformance with regulations and rules therefore as required in the current manual of survey instructions of the United States Department of the Interior, Bureau of Land Management or by a decree of a Court of Law and/or that the corner points mentioned in lines 3, 4 and 5 above were in conformance with the rules of the Michigan Board of Land Surveyors or by a Decree of a Court of Law; established, re-established, monumented, recovered, found as expressed below:

**NOTE:** Not more than 2 corners, all in the same town and range, may be recorded on this certificate.

A	B	C	D	E	F	G	H	I	J	K	L	M
1												
2	6		5		4		3		2		1	
3												
4	7		8		9		10		11		12	
5												
6	18		17		16		15		14		13	
7												
8	19		20		21	●	22		23		24	
9												
10	30		29		28		27		26		25	
11												
12	31		32		33		34		35		36	
13												

A. Description of original monument and accessories and/or subsequent restoration:  
 (G8) Quarter corner common to Sections 21 and 22. Corner established in 1848 by Sylvester Higgins: "North between Sections 21 & 22...40.00 Set 1/4 Section post. Sugar 12 S56W 10, do 12 N65E 22". Found no subsequent record.

B. Description of corner evidence found and/or method applied in restoring or reestablishing corner:

(G8) Original post and accessories apparently destroyed by road construction. Reestablished the corner in line with old fences east and west and midway between old R/W fences 25.0' east and west. The centerline of Tauriainen Rd. is about 1 ft. east of this position. From the corner position, found a 1 1/2" iron pipe, S80E 18.3', off of the road surface, apparently placed as an approximate corner by former land owner Mr. Sander Tauriainen. Distances north and south to monumented Section corners were found to be 2626.81' and 2635.65', respectively. Placed a 3/4"x18" concrete forming pin at the corner position Feb.11 1999, and drove over the top of it on Apr.13 1999 a 1" ID x 32" iron pipe capped with a 4" dia. cast aluminum MDNR tablet, appropriately stamped.

C. Description of monument for corner and accessories established to perpetuate locating the position of the corner:

(G8) Set 1" pipe with 4" MDNR cap driven to 6" below gravel surface. Blazed and scribed the following trees:  
 9" Maple N69E 36.3' "1/4S NBT"  
 8" Spruce S51W 46.15' do  
 4" twin Sugar Plum NB0W 32.45' do  
 Power pole S13E 62.9' PK nail/washer  
 Bearings are magnetic. Distances are horizontal and are to notch in lower blazes of trees.

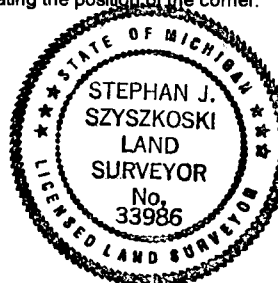

Signed by Stephan J. Szyszkoski  
 Surveyor's Michigan License No. 33986

Date 8/26/99

For the Michigan Department of Natural Resources - Forest Management Division