

LAND CORNER RECORDATION CERTIFICATE
Filing Requirement of Act 74, Mich. P.A. 1970

For corners in

Houghton

(County)

Located In:

Corner Code #

1. Public Land Survey

T ___ R ___
 T ___ R ___
 T ___ R ___
 T ___ R ___

2. Property Controlling in Section

S 35 T S2N R 35W 9
 S 35 T S2N R 35W 6

3. Miscellaneous Property in Sec.

S ___ T ___ R ___
 S ___ T ___ R ___

Register of Deeds Stamp & File Number

4. Lot No. _____, Recorded Plat _____
 5. Private Claims _____

6 Dec 19 2001
 9 Dec 12 2001

I, Stephan J. Szyszkoski, in a field survey on _____, 19____ do hereby state that under requirements of P.A. 74, Michigan P.A. of 1970, the corner points mentioned in lines 1 and 2 above were in conformance with regulations and rules therefore as required in the current manual of survey instructions of the United States Department of the Interior, Bureau of Land Management or by a decree of a Court of Law and /or that the corner points mentioned in lines 3, 4 and 5 above were in conformance with the rules of the Michigan Board of Land Surveyors or by a Decree of a Court of Law; established, re-established, monumented, recovered, found as expressed below:

NOTE: Not more than 2 corners, all in the same town and range, may be recorded on this certificate.

A	B	C	D	E	F	G	H	I	J	K	L	M
1												
2	6	5	4	3	2	1						
3												
4	7	8	9	10	11	12						
5												
6	10	17	16	15	14	13						
7												
8	19	20	21	22	23	24						
9												
10	30	29	28	27	26	25						
11												
12	31	32	33	34	35	36						
13												

A. Description of original monument and accessories and/or subsequent restoration:
 (9-Sec. 35) East 1/16 corner Sec. 35. Established in 1978 by K.L. Sackett. 1" IDx36" iron pipe with 4" aluminum cap. 6" Sugar N53W 16.5', 5" Sugar S37E 15.5', 4" Y.Birch N48E 13.1', 12" Sq'd Y.Birch West 1.4'.
 (6-Sec. 35) Northeast 1/16 corner, Sec. 35. Not established in the original survey.

B. Description of corner evidence found and/or method applied in restoring or reestablishing corner:
 (9-Sec. 35) Recovered the 1978 monument as described, in good condition, and at record bearing and distance from the remains of the 1978 witnesses as follows: 5" Y. Birch N50E 13.1' "1/16S BT", 14" Squared Y.Birch S81W 1.4' to center of tree. The two Sugar BTs are rotten stumps at record bearing and distance. Left the monument in place and made two new witnesses as described below.
 (6-Sec. 35) Established the corner at the intersection of straight lines connecting opposite 1/16 corners.

C. Description of monument for corner and accessories established to perpetuate locating the position of the corner:
 (9) Found 1" ID iron pipe with 4" aluminum MDNR cap. Blazed and scribed:
 10" Y.Birch S15E 41.6' "1/16S BT"
 10" Y.Birch N72W 28.5' do
 Bearings are magnetic. Distances to notch in lower blaze.
 (6) Set 1" IDx32" iron pipe with 4" alum. MDNR cap. Blazed and scribed:
 6" Sugar N65E 22.2' "1/16S BT"
 8" Y.Birch S28E 14.9' do
 9" Hemlock (s'ly of two) S58W 27.5' do
 8" Sugar N55W 14.8' do
 3" Y.Birch squared N70W 0.9' to center. Squared sugar post adjacent. Brgs. are magnetic. Distances are to notch in lower blaze.

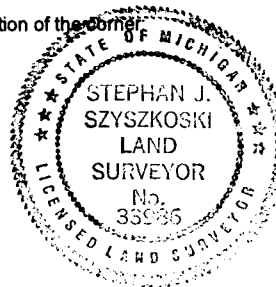

Signed by Stephan J. Szyszkoski Date 2/27/02
 Surveyor's Michigan License No. 33986