

LAND CORNER RECORDATION CERTIFICATE
Filing Requirement of Act 74, Mich. P.A. 1970

For corners in _____

Houghton

(County)

Located In: _____

Corner Code # _____

1. Public Land Survey

T 52N R 35W

I12

T 52N R 35W

I11

T _____ R _____

T _____ R _____

2. Property Controlling in Section

S _____

T _____ R _____

S _____

T _____ R _____

3. Miscellaneous Property in Sec.

S _____

T _____ R _____

S _____

T _____ R _____

Register of Deeds Stamp & File Number

4. Lot No. _____, Recorded Plat _____
 5. Private Claims _____

Dec 12 2001

I, Stephan J. Szyszkoski, in a field survey on _____, 19____ do hereby state that under requirements of P.A. 74, Michigan P.A. of 1970, the corner points mentioned in lines 1 and 2 above were in conformance with regulations and rules therefore as required in the current manual of survey instructions of the United States Department of the Interior, Bureau of Land Management or by a decree of a Court of Law and/or that the corner points mentioned in lines 3, 4 and 5 above were in conformance with the rules of the Michigan Board of Land Surveyors or by a Decree of a Court of Law, established, re-established, monumented, recovered, found as expressed below:

NOTE: Not more than 2 corners, all in the same town and range, may be recorded on this certificate.

A	B	C	D	E	F	G	H	I	J	K	L	M
1												
2	6	5	4	3	2	1						
3												
4	7	8	9	10	11	12						
5												
6	18	17	16	15	14	13						
7												
8	19	20	21	22	23	24						
9												
10	30	29	28	27	26	25						
11												
12	31	32	33	34	35	36						
13												

A. Description of original monument and accessories and/or subsequent restoration:

(I12) Quarter corner common to Sections 34 and 35. Remonumented in 1962 by Billy D. Buckler, RLS. 1" iron pipe with 4" aluminum cap. 18" Cedar N81E 33 links, 9" Soft Maple N33W 93 links.

(I11) Corner common to Sections 26-27-34-35. Remonumented in 1953 by Billy D. Buckler. 1" Iron pipe with 4" brass cap. 9" Cedar N12W 55 links, 8" Cedar S81W 18 links.

B. Description of corner evidence found and/or method applied in restoring or reestablishing corner:

(I12) Recovered the 1962 monument as described, in good condition, and at record bearing and distance from the 1962 accessories recovered as follows: 16" Cedar N85E 21.8' to rotted face, 12" Maple N30W 61.4' with overgrown blazes. Left the monument in place and made two new BTs as described below.

(I11) Recovered the 1953 monument as described, in good condition, and at record bearing and distance from the 1953 accessories recovered as follows: 12" Cedar N8W 36.3' over grown blazes, 8" Cedar S85W 11.9' face evident but rotting. Left the monument in place and made two new BTs as described below.

C. Description of monument for corner and accessories established to perpetuate locating the position of the corner:

(I12) Found 1" ID iron pipe with 4" alum. Michigan Dept. of Conservation cap. Blazed and scribed: 7" dbl Y. Birch S18E 12.1' "1/4S NBT" 9" Maple S67W 38.5' do Squared cedar post adjacent. Bearings are magnetic. Distances are to notch in lower blaze.

(I11) Found 1" pipe with 4" brass MI Dept. of Conservation cap. Blazed and scribed: 7" Cedar N72E 12.5' "S26 NBT" 5" Cedar S21E 18.5' "S35 NBT" Squared cedar post adjacent. Bearings are magnetic. Distances are to notch in lower blaze.

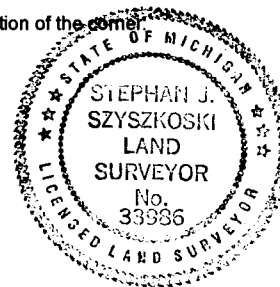

Signed by Stephan J. Szyszkoski
 Surveyor's Michigan License No. 33986

Date 2/27/02