

LAND CORNER RECORDATION CERTIFICATE
Filing Requirement of Act 74, Mich. P.A. 1970

For corners in

Houghton

(County)

Located in:

Corner Code #

- | | | | |
|---------------------------------------|------|-------------|-------|
| 1. Public Land Survey | T | R | _____ |
| | T | R | _____ |
| | T | R | _____ |
| | T | R | _____ |
| 2. Property Controlling
in Section | S 21 | T 52N R 36W | 9 |
| | S | T R | _____ |
| 3. Miscellaneous
Property in Sec. | S | T R | _____ |
| | S | T R | _____ |

Register of Deeds Stamp & File Number

4. Lot No. _____, Recorded Plat _____
 5. Private Claims _____

Jun 26 2002

I, Stephan J. Szyszkoski, in a field survey on _____, 20____ do hereby state that under requirements of P.A. 74, Michigan P.A. of 1970, the corner points mentioned in lines 1 and 2 above were in conformance with regulations and rules therefore as required in the current manual of survey instructions of the United States Department of the Interior, Bureau of Land Management or by a decree of a Court of Law and /or that the corner points mentioned in lines 3, 4 and 5 above were in conformance with the rules of the Michigan Board of Land Surveyors or by a Decree of a Court of Law; established, re-established, monumented, recovered, found as expressed below:

NOTE: Not more than 2 corners, all in the same town and range, may be recorded on this certificate.

A	B	C	D	E	F	G	H	I	J	K	L	M
1												
2	6		5		4		3		2		1	
3												
4	7		8		9		10		11		12	
5												
6	18		17		16		15		14		13	
7												
8	19		20		21		22		23		24	
9												
10	30		29		28		27		26		25	
11												
12	31		32		33		34		35		36	
13												

A. Description of original monument and accessories and/or subsequent restoration:
 (9-Sec. 21) East 1/16 corner, Section 21. Not established in the original survey. Found no subsequent record.

B. Description of corner evidence found and/or method applied in restoring or reestablishing corner:

(9-Sec. 21) Established the corner midway and on a straight line between Center of Section 1480.35' west and 1/4 corner 1480.35' east. The corner falls 1.5' SW of the rear (SW'ly-most) wall of the Wyandotte Hills Golf Course Clubhouse, 19.3' SE of the building corner at the NW end of the rear wall, and 19.2' NW of the corner at the SE end of the wall. It is 0.9' NW of the NW'ly edge of a roofed treated-wood deck. Sometime prior to July 19, 2002, an unroofed addition to this deck was installed on its NW end, making the combined deck 26.3' long. The corner monument is now obscured from view under the deck addition.

C. Description of monument for corner and accessories established to perpetuate locating the position of the corner:

(9) Set 1"IDx32" I.pipe with 4" alum. MDNR cap. See above for references to building for witnesses. See sketch on the other side of this form.

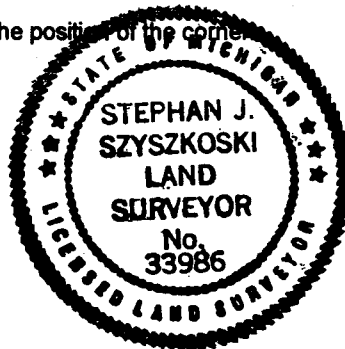

Signed by Stephan J. Szyszkoski
 Surveyor's Michigan License No. 33986

Date 7/17/02

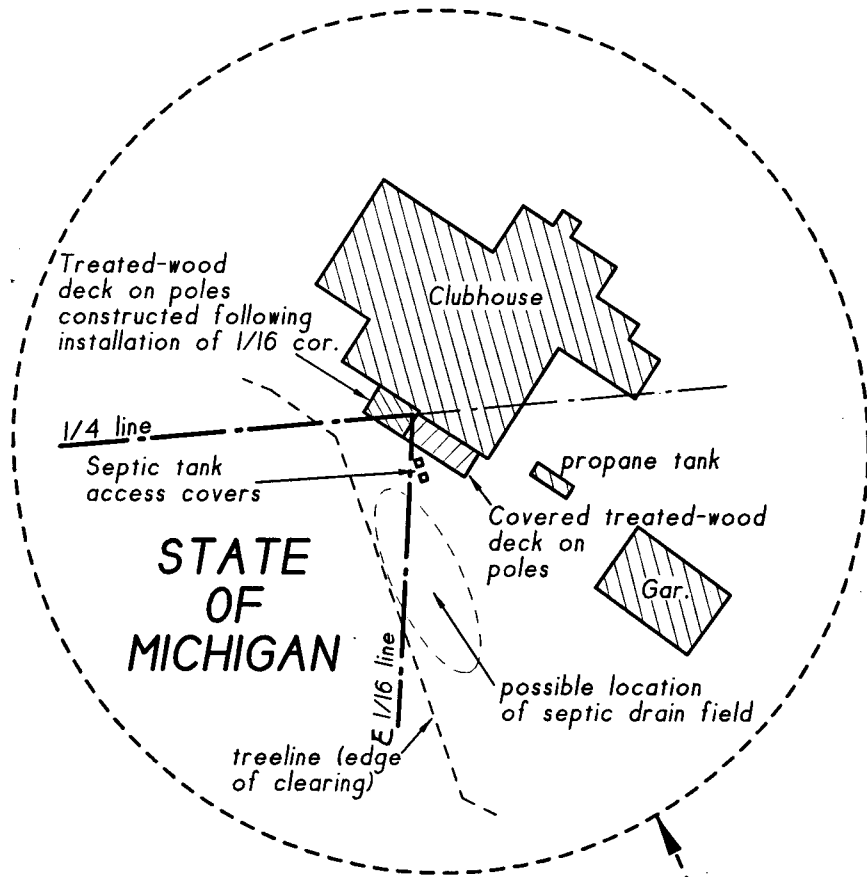

ENCROACHMENT DETAIL #1

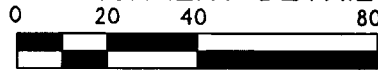

All Dimensions Are in Int'l Feet.

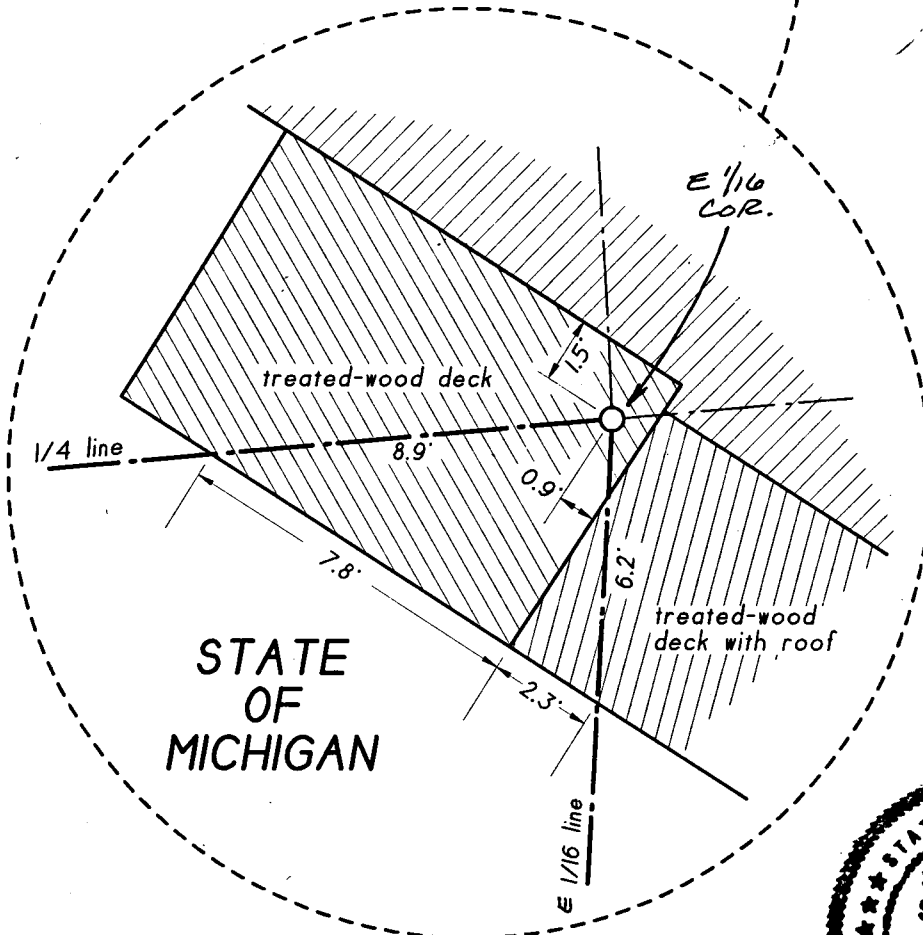

ENCROACHMENT DETAIL #2

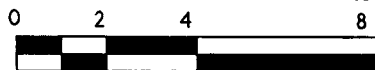

All Dimensions Are in Int'l Feet

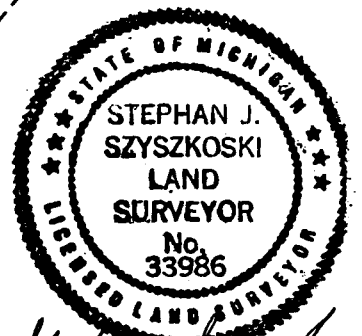

Stephan J. Szyszkoski