

LAND CORNER RECORDATION CERTIFICATE
Filing Requirement of Act 74, Mich. P.A. 1970

For corners in

<u>Houghton</u> (County)	Located In:	Corner Code #
1. Public Land Survey	T <u>52N</u> R <u>36W</u>	<u>E9</u>
	T <u> </u> R <u> </u>	<u> </u>
	T <u> </u> R <u> </u>	<u> </u>
	T <u> </u> R <u> </u>	<u> </u>
2. Property Controlling in Section	S <u> </u> T <u> </u> R <u> </u>	<u> </u>
	S <u> </u> T <u> </u> R <u> </u>	<u> </u>
3. Miscellaneous Property in Sec.	S <u> </u> T <u> </u> R <u> </u>	<u> </u>
	S <u> </u> T <u> </u> R <u> </u>	<u> </u>

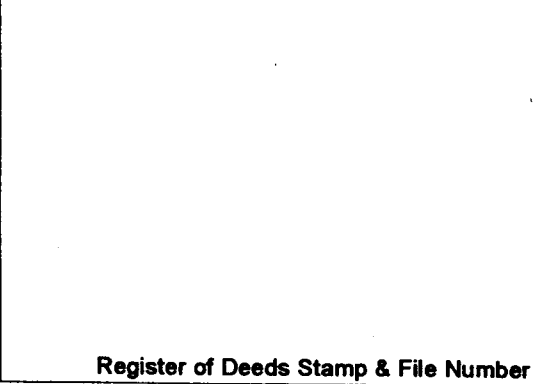

4. Lot No. _____, Recorded Plat _____
 5. Private Claims _____

Jun 25 2002

I, Stephan J. Szyszkoski, in a field survey on _____, 20__ do hereby state that under requirements of P.A. 74, Michigan P.A. of 1970, the corner points mentioned in lines 1 and 2 above were in conformance with regulations and rules therefore as required in the current manual of survey instructions of the United States Department of the Interior, Bureau of Land Management or by a decree of a Court of Law and /or that the corner points mentioned in lines 3, 4 and 5 above were in conformance with the rules of the Michigan Board of Land Surveyors or by a Decree of a Court of Law; established, re-established, monumented, recovered, found as expressed below:

NOTE: Not more than 2 corners, all in the same town and range, may be recorded on this certificate.

1	A	B	C	D	E	F	G	H	I	J	K	L	M
2		6		5		4		3		2		1	
3													
4		7		8		9		10		11		12	
5													
6		18		17		16		15		14		13	
7													
8		19		20		21		22		23		24	
9													
10		30		29		28		27		26		25	
11													
12		31		32		33		34		35		36	
13													

A. Description of original monument and accessories and/or subsequent restoration:

(E9) Corner common to Sections 20-21-28-29. 1846: Established by S.W.Higgins: " North...80.00 Set post...Lynn 14 S65W 24, Hemlock 12 N20E 26. East random between 21 & 28 0.50 Circular Tam'k marsh. 5.50 Leave do...28.50 Stream 1 N." The original record to adjacent 1/4 corners NSEW is: 40.00, 40.00, 39.99, 40.02 chains, respectively.

B. Description of corner evidence found and/or method applied in restoring or reestablishing corner:

(E9) The original post and accessories were not recovered. Found a 1 5/8" dia. Iron pipe with mushroomed top, projecting about 12" a.g. Using digital aerial orthophotographs, line calls noted above, east of the corner, check approximately with the record. This monument was used to established the E1/16 between 16 & 21 by an unknwn surveyor: I found a 1.5" I.pipe at that 16th on a good line through pipes at D9 and E9 and 1.0' W. of the midpoint. Distances to adjacent 1/4 corners NSEW are 2512.3', 2587.5, 2683.3', 2685.3', respectively. Accepted the pipe as the best available evidence of the position of the original corner.

C. Description of monument for corner and accessories established to perpetuate locating the position of the corner:

(E9) Found 1 5/8" dia. iron pipe.
 Blazed and scribed:
 8" B.Ash N48E 20.7' "S21 N8T"
 10" Hemlock S27E 41.7' "S28 N8T"
 14" Sugar S52W 32.4' "S29 N8T"
 10" Y.Birch N10W 14.3' "S20 N8T"
 Set sq'd spruce post adjacent. Bearings are magnetic. Distances are to notch in lower blaze.

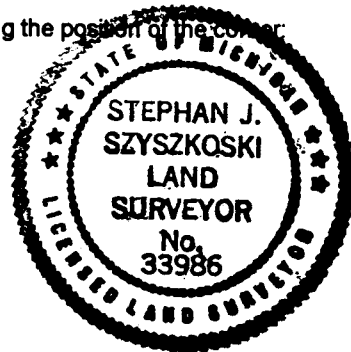

Signed by Stephan J. Szyszkoski
 Surveyor's Michigan License No. 33986

Date 7/17/02