

LAND CORNER RECORDATION CERTIFICATE
Filing Requirement of Act 74, Mich. P.A. 1970

For corners in

<u>Houghton</u> (County)	Located In:	Corner Code #
1. Public Land Survey	T <u>52N</u> R <u>36W</u>	<u>C8</u>
	T _____ R _____	_____
	T _____ R _____	_____
	T _____ R _____	_____
2. Property Controlling in Section	S _____ T _____ R _____	_____
	S _____ T _____ R _____	_____
3. Miscellaneous Property in Sec.	S _____ T _____ R _____	_____
	S _____ T _____ R _____	_____

Register of Deeds Stamp & File Number

4. Lot No. _____, Recorded Plat _____
 5. Private Claims _____

May 19 2003

I, Stephan J. Szyszkoski, in a field survey on _____, 20____ do hereby state that under requirements of P.A. 74, Michigan P.A. of 1970, the corner points mentioned in lines 1 and 2 above were in conformance with regulations and rules therefore as required in the current manual of survey instructions of the United States Department of the Interior, Bureau of Land Management or by a decree of a Court of Law and /or that the corner points mentioned in lines 3, 4 and 5 above were in conformance with the rules of the Michigan Board of Land Surveyors or by a Decree of a Court of Law; established, re-established, monumented, recovered, found as expressed below:

NOTE: Not more than 2 corners, all in the same town and range, may be recorded on this certificate.

A	B	C	D	E	F	G	H	I	J	K	L	M
1												
2	6	5	4	3	2	1						
3												
4	7	8	9	10	11	12						
5												
6	16	17	16	15	14	13						
7												
8	19	20	21	22	23	24						
9												
10	30	29	28	27	26	25						
11												
12	31	32	33	34	35	36						
13												

A. Description of original monument and accessories and/or subsequent restoration:
 (C8) Quarter corner common to Sections 19-20. 1846: Established by S.W.Higgins: North between 19 & 20...40.00 Set 1/4 Sec post. Sugar 12 S85W 16, Sugar 20 N30E 45. ...80.00 Set post corner of Sec. 17,18,19,20.

B. Description of corner evidence found and/or method applied in restoring or reestablishing corner:

(C8) The original post and accessories were not recovered. Reestablished the corner midway and on a straight line between Section corners 2639.83' North and South.

C. Description of monument for corner and accessories established to perpetuate locating the position of the corner:

(C8) Set 1"IDx32" I.pipe with 4" alum. MDNR cap. Blazed, scribed, and set measuring nails in:
 3" Pin Cherry S37E 9.7' "1/4S NBT"
 5" W.Ash S74W 55.6' do
 7" W.Ash N47W 33.0' do
 5" Oak N11E 41.4' do
 Set squared cedar post adjacent.
 Bearings are magnetic. Distances are to nail with tag.

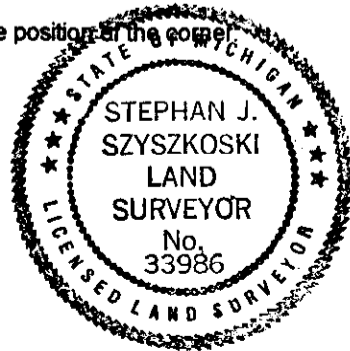

Signed by Stephan J. Szyszkoski
 Surveyor's Michigan License No. 33986

Date 7/14/2003