

LAND CORNER RECORDATION CERTIFICATE
Filing Requirement of Act 74, Mich. P.A. 1970 as Amended

For corners in

<u>Houghton</u> (County)	Located In:	Corner Code #
1. Public Land Survey	T <u>52N</u> R <u>36W</u>	<u>K1</u>
	T _____ R _____	_____
	T _____ R _____	_____
2. Property Controlling in Section	S _____ T _____ R _____	_____
	S _____ T _____ R _____	_____
3. Miscellaneous Property in Sec.	S _____ T _____ R _____	_____
	S _____ T _____ R _____	_____

Register of Deeds Stamp & File Number

4. Lot No. _____, Recorded Plat _____
 5. Private Claims _____

Jun 14 2007

I, Stephan J. Szyszkoski, in a field survey on _____, 20____ do hereby state that under requirements of P.A. 74, Michigan P.A. of 1970, the corner points mentioned in lines 1 and 2 above were in conformance with regulations and rules therefore as required in the current manual of survey instructions of the United States Department of the Interior, Bureau of Land Management or by a decree of a Court of Law and /or that the corner points mentioned in lines 3, 4 and 5 above were in conformance with the rules of the Michigan Board of Land Surveyors or by a Decree of a Court of Law; established, re-established, monumented, recovered, found as expressed below:

NOTE: Not more than 2 corners, all in the same town and range, may be recorded on this certificate.

A. Description of original monument and accessories and/or subsequent restoration:

(K1) Closing section corner between Sections 1 and 2. 1846 - Established by S.W.Higgins, Deputy Surveyor at the intersection of the line between Sections 1 and 2 with the Township line, 13 links east of Standard Section corner common to 35-36 T53N-R36W. 1944 - W.A.Waara, Copper Range Co., erroneously noted this corner as common to T53N-R36W: Found 2" I.P. for Cor. in a flat stand of hwd. 2nd gro. Put Y. tag on 4" bir. S23E 15 ft. Put W.A.W. mark on 7" r. map. N53E 11 ft. Found another I.P. S82E 9 ft. Found 28" bir. B.T. N78W 19 ft. Found old sq. off 16" s. map. S12W 7 ft. 1964 - Billy D. Buckler RLS states: This corner was rewitnessed as found by Copper Range Co. Yellow Birch 10" N80W 28 links B.T. still growing. Faces visible. 1 1/2" iron pipe. 11" Elm N41W 61 links, 8" H.Maple S33E 32 links, 1.5" Iron Pipe S85E 13 links.

B. Description of corner evidence found and/or method applied in restoring or reestablishing corner:

(K1) The original post and accessories were not recovered. Found a 1.5" I.D. Iron pipe, projecting 2 ft. above ground bent over by a fallen tree, from which a second 1.5" I.D. Iron pipe at the Standard Section corner for Sections 35 and 36 T53N-R36W, bears N84 1/2W (true brg.) 8.55' distant. The pipe at the Standard Corner was wrongly noted in the Buckler record as being common to four sections. None of the record witnesses were recovered. I accept the easterly 1.5" I.D. pipe as the best available evidence of the position of the original Closing Corner. Removed, straightened, and reset the pipe in the position found.

C. Description of monument for corner and accessories established to perpetuate locating the position of the corner:

(K1) Fd. 1.5" I.D. I.pipe. Set measuring nails in:
 12" Sugar N08W 32.05' mrkd "S36 N8T"
 11" Sugar East 19.85' do
 11" Y.Birch S15W 12.55' "S2 N8T"
 10" Sugar S88W 15.9' do
 Bearings are magnetic. Dist. are to nail with MDNR tag. Fd. 1.5" I.D. I.pipe N84W 8.55' at Standard Corner.

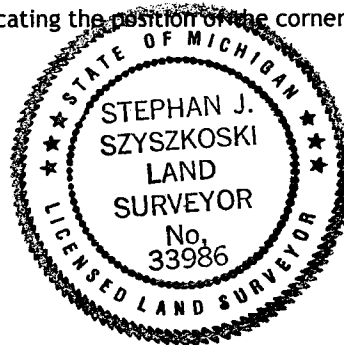

Signed by Stephan J. Szyszkoski
 Surveyor's Michigan License No. 33986

Date 7/18/07

For the Michigan Department of Natural Resources, Office of Land and Facilities