

LAND CORNER RECORDATION CERTIFICATE
Filing Requirement of Act 74, Mich. P.A. 1970 as Amended

For corners in

<u>Houghton</u> (County)	Located In:	Corner Code #
1. Public Land Survey	T <u>52N</u> R <u>36W</u>	<u>K2</u>
	T <u>52N</u> R <u>36W</u>	<u>K3</u>
	T _____ R _____	_____
2. Property Controlling in Section	S _____ T _____ R _____	_____
	S _____ T _____ R _____	_____
3. Miscellaneous Property in Sec.	S _____ T _____ R _____	_____
	S _____ T _____ R _____	_____

Register of Deeds Stamp & File Number

4. Lot No. _____, Recorded Plat _____
 5. Private Claims

K3 Jun 18 2007
 K2 Jun 14 2007

I, Stephan J. Szyszkoski, in a field survey on _____, 20____ do hereby state that under requirements of P.A. 74, Michigan P.A. of 1970, the corner points mentioned in lines 1 and 2 above were in conformance with regulations and rules therefore as required in the current manual of survey instructions of the United States Department of the Interior, Bureau of Land Management or by a decree of a Court of Law and /or that the corner points mentioned in lines 3, 4 and 5 above were in conformance with the rules of the Michigan Board of Land Surveyors or by a Decree of a Court of Law; established, re-established, monumented, recovered, found as expressed below:

NOTE: Not more than 2 corners, all in the same town and range, may be recorded on this certificate.

A. Description of original monument and accessories and/or subsequent restoration:

(K2) Quarter corner common to Sections 1 and 2. 1846 - Established by S.W.Higgins, Deputy Surveyor. Set post 40.00 chains north of Section corner and 39.63 chains south of Closing corner. Sugar 10 S25W 11 links, Sugar 12 N50E 19 links. 1964 - Billy D. Buckler RLS found 1.5" ID I.pipe and re-witnessed. 18" H.Maple S88E 6 links, 8" S.Maple S69W 10 links.
 (K3) Corner common to Sections 1-2-11-12. 1846 - Established by S.W.Higgins, Deputy Surveyor. Set post. Sugar 14 N15E 24 links, Sugar 13 S30W 31 links. Found no subsequent record.

B. Description of corner evidence found and/or method applied in restoring or reestablishing corner:

(K2) Found a 1.5" ID I.pipe projecting 2.6' above ground, in good condition, and at record bearing and distance from the 1964 witnesses, both in good condition. The 1964 Maple SW was cut down to facilitate GPS observations at the corner. Observed the distances south and north to be 2697.79' to Section corner K3 and 2671.23' to Closing corner K1. The latitudinal position of the pipe is 0.8' north of the record position (prorated) but the pipe is located 50' east of a straight line between the corners. I accept the pipe as the best available evidence of the position of the original corner.
 (K3) Found a 1.5" ID I.pipe projecting 2.5' above ground, in good condition. Measured to adjacent corners, all monumented with similar material as follows: North 2697.79' (2640 GLO), East 5244.78' (5274.1 GLO), South 5341.85' (5280 GLO), West 5248.53' (5280 GLO). Accepted the pipe as the best available evidence of the position of the original corner.

C. Description of monument for corner and accessories established to perpetuate locating the position of the corner:

(K2) Found 1.5" ID I.pipe. Set measuring nails in:	(K3) Fd. 1.5" ID I.pipe. Set measuring nails in:
19" Sugar S82E 4.85' old marks vis. *	7" Sugar N28E 15.3' mrkd "S1 NBT"
17" Oak S18E 32.65' mrkd "1/4S NBT"	12" Maple S75E 7.2' "S12 NBT"
7" Sugar S39W 34.65' do	8" Sugar S23E 24.0' "S12 NBT"
4" Sugar N57W 16.45' do	7" Sugar S77W 4.5' "S11 NBT"
Bearings are magnetic. Distances are to nail with MDNR tag. * denotes 1964 NBT.	Bearings are magnetic. Distances are to nail with MDNR tag.

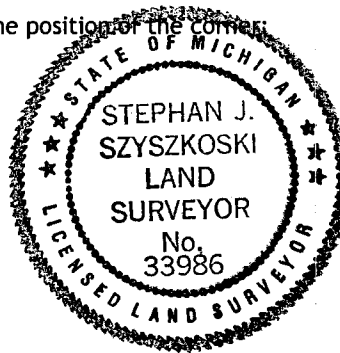

Signed by Stephan J. Szyszkoski
 Surveyor's Michigan License No. 33986

Date 7/18/07

For the Michigan Department of Natural Resources, Office of Land and Facilities