

LAND CORNER RECORDATION CERTIFICATE
Filing Requirement of Act 74, Mich. P.A. 1970 as Amended

For corners in

<u>Houghton</u> (County)	Located In:	Corner Code #
1. Public Land Survey	T <u>52N</u> R <u>36W</u>	<u>M1</u>
	T <u>52N</u> R <u>36W</u>	<u>L3</u>
	T _____ R _____	_____
2. Property Controlling in Section	S _____ T _____ R _____	_____
	S _____ T _____ R _____	_____
3. Miscellaneous Property in Sec.	S _____ T _____ R _____	_____
	S _____ T _____ R _____	_____

Register of Deeds Stamp & File Number

4. Lot No. _____, Recorded Plat _____
 5. Private Claims

L3 May 23 2007
 M1 Jun 18 2007

I, Stephan J. Szyszkoski, in a field survey on _____, 20____ do hereby state that under requirements of P.A. 74, Michigan P.A. of 1970, the corner points mentioned in lines 1 and 2 above were in conformance with regulations and rules therefore as required in the current manual of survey instructions of the United States Department of the Interior, Bureau of Land Management or by a decree of a Court of Law and /or that the corner points mentioned in lines 3, 4 and 5 above were in conformance with the rules of the Michigan Board of Land Surveyors or by a Decree of a Court of Law; established, re-established, monumented, recovered, found as expressed below:

	A	B	C	D	E	F	G	H	I	J	K	L	M
1													
2	6		5		4		3		2		1		
3													
4	7		8		9		10		11		12		
5													
6	18		17		16		15		14		13		
7													
8	19		20		21		22		23		24		
9													
10	30		29		28		27		26		25		
11													
12	31		32		33		34		35		36		
13													

NOTE: Not more than 2 corners, all in the same town and range, may be recorded on this certificate.

A. Description of original monument and accessories and/or subsequent restoration:

- (M1) Corner to Townships T52-53N, Ranges R35-36W. 1845 - Established by Wm.A.Burt, Deputy Surveyor. Set post 87 links north of temporary township corner. Spruce 10 N46E 15 links, Hemlock 12 S42W 27 links. 1932 - Notes of P.A.Larson say "1932 - B.T. Birch & I.P."
- (L3) Quarter corner common to Sections 1-12. 1846 - Established by S.W.Higgins, Deputy Surveyor: West corrected between Sec. 1 & 12 ...39.95 Set 1/4 Sec. post. Hemlock 12 S80W 25 links, Sugar 14 N20E 13 links. ...79.91 Sec. corner. Found no subsequent record.

B. Description of corner evidence found and/or method applied in restoring or reestablishing corner:

- (M1) The original post and accessories were not recovered. Found a 1" ID iron pipe in good condition, projecting 1.7' above ground with 1.5"ID x 4' tall iron pipe adjacent. Distances to adjacent monumented corners were measured and found to be: North 5286.29' (5280' GLO) to Section corner, West 5279.56' (5280' GLO to Standard Corner), South 5260.48' (5252.9' GLO to Section corner), East 5388.40' (5378.3' GLO to Standard Corner). I accepted the pipe as the best available evidence of the position of the original corner.
- (L3) The original post and accessories were not recovered. Found no evidence of the position of the original corner on the ground. Reestablished the corner by single proportionate measurement to the original record and on the line between Section corners 2622.71' west and 2622.06' east.

C. Description of monument for corner and accessories established to perpetuate locating the position of the corner:

- | | | |
|---|-----------------------------------|--|
| (M1) Fd. 1"ID I.pipe. Set measuring nails in: | 8" Sugar N79E 5.1' mrkd "S31 NBT" | (L3) Set 1"IDx32" I.pipe with 4" alum. MDNR cap. Set measuring nails in: |
| 7" Sugar S44E 16.7' | "S6 NBT" | 10" Maple S54E 17.3' mrkd "1/4S NBT" |
| 10" Sugar S17W 15.0' | "S1 NBT" | 10" Sugar S21W 13.6' do |
| 10" Sugar N40W 8.0' | "S36 NBT" | 7" Sugar N75W 21.8' do |
| Bearings are magnetic. Distances are to nail with MDNR tag. | | 7" Sugar N35W 14.1' do |
| | | Set sq'd hemlock post adjacent. |
| | | Bearings are magnetic. Distances are to nail with MDNR tag. |

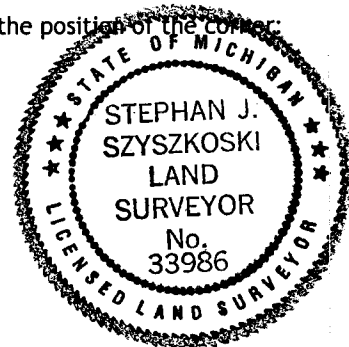

Signed by Stephan J. Szyszkoski
 Surveyor's Michigan License No. 33986

Date 7/18/07