

**SURVEY &  
 REMONUMENTATION**

SEP 17 1999

**LAND CORNER RECORDATION CERTIFICATE**  
 Filing Requirement of Act 74, Mich. P.A. 1970

**SECTION**

For corners in

Houghton Located In: 35 Corner Code #  
 (County)

- 1. Public Land Survey T 54N R 33W 11 K-11  
 T R  
 T R  
 T R
- 2. Property Controlling S T R  
 in Section S T R
- 3. Miscellaneous S T R  
 Property in Sec. S T R

MARY SCHOOS 05/19/99 2  
 HOUGHTON COUNTY, REGISTER 13:54  
 LC 3/ 603 PAU Fee: 9.00  
 Page 1 of 1

**Register of Deeds Stamp & File Number**

- 4. Lot No. \_\_\_\_\_, Recorded Plat \_\_\_\_\_
- 5. Private Claims \_\_\_\_\_

I, Robert A. Goodreau in a field survey on September, 1998 do hereby state that under requirements of P.A. 74, Michigan P.A. of 1970, the corner points mentioned in lines 1 and 2 above were in conformance with regulations and rules therefore as required in the current manual of survey instructions of the United States Department of the Interior, Bureau of Land Management or by a decree of a Court of Law and /or that the corner points mentioned in lines 3, 4 and 5 above were in conformance with the rules of the Michigan Board of Land Surveyors or by a Decree of a Court of Law; established, re-established, monumented, recovered, found as expressed below:

**NOTE: Not more than 2 corners, all in the same town and range, may be recorded on this certificate.**

	A	B	C	D	E	F	G	H	I	J	K	L	M
1													
2	6		5		4		3		2		1		
3													
4	7		8		9		10		11		12		
5													
6	18		17		16		15		14		13		
7													
8	19		20		21		22		23		24		
9													
10	30		29		28		27		26		25		
11													
12	31		32		33		34		35		36		
13													

- A. Description of original monument and accessories and/or subsequent restoration:  
 K-11 Post Set - 1845 by D. Houghton.  
 Hemlock, 15" N52°E, 31 LKS  
 Sugar, 10" S46°W, 48 LKS

No original evidence found.

- B. Description of corner evidence found and/or method applied in restoring or reestablishing corner:  
 K-11 Found 1 1/2" I.D. Pipe 1' above ground, accepted corner as found.

- C. Description of monument for corner and accessories established to perpetuate locating the position of the corner:  
 K-11 Set 2" Brass remon cap on top of found pipe. Witness set with 60d nail, brass "UPEA" tags, chest blaze.  
 Sugar Maple, 12", SCR. NBT, N42°W, 14.24'  
 Sugar Maple, 10", SCR. NBT, N38°E, 24.35'  
 Sugar Maple, 11", SCR. NBT, S57°E, 27.35'  
 Sugar Maple, 10", SCR. NBT, S55°W, 16.31'

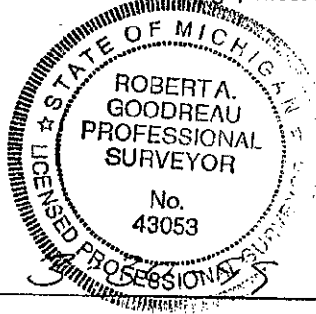

Signed by [Signature]  
 Surveyor's Michigan License No. 43053

Date \_\_\_\_\_