

**SURVEY &
REMONUMENTATION**

MAR 19 1997

COMMISSION

1996

REMONUMENTATION

Re-Now Likewl, Page 42

LAND CORNER RECORDATION CERTIFICATE
Filing Requirement of Act 74, Mich. P.A. 1970

For corners in Sheridan Township,

<u>Huron County</u> (County)	Located In:	Corner Code #
1. Public Land Survey	T <u>15</u> N R <u>12</u> E	B-13
	T ___ R ___	_____
	T ___ R ___	_____
	T ___ R ___	_____
2. Property Controlling in Section	S ___ T ___ R ___	_____
	S ___ T ___ R ___	_____
3. Miscellaneous Property in Sec.	S ___ T ___ R ___	_____
	S ___ T ___ R ___	_____

STATE OF MICHIGAN
HURON COUNTY
RECORDED
7 NOV 96 4:06 P.M.
FRANCES L. HOLDNICK
REGISTER OF DEEDS
Register of Deeds Stamp & File Number

4. Lot No. _____, Recorded Plat _____
5. Private Claims _____

I, Russell L. Brown, in a field survey on Oct. 18, 1996 do hereby state that under requirements of P.A. 74, Michigan P.A. of 1970, the corner points mentioned in lines 1 and 2 above were in conformance with regulations and rules therefore as required in the current manual of survey instructions of the United States Department of the Interior, Bureau of Land Management or by a decree of a Court of Law and/or that the corner points mentioned in lines 3, 4 and 5 above were in conformance with the rules of the Michigan Board of Land Surveyors or by a Decree of a Court of Law; established, re-established, monumented, recovered, found as expressed below:

1	A	B	C	D	E	F	G	H	I	J	K	L	M
2		6		5		4		3		2		1	
3													
4		7		8		9		10		11		12	
5													
6		18		17		16		15		14		13	
7													
8		19		20		21		22		23		24	
9													
10		30		29		28		27		26		25	
11													
12		31		32		33		34		35		36	
13													

NOTE: Not more than 2 corners, all in the same town and range, may be recorded on this certificate.

A. Description of original monument and accessories and/or subsequent restoration:

1834 G.L.O., H. Parke D.S.
Set quarter Section Post
Beech 14", N56 1/2E 24 Links
Hemlock 9", N49 1/2W 19 Links

County Road Commission Records:
Iron Pin in line with fence 33' from post
North and fence South.

County Surveyor Records:
NONE

B. Description of corner evidence found and/or method applied in restoring or reestablishing corner:

Found no evidence of original corner position.

Re-established corner position by proportionate measure from G.L.O. Notes, between C-13 and A-13 as best evidence of original corner position for B-13. Corner falls 7' South Centerline gravel road East and West and 3'± West of centerline fencerow North. 3"± below surface.

C. Description of monument for corner and accessories established to perpetuate locating the position of the corner:

South 1/4 Corner Section 31, T15N-R12E B-13
Set 1/2" x 18" Steel Stake, capped R.L.S. 24588

WITNESSES:
S45°E 21.92' to 1/2" x 18" Steel Stake capped 24588
S45°W 24.42' to 1/2" x 18" Steel Stake capped 24588
North 59.61' to Spike in West Side 12" Elm Tree
N30°E 45.19' to P.K. Nail in Southeast Side Power Pole

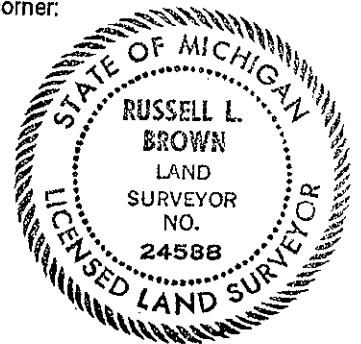

Signed by Russell L. Brown

Date 11-05-96

Surveyor's Michigan License No. 24588

PEER GROUP APPROVED
AT MEETING 11-05-96

[Handwritten signatures]