

SURVEY & REMONUMENTATION

MAR 19 1997

1996

See Map Liber 1, Page 44

REMONUMENTATION

COMMISSION

LAND CORNER RECORDATION CERTIFICATE
Filing Requirement of Act 74, Mich. P.A. 1970

For corners in Sheridan Township

Huron County (County)	Located In:	Corner Code #
1. Public Land Survey	T <u>15</u> N R <u>12</u> E	<u>D-13</u>
	T <u> </u> R <u> </u>	<u> </u>
	T <u> </u> R <u> </u>	<u> </u>
	T <u> </u> R <u> </u>	<u> </u>
2. Property Controlling in Section	S <u> </u> T <u> </u> R <u> </u>	<u> </u>
	S <u> </u> T <u> </u> R <u> </u>	<u> </u>
3. Miscellaneous Property in Sec.	S <u> </u> T <u> </u> R <u> </u>	<u> </u>
	S <u> </u> T <u> </u> R <u> </u>	<u> </u>

STATE OF MICHIGAN
HURON COUNTY
RECORDED
7 NOV 96 4:06 P.M.
FRANCES L. HOLDWICK
REGISTER OF DEEDS
Register of Deeds Stamp & File Number

4. Lot No. _____, Recorded Plat _____
5. Private Claims _____

I, Russell L. Brown, in a field survey on Oct. 18, 1996 do hereby state that under requirements of P.A. 74, Michigan P.A. of 1970, the corner points mentioned in lines 1 and 2 above were in conformance with regulations and rules therefore as required in the current manual of survey instructions of the United States Department of the Interior, Bureau of Land Management or by a decree of a Court of Law and /or that the corner points mentioned in lines 3, 4 and 5 above were in conformance with the rules of the Michigan Board of Land Surveyors or by a Decree of a Court of Law, established, re-established, monumented, recovered, found as expressed below.

NOTE: Not more than 2 corners, all in the same town and range, may be recorded on this certificate.

	A	B	C	D	E	F	G	H	I	J	K	L	M
1													
2		6		5		4		3		2		1	
3													
4		7		8		9		10		11		12	
5													
6		10		17		16		15		14		13	
7													
8		19		20		21		22		23		24	
9													
10		30		29		28		27		26		25	
11													
12		31		32		33		34		35		36	
13													

A. Description of original monument and accessories and/or subsequent restoration:

1834 G.L.O., H. Parke D.S.
Set quarter Section Post
Beech 10", N35E 28 Links
Lynn 10", N75 1/2W 25 Links

County Road Commission Records:
32 South Iron Pin
Pin Due North 33.0' in North Fenceline

County Surveyor Records:
NONE

Act 74 L.C.R.C.
NONE

(OVER)

B. Description of corner evidence found and/or method applied in restoring or reestablishing corner:

Found 3/4" Pipe over 3/4" Steel Pin in Cedar Post, centerline gravel road East and West, field division line North, 4"± below surface.
capped 3/4" Pipe R.L.S. 24588.

Accepted: 3/4" Pipe as the best evidence of the original corner position for corner D-13.

C. Description of monument for corner and accessories established to perpetuate locating the position of the corner:

South 1/4 Corner Section 32, T15N-R12E D-13
Found 3/4" Pipe over 3/4" Steel Pin in Cedar Post

- WITNESSES:
- N45°W 30.83' to 1/2" x 18" Steel Stake capped RLS 24588
 - N45°E 33.02' to 1/2" x 18" Steel Stake Capped RLS 24588
 - S45°E 31.04' to 1/2" x 18" Steel Stake capped RLS 24588
 - S45°W 28.36' to 1/2" x 18" Steel Stake capped RLS 24588

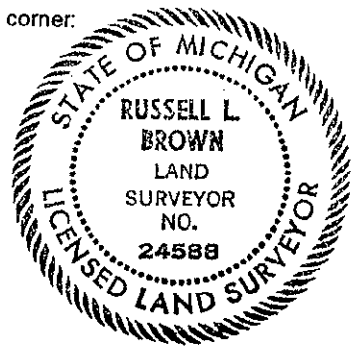

Signed by Russell L. Brown

Date 11-05-96

Surveyor's Michigan License No. 24588

PEER GROUP APPROVED
AT MEETING 11-05-96

Liber 1, Page 44A

August 23, 1978 survey in Liber 3 of surveys on Page 427 of Huron County Records.

3/4" Steel Pin in Cedar Post

1/2" Steel Pin, North 33.50'

1/2" Steel Pin, South 31.15'

1/2" Steel Pin, S45°W 41.50'

No unrecorded surveys found.