

**SURVEY & REMONUMENTATION**

MAR 19 1997

COMMISSION

1996

REMONUMENTATION

*Re Mon L.L.W. 1, Page 45*

**LAND CORNER RECORDATION CERTIFICATE**  
Filing Requirement of Act 74, Mich. P.A. 1970

For corners in Sheridan Township,

<u>Huron County</u> (County)	Located In:	Corner Code #
1. Public Land Survey	T15N R12E	E-13
	T___ R___	_____
	T___ R___	_____
	T___ R___	_____
2. Property Controlling in Section	S___ T___ R___	_____
	S___ T___ R___	_____
3. Miscellaneous Property in Sec.	S___ T___ R___	_____
	S___ T___ R___	_____

STATE OF MICHIGAN  
HURON COUNTY  
RECORDED  
7 NOV 96 4:06 P.M.  
FRANCES L. HOLLOWICK  
REGISTER OF DEEDS  
Register of Deeds Stamp & File Number

4. Lot No. \_\_\_\_\_, Recorded Plat \_\_\_\_\_  
5. Private Claims \_\_\_\_\_

I, Russell L. Brown, in a field survey on Oct. 16, 1996 do hereby state that under requirements of P.A. 74, Michigan P.A. of 1970, the corner points mentioned in lines 1 and 2 above were in conformance with regulations and rules therefore as required in the current manual of survey instructions of the United States Department of the Interior, Bureau of Land Management or by a decree of a Court of Law and/or that the corner points mentioned in lines 3, 4 and 5 above were in conformance with the rules of the Michigan Board of Land Surveyors or by a Decree of a Court of Law; established, re-established, monumented, recovered, found as expressed below:

	A	B	C	D	E	F	G	H	I	J	K	L	M
1													
2		6		5		4		3		2		1	
3													
4		7		8		9		10		11		12	
5													
6		18		17		16		15		14		13	
7													
8		19		20		21		22		23		24	
9													
10		30		29		28		27		26		25	
11													
12		31		32		33		34		35		36	
13													

NOTE: Not more than 2 corners, all in the same town and range, may be recorded on this certificate.

A. Description of original monument and accessories and/or subsequent restoration:

1834 G.L.O., H. Parke D.S.  
Set Post Corner Sections 32 and 33  
Cedar 24", N86E 39 Links  
B. Ash 20", N40W 1 1/2 Links

County Road Commission Records:  
Iron Pin Section 33 Southwest  
Spike Corner Post, N45°E 44.85'  
Iron TP, S60°E 62.75'

County Surveyor Records:

NONE

Act 74 L.C.R.C.

NONE

(OVER)

Recorded Surveys -NONE

B. Description of corner evidence found and/or method applied in restoring or reestablishing corner:

Found 1/2" Steel Stake over 3/4" Steel Stake, capped 1/2" RLS 24588.  
Found 1/2" centerline gravel roads East, West and North, 2"+ below surface.

Accepted: Found 1/2" Steel Stake over 3/4" Steel Stake as the best evidence of the original corner position for corner E-13.

C. Description of monument for corner and accessories established to perpetuate locating the position of the corner:

Corner Sections 32 and 33, T15N-R12E E-13  
Found 1/2" Steel Stake over 3/4" Steel Stake

WITNESSES:

South 43.50' Found Nail in West Side 16" Ash Tree  
N50°E 50.60' Found Nail in South Side 12" Ash Stump  
N45°E 55.16' to Spike in Southeast Corner 6" x 6" Wood Post  
S55°E 92.82' to Spike in Northeast Side 12" Maple Tree  
S55°W 70.94' to Spike in Southeast Side 9" Maple Tree  
West 120.73' to 1/2" Steel Stake centerline Hoadley Road

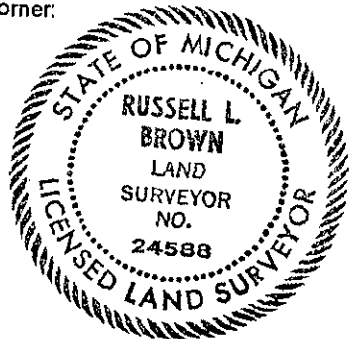

Signed by Russell L. Brown

Date 11-05-96

Surveyor's Michigan License No. 24588

PEER GROUP APPROVED

AT MEETING 11-05-96

*Sheet 1, Page 45A*

October 23, 1984 Survey by Huron Surveying (Project No: 84-611).  
3/4" Re-Rod

South 44.61' to Nail in West Side 12" Ash Tree

S50°E 42.0' to Nail in North Side 18" Maple Tree

N45°E 50.60' to Nail in South Side 10" Ash Tree