

*Common to A01 -- Bingham Twp. - T15N-R13E

*Common to A13 -- Verona Twp. - T16N-R13E

*Common to M13 -- Colfax Twp. - T16N-R12E

Re-Mon. Liber 1, Page 84
1997 REMONUMENTATION

LAND CORNER RECORDATION CERTIFICATE
Filing Requirement of Act 74, Mich. P.A. 1970

For corners in SHERIDAN TOWNSHIP

<u>HURON</u> (County)	Located In:	Corner Code #
1. Public Land Survey	T <u>15</u> N R <u>12</u> E	<u>M-1</u>
	T <u> </u> R <u> </u>	<u> </u>
	T <u> </u> R <u> </u>	<u> </u>
	T <u> </u> R <u> </u>	<u> </u>
2. Property Controlling in Section	S <u> </u> T <u> </u> R <u> </u>	<u> </u>
	S <u> </u> T <u> </u> R <u> </u>	<u> </u>
3. Miscellaneous Property in Sec.	S <u> </u> T <u> </u> R <u> </u>	<u> </u>
	S <u> </u> T <u> </u> R <u> </u>	<u> </u>

SURVEY & REMONUMENTATION

JAN 22 1998

STATE OF MICHIGAN
HURON COUNTY
RECORDED

1 DEC 97 1:47 P.M.

FRANCES L. HOLDWICK
REGISTER OF DEEDS

SECTION Register of Deeds Stamp & File Number

4. Lot No. _____, Recorded Plat _____
5. Private Claims _____

I, Russell L. Brown, in a field survey on Oct. 15 19 97 do hereby state that under requirements of P.A. 74, Michigan P.A. of 1970, the corner points mentioned in lines 1 and 2 above were in conformance with regulations and rules therefore as required in the current manual of survey instructions of the United States Department of the Interior, Bureau of Land Management or by a decree of a Court of Law and/or that the corner points mentioned in lines 3, 4 and 5 above were in conformance with the rules of the Michigan Board of Land Surveyors or by a Decree of a Court of Law; established, re-established, monumented, recovered, found as expressed below:

NOTE: Not more than 2 corners, all in the same town and range, may be recorded on this certificate.

1	A	B	C	D	E	F	G	H	I	J	K	L	M
2		6		5		4		3		2		1	
3													
4		7		8		9		10		11		12	
5													
6		16		17		16		15		14		13	
7													
8		19		20		21		22		23		24	
9													
10		30		29		28		27		26		25	
11													
12		31		32		33		34		35		36	
13													

A. Description of original monument and accessories and/or subsequent restoration:
1834 G.L.O. H. Parke D.S. West on South side Section 31, T16N-R13E, 78.01 intersected Range Line 43 South of temporary Town Corner. Hemlock 12 N91 1/2 W 8, B. Ash 16 S2W 33
1895 COUNTY SURVEYORS RECORDS: Duncan McFadden County Surveyor, Post from witnesses no witnesses given.
Act 74 FORM: None
COUNTY ROAD COMMISSION RECORDS: Iron Pin, Spike Power Pole, S45°E 69.40'
RECORDED SURVEYS: (OVER)

B. Description of corner evidence found and/or method applied in restoring or reestablishing corner:
No evidence of original corner or accessories found.
Found 3/4" Re-rod in Monument Box
Accepted 3/4" Re-rod as the best evidence of original corner position.

C. Description of monument for corner and accessories established to perpetuate locating the position of the corner:
N.E. Corner Section 1, T15N-R12E, M-1
Found 3/4" Re-rod in Monument Box
WITNESSES:
S45°E 69.38' to Spike in East Side Power Pole
N45°E 53.12' to Right of Way Marker
S50°W 44.84' to Chiseled "+" on West End C.M.P.
N60°W 51.75' to 1/2" x 18" Steel Stake
East 2517.93' to South 1/4 Corner Section 31, T16N-R13E
This corner is common with M-13, T16N-R12E, A-1, T15N-R13E, and A-13, T16N-R13E

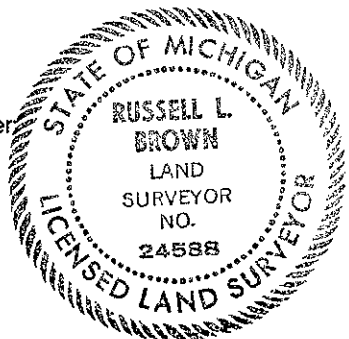

Signed by Russell L. Brown
Surveyor's Michigan License No. 24588

Date Nov. 3, 1997

PEER GROUP APPROVED
AT MEETING HELD
NOV 25, 1997. RCB

Liber 1, Page 84 A

A. CONTINUED

Survey recorded in Liber 3 of Surveys on Page 96 of Huron County Records.
Monument Box in place

WITNESSES:

Nail on West side of Power Pole, S40°E 69.15'

Nail on North side of Telephone Pole, S60°W 50.65'

Nail on South Side of Telephone Pole, N40°W 49.30'

\$ 9.00 SURVEY
\$ 2.00 MSSR