

- *Common to A13 - Verona Twp. - T16N-R13E
- *Common to M13 - Colfax Twp. - T16N-R12E
- *Common to M01 - Sheridan Twp. - T15N-R12E

Re-Monumentation, Page 85
 1997 REMONUMENTATION

LAND CORNER RECORDATION CERTIFICATE
 Filing Requirement of Act 74, Mich. P.A. 1970

For corners in BINGHAM TOWNSHIP

| | | |
|------------------------------------|---------------------------|---------------|
| <u>HURON</u> (County) | Located in: | Corner Code # |
| 1. Public Land Survey | T <u>15N</u> R <u>13E</u> | <u>A-1</u> ✓ |
| | T <u>16N</u> R <u>13E</u> | <u>A-13</u> |
| | T <u>15N</u> R <u>12E</u> | <u>M-1</u> |
| | T <u>16N</u> R <u>12E</u> | <u>M-13</u> |
| 2. Property Controlling in Section | S ___ T ___ R ___ | ___ |
| | S ___ T ___ R ___ | ___ |
| 3. Miscellaneous Property in Sec. | S ___ T ___ R ___ | ___ |
| | S ___ T ___ R ___ | ___ |

SURVEY &
 REMONUMENTATION

JAN 22 1998

SECTION

STATE OF MICHIGAN
 HURON COUNTY
 RECORDED

1 DEC 97 1:47 P.M.

FRANCES L. HOLDWICK
 REGISTER OF DEEDS

Register of Deeds Stamp & File Number

4. Lot No. _____, Recorded Plat _____
 5. Private Claims _____

I, Russell L. Brown, in a field survey on Oct. 15, 19 97 do hereby state that under requirements of P.A. 74, Michigan P.A. of 1970, the corner points mentioned in lines 1 and 2 above were in conformance with regulations and rules therefore as required in the current manual of survey instructions of the United States Department of the Interior, Bureau of Land Management or by a decree of a Court of Law and /or that the corner points mentioned in lines 3, 4 and 5 above were in conformance with the rules of the Michigan Board of Land Surveyors or by a Decree of a Court of Law; established, re-established, monumented, recovered, found as expressed below:

NOTE: Not more than 2 corners, all in the same town and range, may be recorded on this certificate.

| | | | | | | | | | | | | | |
|----|----|---|----|---|----|---|----|---|----|---|----|---|---|
| 1 | A | B | C | D | E | F | G | H | I | J | K | L | M |
| 2 | 6 | | 5 | | 4 | | 3 | | 2 | | 1 | | |
| 3 | | | | | | | | | | | | | |
| 4 | 7 | | 8 | | 9 | | 10 | | 11 | | 12 | | |
| 5 | | | | | | | | | | | | | |
| 6 | 10 | | 17 | | 16 | | 15 | | 14 | | 13 | | |
| 7 | | | | | | | | | | | | | |
| 8 | 19 | | 20 | | 21 | | 22 | | 23 | | 24 | | |
| 9 | | | | | | | | | | | | | |
| 10 | 30 | | 29 | | 28 | | 27 | | 26 | | 25 | | |
| 11 | | | | | | | | | | | | | |
| 12 | 31 | | 32 | | 33 | | 34 | | 35 | | 36 | | |
| 13 | | | | | | | | | | | | | |

A. Description of original monument and accessories and/or subsequent restoration:
 1834 G.L.O. H. Parke D.S. West on South side Section 31, T16N-R13E, 78.01 intersected Range Line 43 South of temporary Town Corner. Hemlock 12 N9 1/2W 8, B. Ash 16 S2W 33
 1895 COUNTY SURVEYORS RECORDS: Duncan McFadden County Surveyor; Post from witnesses, no witnesses given.
 ACT 74 FORM: None
 COUNTY ROAD COMMISSION RECORDS: Iron Pin, Spike Power Pole, S45°E 69.40'
 RECORDED SURVEYS: (OVER)

B. Description of corner evidence found and/or method applied in restoring or reestablishing corner:
 No evidence of original corner or accessories found.
 Found 3/4" Re-rod in Monument Box
 Accepted 3/4" Re-rod as the best evidence of original corner position.

C. Description of monument for corner and accessories established to perpetuate locating the position of the corner:
 N.W. Corner Section 6, T15N-R13E, A-1
 Found 3/4" Re-rod in Monument Box
 WITNESSES:
 S45°E 69.38' to Spike in East Side Power Pole
 N45°E 53.12' to Right of Way Marker
 S50°W 44.84' to Chiseled "+" on West End C.M.P.
 N60°W 51.75' to 1/2" x 18" Steel Stake
 East 2517.93' to South 1/4 Corner Section 31, T16N-R13E
 This Corner is common with M-13, T16N-R12E, M-1, T15N-R12E, and A-13, T16N-R13E

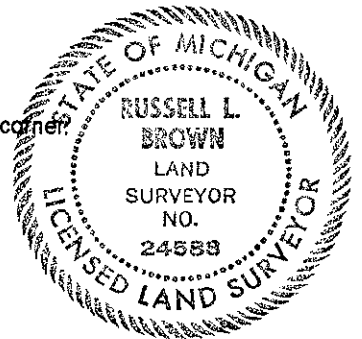

Signed by Russell L. Brown
 Surveyor's Michigan License No. 24588

Date Nov. 3, 1997

PEER GROUP APPROVED
 AT MEETING HELD
Nov 25, 1997. RLB

Liber 1, Page 85A

A. CONTINUED

Survey recorded in Liber 3 of Surveys on Page 96 of Huron County Records.
Monument Box in Place

WITNESSES:

Nail on West side Power Pole, S40°E 69.15'

Nail on North Side Telephone Pole, S60°W 50.65'

Nail on South Side Telephone Pole, N40°W 49.30'

\$ 9.00 SURVEY

\$ 2.00 MSSR