

*Common to A01 - Sherman Twp. T15N-R15E
 *Common to A13 - Sand Beach Twp. - T16N-R15E
 *Common to M13 - Sigel Twp. - T16N-R14E

SURVEY & REMONUMENTATION

JAN 22 1998

**1997 REMONUMENTATION
 LAND CORNER RECORDATION CERTIFICATE
 Filing Requirement of Act 74, Mich. P.A. 1970**

Re-Monument 1, Page 79

For corners in

SECTION (County)	Located In:	Corner Code #
1. Public Land Survey	Paris	T15N R14E T16N R14E T15N R15E T16N R15E
2. Property Controlling in Section	S ___ T ___ R ___	M-1 ✓ M-13 A-1 A-13
3. Miscellaneous Property in Sec.	S ___ T ___ R ___	_____

STATE OF MICHIGAN
 HURON COUNTY
 RECORDED

26 NOV 97 8:58 A.M.

FRANCES L. HOLDWICK
 REGISTER OF DEEDS

Register of Deeds Stamp & File Number

4. Lot No. _____, Recorded Plat _____
 5. Private Claims _____

I, Charles S. Getz, in a field survey on Aug. 17, 1997 do hereby state that under requirements of P.A. 74, Michigan P.A. of 1970, the corner points mentioned in lines 1 and 2 above were in conformance with regulations and rules therefore as required in the current manual of survey instructions of the United States Department of the Interior, Bureau of Land Management or by a decree of a Court of Law and /or that the corner points mentioned in lines 3, 4 and 5 above were in conformance with the rules of the Michigan Board of Land Surveyors or by a Decree of a Court of Law; established, re-established, monumented, recovered, found as expressed below:

NOTE: Not more than 2 corners, all in the same town and range, may be recorded on this certificate.

	A	B	C	D	E	F	G	H	I	J	K	L	M
1													
2	6		5		4		3		2		1		
3													
4	7		8		9		10		11		12		
5													
6	18		17		16		15		14		13		
7													
8	19		20		21		22		23		24		
9													
10	30		29		28		27		26		25		
11													
12	31		32		33		34		35		36		
13													

A. Description of original monument and accessories and/or subsequent restoration:

M-1	1834 G.L.O., H. Parke D.S.	Co. Surveyor Records - NONE
Post	Pine 18", S84°W, 8 Links	Co. Rd. Comm. Records - Iron Rod
B.Ash 16", N81½°E, 21 Links		Recorded Surveys - NONE
		Huron Surveying 10-25-76 - 3/4" Pin
		L.C.R.C. 1994 Remonumentation - Monument Box

B. Description of corner evidence found and/or method applied in restoring or reestablishing corner:

M-1
 NE Cor, Section 1, T15N-R14E
 Found 3/4" Re-Rod in Monument Box
 Accepted as the best available evidence of original corner position
 (Intersection of Helena & Finkel Roads)

C. Description of monument for corner and accessories established to perpetuate locating the position of the corner:

M-1
 NE Cor, Section 1, T15N-R14E
 Found 3/4" Re-Rod in Monument Box
 N45°W 71.35' to Spike in Power Pole
 S45°W 66.66' to Spike in Power Pole
 S45°E 64.50' to Spike in Tele Box Post
 N30°E 89.22' to PK Nail in W. side of Power Pole
 South 2693.94' to W 1/4 Cor, Sec 6, T15N-R15E
 East 2479.79' to S 1/4 Cor, Sec 31, T16N-R15E

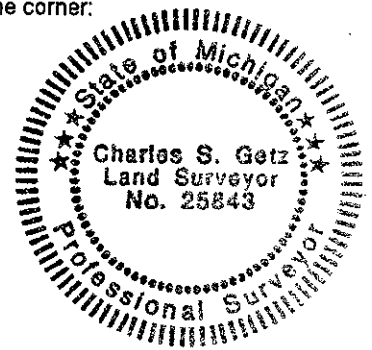

Signed by Charles S. Getz
 Surveyor's Michigan License No. 25843

Date November 20, 1997

PEER GROUP APPROVED AT
 MEETING Nov. 25, 1997 RLB.