

*Common to A01 - Sherman Twp. - T15N-R16E
 *Common to A13 - Sand Beach Twp. - T16N-R16E
 *Common to M13 - Sand Beach Twp. - T16N-R15E

SURVEY & REMONUMENTATION

1997 REMONUMENTATION

Re: Mon Liber 1, Page 80

JAN 22 1998

LAND CORNER RECORDATION CERTIFICATE
 Filing Requirement of Act 74, Mich. P.A. 1970

For corners in

SECTION (County)	Located In:	Corner Code #
1. Public Land Survey Sherman	T15N R15E T16N R15E T15N R16E T16N R16E	M-1 ✓ M-13 A-1 A-13
2. Property Controlling in Section	S ___ T ___ R ___ S ___ T ___ R ___	___ ___
3. Miscellaneous Property in Sec.	S ___ T ___ R ___ S ___ T ___ R ___	___ ___

STATE OF MICHIGAN
 HURON COUNTY
 RECORDED

26 NOV 97 8:58 A.M.

FRANCES L. HOLDWICK
 REGISTER OF DEEDS

Register of Deeds Stamp & File Number

4. Lot No. _____, Recorded Plat _____
 5. Private Claims _____

I, Charles S. Getz, in a field survey on Aug. 17, 1997 do hereby state that under requirements of P.A. 74, Michigan P.A. of 1970, the corner points mentioned in lines 1 and 2 above were in conformance with regulations and rules therefore as required in the current manual of survey instructions of the United States Department of the Interior, Bureau of Land Management or by a decree of a Court of Law and/or that the corner points mentioned in lines 3, 4 and 5 above were in conformance with the rules of the Michigan Board of Land Surveyors or by a Decree of a Court of Law; established, re-established, monumented, recovered, found as expressed below:

NOTE: Not more than 2 corners, all in the same town and range, may be recorded on this certificate.

	A	B	C	D	E	F	G	H	I	J	K	L	M
1													
2	6		5		4		3		2		1		
3													
4	7		8		9		10		11		12		
5													
6	18		17		16		15		14		13		
7													
8	19		20		21		22		23		24		
9													
10	30		29		28		27		26		25		
11													
12	31		32		33		34		35		36		
13													

A. Description of original monument and accessories and/or subsequent restoration:

M-1 1834 G.L.O., H. Parke D.S. Post Hemlock 14", S28°W, 30 Links Do. 8", N31°E, 8 Links	Co. Surveyor Records - NONE Co. Rd. Comm. Records - Iron Pin Unrecorded Surveys - NONE Survey Liber 3, Page 425 - 3/4" Re-Rod in Monument Box L.C.R.C. - NONE
---	---

B. Description of corner evidence found and/or method applied in restoring or reestablishing corner:

M-1
 NE Cor, Section 1, T15N-R15E
 Found 3/4" Re-Rod in Monument Box
 Accepted as the best available evidence of original corner position
 (Intersection of Helena & Edwards Roads)

C. Description of monument for corner and accessories established to perpetuate locating the position of the corner:

M-1
 NE Cor, Section 1, T15N-R15E
 Found 3/4" Re-Rod in Monument Box
 N45°E 74.88' to Nail in SE Side of Power Pole
 S45°E 57.81' to Nail in NE Side of Cable Post
 N40°W 51.53' to S. Point of Conc. Project Marker
 West 2625.24' to S 1/4 Cor, Sec 36, T16N-R15E
 East 2623.54' to S 1/4 Cor, Sec 31, T16N-R16E

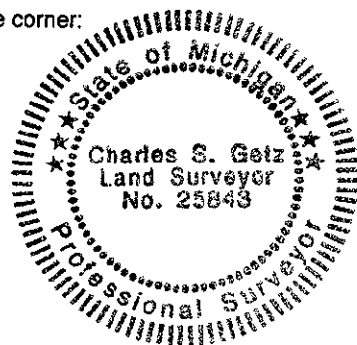

Signed by Charles S. Getz
 Surveyor's Michigan License No. 25843

Date November 20, 1997

PEER GROUP APPROVED AT
 MEETING Nov. 25, 1997 RLB