

\*Common to A13 - Sand Beach Twp. - T16N-R16E,  
 \*Common to M01 - Sherman Twp. - T15N-R15E  
 \*Common to M13 - Sand Beach Twp. - T16N-R15E

**SURVEY & REMONUMENTATION**

1997 REMONUMENTATION

*Re - Now Liber 1, Page 81*

**LAND CORNER RECORDATION CERTIFICATE**  
 Filing Requirement of Act 74, Mich. P.A. 1970

JAN 22 1998

For corners in

Huron	SECTION	Located In:	Corner Code #
(County)			
1. Public Land Survey	Sherman	T15NR16E <del>T16NR16E</del> T15NR15E <del>T16NR15E</del>	<u>A-1</u> ✓ <del>A-13</del> <del>M-1</del> <del>M-13</del>
2. Property Controlling in Section	S	T	R
3. Miscellaneous Property in Sec.	S	T	R

STATE OF MICHIGAN  
 HURON COUNTY  
 RECORDED  
 26 NOV 97 8:58 A.M.  
 FRANCES L. HOLDWICK  
 Register of Deeds Stamp & File Number

4. Lot No. \_\_\_\_\_, Recorded Plat \_\_\_\_\_  
 5. Private Claims \_\_\_\_\_

I, Charles S. Getz, in a field survey on Aug. 17, 1997 do hereby state that under requirements of P.A. 74, Michigan P.A. of 1970, the corner points mentioned in lines 1 and 2 above were in conformance with regulations and rules therefore as required in the current manual of survey instructions of the United States Department of the Interior, Bureau of Land Management or by a decree of a Court of Law and /or that the corner points mentioned in lines 3, 4 and 5 above were in conformance with the rules of the Michigan Board of Land Surveyors or by a Decree of a Court of Law; established, re-established, monumented, recovered, found as expressed below:

NOTE: Not more than 2 corners, all in the same town and range, may be recorded on this certificate.

A	B	C	D	E	F	G	H	I	J	K	L	M
1												
2	6	5	4	3	2	1						
3												
4	7	8	9	10	11	12						
5												
6	18	17	16	15	14	13						
7												
8	19	20	21	22	23	24						
9												
10	30	29	28	27	26	25						
11												
12	31	32	33	34	35	36						
13												

A. Description of original monument and accessories and/or subsequent restoration:

A-1	1834 G.L.O., H. Parke D.S.	Co. Surveyor Records - NONE
Post	Hemlock 14", S28°W, 30 Links	Co. Rd. Comm. Records - Iron Pin
Do.	8", N31°E, 8 Links	Survey Liber 3, Page 425 - 3/4" Re-Rod in Monument Box
		Unrecorded Surveys - NONE
		L.C.R.C. - NONE

B. Description of corner evidence found and/or method applied in restoring or reestablishing corner:

A-1  
 NW Cor, Section 6, T15N-R16E  
 Found 3/4" Re-Rod in Monument Box  
 Accepted as the best available evidence of original corner position  
 (Intersection of Helena & Edwards Roads)

C. Description of monument for corner and accessories established to perpetuate locating the position of the corner:

A-1  
 NW Cor, Section 6, T15N-R16E  
 Found 3/4" Re-Rod in Monument Box  
 N45°E 74.88' to Nail in SE Side of Power Pole  
 S45°E 57.81' to Nail in NE Side of Cable Post  
 N40°W 51.53' to S. Point of Conc. Project Marker  
 West 2625.24' to S 1/4 Cor, Sec 36, T16N-R15E  
 East 2623.54' to S 1/4 Cor, Sec 31, T16N-R16E

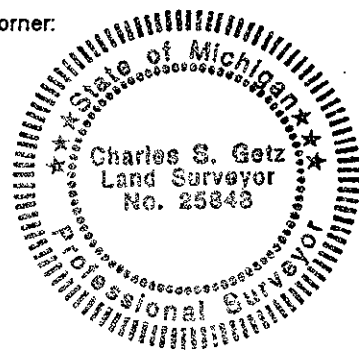

Signed by Charles S. Getz  
 Surveyor's Michigan License No. 25843

Date November 20, 1997

PEER GROUP APPROVED AT  
 MEETING Nov. 25, 1997 RUB